

FALL RIVER COUNTY UNAPPROVED MINUTES OF FEBRUARY 18, 2020

The Fall River Board of County Commissioners met in regular session on February 18, 2020. Present: Joe Allen, Joe Falkenburg, Heath Greenough, Paul Nabholz, Deb Russell and Sue Ganje, Auditor.

The Pledge of Allegiance was given, and the meeting called to order at 9:05 a.m.

The agenda was reviewed for conflicts; none were noted. ALL MOTIONS RECORDED IN THESE MINUTES WERE PASSED BY UNANIMOUS VOTE, UNLESS OTHERWISE STATED. The full context of the meeting can be found on the county website under Commissioners at <http://fallriver.sdcounties.org>, or, under Fall River County Commission, SD at <http://www.YouTube.com>.

Motion made by Greenough, seconded by Nabholz, to approve the agenda as written.

Motion made by Nabholz, seconded by Russell, to approve the minutes of February 4, 2020 with the following correction: Nabholz spoke in favor of (rather than voted for) the Lookout Solar Project in Oglala Lakota County.

Motion made by Russell, seconded by Nabholz, to approve CP 2020-01 in the amount of \$1,170.00.

Motion made by Russell, seconded by Allen, to approve hiring Katie Pierce, administrative assistant for 4H Youth/Extension, \$13.00 per hour, effective March 23, 2020, as per union contract, and allow up to 40 hours of training by current administrative assistant.

David Weishaupl, Assistant Building Supervisor, met to update the board on the odor at the south annex building. A 10-gallon propane water heater has been found for \$345.00 that will hopefully eliminate the issue. After discussion the board would like further research done.

Propane quotes were presented as follows:

| 2/11/2020 Propane Quotes | 10,000-Gal Propane |
|--------------------------|--------------------|
| McGas Propane | \$.799/gallon |
| PJ's Hi-D-Way | \$1.05/gallon |
| CBH Coop | No Bid |

Motion made by Nabholz, seconded by Greenough, to approve the low bid from McGas Propane, in the amount of \$.799 per gallon, for 10,000 gallons of propane, for a total amount of \$7,990.00.

Motion made by Allen, seconded by Greenough, to approve the quote from Golden West for 1 computer for State's Attorney, 3 computers for Director of Equalization, 3 computers for Auditor (previously approved), 3 computers for Register of Deeds, and 4 computers for Treasurer, in the amount of \$15,244.46, which also includes installation and configuration.

Susie Hayes, Director of Equalization, met with the board for travel approval. Motion made by Nabholz, seconded by Allen, to approve travel for Caitlin Turner, Certified Assessor, to attend the National USPAP Course, May 11 and May 12, 2020 in Pierre, for a total amount of \$465.00 (includes course and hotel costs).

Hayes presented annual abatements, by location. Hayes noted that those abatement requests within municipalities have already been approved. Motion made by Nabholz, seconded by Greenough, to approve all abatements for 2019 taxes, payable in 2020 (unless noted differently), as listed below:

Parcels in the City of Hot Springs:

City of Hot Springs, #75290-01700-001-00, pro-rated, \$203.41, re: from taxable to exempt;
City of Hot Springs, #75095-00806-100-30, pro-rated, \$62.82, re: from taxable to exempt;
Donald & Kathy Olstad, #75500-01900-007-00, pro-rated, \$118.78, re: from exempt to taxable;
Hult Homes, LLC, #75500-01900-006-00, pro-rated, \$65.14, re: from exempt to taxable;
Hult Homes, LLC, #75500-01900-005-10, \$65.14, pro-rated, re: from exempt to taxable;
Hult Homes, LLC, #75500-01900-005-00, \$65.14, pro-rated, re: from exempt to taxable;
Hult Homes, LLC, #75500-01900-004-00, \$103.41, pro-rated, re: from exempt to taxable;
Frank Rasmussen, #75542-00000-015-00, \$12.18, adjusted, re: MH destroyed in fire 11/2019;
Mark Vancas, #81900-00000-026-95, \$183.86, adjusted, re: MH destroyed in fire 02/2019;
Julie Miller, #75370-02600-045-00, \$64.65, adjusted, re: house destroyed in fire 11/2019;

Parcels in the City of Edgemont:

Robert and Elizabeth Johnson, #72100-01000-009-94, \$216.00, pro-rated; re: Elderly Freeze;

Parcels in the Town of Oelrichs:

Oelrichs VFD, #78100-03400-001-00, \$10.67, pro-rated, re: from taxable to exempt;
Oelrichs VFD, #78100-03400-002-00, \$10.67, pro-rated, re: from taxable to exempt;
Oelrichs VFD, #78100-03400-003-00, \$10.67, pro-rated, from taxable to exempt;

Parcels in the County:

Prairie View United Methodist, #21000-00806-151-50, \$1,083.31, pro-rated, re: from exempt to taxable;
Michael Duff, #20000-00805-084-30, \$65.08, pro-rated, re: garage destroyed in fire 08/2019;
Doris Stevens, #65220-01000-013-00, \$139.48, adjusted, re: Elderly Freeze;
Wade & Patricia Evans, #85000-02017-000-10, \$662.54, removed, re: tiny home moved to Colorado 10/ 2018;
Jullian & Barbara Zornes, 11000-00705-222-03, \$17.79, adjusted, re: camper, addition and shed burned in fire 10/2019;
Kent & Kris Hanson, #11000-00705-152-40, 2018 pay 2019, \$486.71, adjusted, re: should have been ag classification;
Kent & Kris Hanson, #11000-00705-152-40, \$478.66, adjusted, re: should have been ag classification.

Sue Ganje, Auditor, presented recommendations from Safety Benefits Inc, from the October 15, 2019 loss control survey.

Commissioner Nabholz updated the board on SB51 (conceal carry for county employees), which is now SB169. It will now include state employees that will be working in the courthouse. Clarification has also been given that employees will not carry in the courtroom or in any courthouse areas in use under supervision of the Unified Judicial System (UJS). The UJS will not oppose this bill. Further testimony will be given Thursday.

Motion made by Greenough, seconded by Russell, to approve the bills as follows:

GENERAL FUND

| | | |
|-----------------------------|---------------------------|-------------|
| AUDRA HILL CONSULTING, INC | MI QMHP EVALUATION | \$734.07 |
| CURA HOSPITALITY | INMATE MEALS | \$10,696.19 |
| A-Z SHREDDING INC | SHREDDING | \$61.90 |
| BOB BARKER COMPANY INC | SUPPLY | \$69.57 |
| BAUERKEMPERS INC | SERVICE | \$120.42 |
| BLACK HILLS CHEMICAL | SUPPLY | \$467.62 |
| CENTURY BUSINESS LEASING | COPIER LEASE & METER | \$170.21 |
| CHADRON MOTOR CO. INC | SERVICE | \$193.97 |
| CLINICAL LABORATORY | AUTOPSY | \$1,646.00 |
| ELECTION SYSTEMS & SOFTWARE | ELECTION EQUIPMENT | \$1,173.02 |
| EN-TECH LLC | FUMIGATION | \$410.00 |
| FARRELL, FARRELL & GINSBACH | CAAF | \$51.35 |
| FLINT ELECTRIC | SERVICE | \$473.62 |
| FALL RIVER COUNTY HERALD | PUBLICATION | \$569.51 |
| GOLDEN WEST TECHNOLOGIES | IT SUPPORT/CONTRACT | \$6,408.20 |
| HAGEN | SUPPLY | \$50.95 |
| HILLS EDGE AUTO SALES | MAINTENANCE | \$110.69 |
| HOBART SALES & SERVICE | REPAIR | \$715.10 |
| HOT SPRINGS ACE HARDWARE | SUPPLY | \$127.85 |
| JOHNSON, KIMBERLY K | COURT REPORTER | \$448.40 |
| KINKADE FUNERAL CHAPEL | COUNTY ASSISTANCE | \$1,170.00 |
| LYNN'S DAKOTAMART | INMATE SUPPLIES | \$11.97 |
| MARCO | COPIER LEASE | \$165.00 |
| MASSA DENTAL OFFICES PC | INMATE MEDICAL | \$58.00 |
| MCGLUMPHY, ERIN | TRAVEL REIMBURSEMENT | \$246.54 |
| NELSONS OIL & GAS INC. | PROPANE | \$272.80 |
| O'NEILL, JUSTIN | CAAF | \$357.75 |
| PENNINGTON COUNTY JAIL | INMATE HOUSING PENNINGTON | \$5,950.00 |
| PENN COUNTY SHERIFF | TAX DEED SERVED | \$50.86 |
| US POSTAL SERVICE | STAMPS | \$140.00 |
| PRAIRIE HILLS TRANSIT | 2020 BUDGET ALLOTMENT | \$13,000.00 |
| QUILL CORPORATION | SUPPLIES | \$861.46 |
| QUALIFIED PRESORT SERVICE | PROFESSIONAL SERVICE | \$2,911.34 |

| | | |
|------------------------------------|--|-------------|
| RUSHMORE COMMUNICATIONS | EMERGENCY RADIO REPAIR | \$3,199.43 |
| SD DEPARTMENT OF HEALTH | BLOOD DRAWS | \$905.00 |
| SD FEDERAL PROPERTY AG | TRUCK & SUPPLIES | \$4,400.00 |
| SD SECRETARY OF STATE | VOTER LIST | \$20.00 |
| SERVALL | RUGS AND MATS SERVICE | \$377.31 |
| SOFTWARE SERVICES INC | SOFTWARE SERVICES | \$2,080.00 |
| STEINLEY REAL ESTATE | 7-HOUR COURSE, ASSESSOR | \$420.00 |
| STEVEN'S AUTOMOTIVE | SERVICE | \$205.00 |
| ELECTRICAL ENGINEERING | SERVICE | \$525.00 |
| BASTIAN, TRACY | PILOT | \$100.00 |
| | TOTAL FOR GENERAL FUND | \$62,126.10 |
| COUNTY ROAD & BRIDGE | | |
| FALL RIVER COUNTY HERALD | PUBLICATION | \$100.44 |
| | TOTAL FOR COUNTY ROAD AND BRIDGE | \$100.44 |
| 911 SURCHARGE REIMBURSEMENT | | |
| CENTURY BUSINESS LEASING | COPIER LEASE & METER | \$85.10 |
| CENTURY LINK | 911 DISPATCH LINES | \$598.97 |
| | TOTAL FOR 911 SURCHARGE REIMBURSEMENT | \$684.07 |
| EMERGENCY MANAGEMENT | | |
| GOLDEN WEST TECHNOLOGIES | IT SUPPORT/CONTRACT | \$8.50 |
| MARCO | COPIER LEASE | \$38.90 |
| MCGAS PROPANE | UTILITY | \$304.98 |
| QUILL CORPORATION | SUPPLIES | \$28.45 |
| SD FEDERAL PROPERTY AG | TRUCK & SUPPLIES | \$96.00 |
| | TOTAL FOR EMERGENCY MANAGEMENT | \$476.83 |
| L.E.P.C. GRANT | | |
| PUDWILL, NORMAN | OBSERVER | \$60.00 |
| | TOTAL FOR L.E.P.C. GRANT | \$60.00 |
| | TOTAL PAID BETWEEN 02/05/20 AND 02/18/20 | \$63,447.40 |

Break was taken at 9:35 a.m. and the meeting reconvened at 9:40 a.m.

Public comment was heard from Sheriff Evans noting that there are 17 males and 4 females in the Fall River County jail, with 1 male and 2 females in the Pennington County Jail.

Greenough rejoined the meeting at 9:44 a.m.

Randy Seiler, Highway Superintendent, met with the board to present fuel transfers. Motion made by Greenough, seconded by Allen, to approve the January 2020 fuel used or work performed to reimburse the highway department as follows: Sheriff's Department for \$2,259.68; Weed and Pest Office for \$144.27; Building for \$75.51; Emergency Management for \$99.21; Director of Equalization for \$72.14; State's Attorney for \$17.03; GIS for \$19.60; and Veteran's Service Officer for \$10.18.

Motion made by Russell, seconded by Nabholz, to allow Seiler to purchase culverts off the January 7, 2020 Beadle County bids from True North Steele, Inc.

Motion made by Russell, seconded by Greenough, to approve the Golden West application for permit to occupy county highway right-of-way for John Staben from 13819 Sage Road (GPS 43.375129N-103.298138W) to 13807 Sage Road (GPS43.373742N-103.299090W(approx.)).

Seiler updated the board that Craig DeBoer will not be selling his building in Oral at this time but will let the board know if he changes his mind. Seiler will be meeting with FEMA later in the week, still working on the Ardmore Bridge portion. The board was also updated about the fact the 1993 Mack Truck needs repairs and Seiler is getting estimates to fix. Discussion was held on possibly updating the trucks for hauling gravel at some point. A truck inventory will be brought to the next meeting.

The hearing for the 2020 annual bids for aggregate base, chips, fines and sand was held as advertised. Two bids were presented and opened as follows:

KD Contractors:

FOB Shep's Canyon Quarry or Cottonwood Quarry
Aggregate Base Course 3/4" base \$ 7.75/ton
Chips 3/8" \$11.50/ton
Fines \$11.50/ton
Class A through C rip rap: \$20.00/ton
Class D through Class J rip rap: \$35.00/ton

Simon Materials:

| | | | |
|-----------------------|-------------|------------|--------------|
| Aggregate Base Course | \$ 6.95/ton | 42,000 ton | \$291,900.00 |
| Chips, 3/8" crushed | \$16.00/ton | 100 ton | \$1,600.00 |
| Fines, air separated | \$ 9.75/ton | 100 ton | \$975.00 |
| Fines, washed | \$18.50/ton | 100 ton | \$1,875.00 |
| Sand, concrete | \$20.00/ton | 100 ton | \$2,000.00 |

Motion made by Allen, seconded by Russell, per the Superintendent's recommendation, to accept all bids and allow the Highway Department to utilize what is most advantageous at the time the product is needed. With Greenough and Nabholz voting no, all others voting yes, by roll call vote, motion carries.

The 2020 Private Road work hearing was held as advertised. Motion made by Allen, seconded by Nabholz, to continue emergency private road work as per SDCL 31-11-41 through 31-11-45.

Motion made by Greenough, seconded by Allen, to adjourn at 10:22 a.m.

/s/Joe Falkenburg
Joe Falkenburg, Chairman

Board of Fall River County Commissioners

ATTEST:

/s/ Sue Ganje

Sue Ganje, Fall River County Auditor

CERTIFICATE OF REAL ESTATE VALUE [SDCL 7-9-7(4)]

COURTHOUSE USE ONLY

STATE OF SOUTH DAKOTA, COUNTY OF Fall River

Book _____ Page _____

Ratio Card No _____

Seller(s) FALL RIVER COUNTY (605) 745-5130
Name _____ Phone No. _____

Mailing Address: 906 N RIVER STREET HOT SPRINGS SD 57747
Street/Box No _____ City _____ State _____ Zip Code _____

Buyer(s): OELRICHS HISTORICAL SOCEITY (605) 890-2462
Name _____ Phone No. _____

Mailing Address: PO BOX 127 OELRICHS SD 57763
Street/Box No _____ City _____ State _____ Zip Code _____

NEW Address: _____
Street/Box No _____ City _____ State _____ Zip Code _____

| | | |
|--|--|--|
| OWNER-OCCUPIED - THIS BOX TO BE COMPLETED BY BUYER ONLY | | These items are important to complete for property to continue to be classified as owner occupied for a lower property tax rate. (If yes - state location _____) |
| Property is currently classified as owner-occupied | YES <input type="checkbox"/> NO <input type="checkbox"/> | |
| Property will be occupied by buyer on _____ (date) | YES <input type="checkbox"/> NO <input type="checkbox"/> | |
| Property will be principal residence of buyer on the above stated date | YES <input type="checkbox"/> NO <input type="checkbox"/> | |
| Do you own any other residential property in the United States? | YES <input type="checkbox"/> NO <input type="checkbox"/> | |
| Signature (BUYER ONLY) _____ | | |

Legal Description (Please include the number of acres for unplatted properties)

Lot 2 in Block 33, Town of Oelrichs, Fall River County, South Dakota

(1) Date of Instrument 02/04/20

(2) Type of Instrument:

| | | | |
|--|---|---|---------------------------------------|
| Contract for Deed <input type="checkbox"/> | Warranty Deed <input type="checkbox"/> | Executor's Deed <input type="checkbox"/> | Mineral Deed <input type="checkbox"/> |
| Quit Claim Deed <input type="checkbox"/> | Trustee's Deed <input type="checkbox"/> | Administrator's Deed <input type="checkbox"/> | Gift <input type="checkbox"/> |
| Other (specify) <input checked="" type="checkbox"/> COUNTY | | | |

(3) Items Involved in Transaction

(a) Was this property offered for sale to the general public YES NO

(b) Relationship between buyer and seller? YES NO

(c) Was this property sold by owner Agent

(d) Actual Consideration Exchanged: \$ _____

(e) Adjusted price paid for real estate: \$ _____
(actual consideration less amount paid for major items of personal property which are listed below)

List any major items of personal property and their value which were included in the total purchase price (i.e. furniture, inventory, crops, leases, franchises):

(4) Was there Buyer Financing YES NO If yes - items (a) below MUST be completed

(a) Type of Buyer Financing - check where applicable

| | |
|---|---|
| Conventional Bank Loan <input type="checkbox"/> | Like Kind Exchange <input type="checkbox"/> |
| Cash Sale <input type="checkbox"/> | Assumed mortgage <input type="checkbox"/> |
| FHA, FmHA, SDHA Loan <input type="checkbox"/> | Farm Credit Service <input type="checkbox"/> |
| Contract for Deed <input type="checkbox"/> | Down Payment _____ Monthly/Yearly Payment _____ Interest Rate _____ |
| | No. of Payments _____ Balloon Payment _____ |

(Signature of Seller, Buyer or agent of _____) (Date) 02/04/20

AUDITOR'S ACCOUNT WITH THE COUNTY TREASURER

TO THE HONORABLE BOARD OF COUNTY COMMISSIONERS OF FALL RIVER COUNTY:

I hereby submit the following report of my examination of the cash and cash items in the hands of the County Treasurer of this County on this 31st day of January 2020.

Total Amt of Deposit in First Interstate Bank: \$649,259.85

Total Amt of Deposit in First National Bank of Lead: \$1,000.00

Total Amount of Cash: \$1,605.26

Total Amount of Treasurer's Change Fund: \$ 900.00

Total Amount of Checks in Treasurer's Possession Not Exceeding Three Days: \$50,011.55

SAVINGS:

First Interstate Bank: \$240,411.87

First National Bank of Lead: \$1,037,189.73

CERTIFICATES OF DEPOSIT:

First Interstate-Hot Springs: \$4,056,787.49

Black Hills Federal Credit Union: \$250,000.00

Bank of the West \$525,723.73

Schwab Treasury \$1,000,000.00

First National Bank – Lead \$300,000.00

Itemized list of all items, checks and drafts that have been in the Treasurer's possession over three days:

Register of Deeds Change Fund: \$500.00

Highway Petty Cash: \$20.00

Election Petty Cash: \$15.00

RETURNED CHECKS:

Bayan, Fritchie \$957.52, Lic 08/24/2018

Esslinger, Kevin \$233.43, Lic 12/31/2019

TOTAL \$8,114,615.43

Dated This 31st Day of January 2020.

Sue Ganje, County Auditor of Fall River County.

County Monies: \$7,529,402.00

Held for other Entities: \$421,886.45

Held in Trust: \$163,326.98

TOTAL: \$8,114,615.43

The Above Balance Reflects County Monies, Monies Held in Trust, and Monies Collected for and to be remitted to Other ENTITIES: SCHOOLS, TOWNS, TOWNSHIPS, FIRE AND AMBULANCE DISTRICTS, AND STATE.

February 27, 2020

Fall River County Commissioners
906 N River St.
Hot Springs, SD 57747

Re: Mental Health Billing Rate

Dear Fall River County Commissioners:

This letter is submitted on behalf of both attorney Chris Beesley, and attorney Garland Goff, as Chairpersons of the Fall River County Mental Health Board.

Attorney Beesley has been the Custer County Chairperson since the 1990s, and has been co-chair of the Fall River County Mental Health Board since the early 2000's. Attorney Goff has been the Fall River County Chairperson and co-chair of the Custer County Mental Health Board since approximately 2016.

In the 1990s the billing for mental health commitments was charged out at \$90 an hour; in early 2000 it was raised to \$100 per hour then in approximately 2010 it was raised to \$125 an hour. After a great deal of discussion regarding the amount of time and interruption of both our professional and our personal lives in fulfilling our duties to the mental health board, we determined in 2019 that we needed to raise the billing rate to \$150 an hour in order to recoup the time away from our normal duties in our private practice and time away from our personal lives. The calls for mental holds occur at any time of the day or night and also often occur during our off hours and holidays. Since these are emergency mental health commitments, they take precedence over any current activity that we are involved in, which requires us to set aside our clients, our normal work duties, and our families and friends in order to ensure that the mental health guidelines are being followed and to ensure the allegedly mentally ill individuals are getting the help they need. Both of us have had many holiday dinners interrupted, vacations interrupted, and work interrupted in order to provide these services.

I sincerely apologize for not submitting our previous email to the commissioners directly; however we felt that submitting emails to the States Attorney's office and the Auditors would prompt an investigation and/or research into whether or not you desired to continue with our services, or desired to find another, less expensive alternative.

Both of us currently have commitments, either in the office or in court, that prevent us from appearing before you on March 3, 2020 to discuss this matter with you in person. In the alternative, should you desire to talk with either of us directly, you may contact either or both of us on speaker phone. Our cell phones numbers are: Chris Beesley 673-1993; Garland Goff 517-1282.

I would further wish to state that we both fully believe in the appropriate representation of those individuals who are potentially a danger to themselves or to the public and alleged to be mentally ill. Consequently, we still desire to continue our duties in protecting these individuals and the public.

After you have had appropriate time to review this matter and discuss this between yourselves, please let us know your decision.

Respectfully, Chris Beesley and Garland Goff,

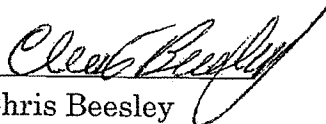
Chris Beesley

Garland Goff

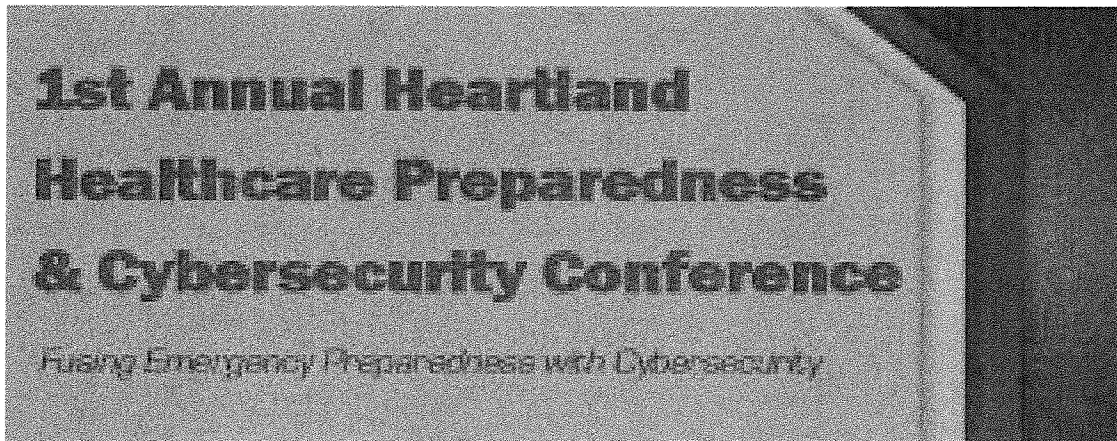

Are you prepared? Increasingly, hospitals and healthcare facilities are coming under sophisticated cybersecurity attacks. According to HIPAAJournal.com, healthcare data breaches are predicted to cost the industry \$4 Billion in 2020. What can you do to protect your facility? This conference is designed to bring the latest information and awareness to the cybersecurity threats and how they impact healthcare emergency preparedness. We will hear from our local, regional, and federal partners about the current threat environment and what the healthcare and IT community can do to combat this ongoing crisis.

Registration Fee: \$75.00

Student Registration Fee: \$25.00

Register Today!

Registration Deadlines:

- Rapid City: Tuesday, April 28, 2020

Are you interested in exhibiting at the conference?

Locations

Rapid City: Tuesday, May 5th – Wednesday, May 6th, 2020

Comfort Suite Hotel & Convention Center

1333 N Elk Vale Rd

Rapid City, SD 57703

605.791.2345

Rapid City:

Comfort Suites Hotel & Convention Center

605.791.5087

Mention DSU HealthPOINT to receive the group rate

To view the tentative agendas for the conference, click below

- [Rapid City Agenda \(See Attached\)](#)

Presenters – More information coming soon

1st Annual Heartland Healthcare Preparedness & Cybersecurity Conference
Fusing Emergency Preparedness with Cybersecurity
Rapid City Tentative Agenda
Tuesday, May 5 – Wednesday, May 6, 2020

Day 1

| | |
|-----------------|--|
| 9:00 – 9:30am | Registration |
| 9:30 – 9:45am | Welcome <i>Aaron Leesch</i> – Region 1 Public Health Preparedness Coordinator, SD Office of Public Health Preparedness <i>Kevin Atkins</i> – Director, Center of the Advancement of Health IT, Dakota State University |
| 9:45 – 11:15am | Why are we here? Keynote Speaker |
| 11:15 – 11:35am | Break and Networking <i>Snacks will be provided</i> |
| 11:35 – 12:35pm | The Anatomy of a Cybercrime |
| 12:35 – 1:30pm | Lunch and Networking <i>Lunch will be provided</i> |
| 1:30 – 3:30pm | What resources are available? Panel Discussion - Moderator Aaron Leesch <i>Harley Rinerson</i> – Chief of Operations - Central United States, Cyber Security Advisor Program, Region V, VII, VIII <i>Theodore Bartunek</i> – US Army |
| 3:30 – 3:50pm | Break and Networking <i>Snacks will be provided</i> |
| 3:50 – 4:50pm | Internet of things |
| 4:50 – 5:00pm | Day One Closing Remarks <i>Aaron Leesch</i> – Region 1 Public Health Preparedness Coordinator, SD Office of Public Health Preparedness <i>Kevin Atkins</i> – Director, Center of the Advancement of Health IT, Dakota State University |

Day 2

| | |
|-----------------|---|
| 9:00 – 9:15am | Welcome Back <i>Aaron Leesch</i> – Region 1 Public Health Preparedness Coordinator, SD Office of Public Health Preparedness <i>Kevin Atkins</i> – Director, Center of the Advancement of Health IT, Dakota State University |
| 9:15 – 10:15am | Ransomware attack from the view of a CEO |
| 10:15 – 10:35am | Break and Networking <i>Snacks will be provided</i> |
| 10:35 – noon | What is your plan? Keynote Speaker |
| Noon – 12:45pm | Lunch and Networking <i>Lunch will be provided</i> |
| 12:45 – 1:45pm | Paying the ransom v's not paying the ransom. Panel Discussion - Moderator Aaron Leesch |
| 1:45 – 2:45pm | HIPAA <i>Deana Fuller</i> |
| 2:45 – 3:00pm | Closing Remarks and Thank You <i>Aaron Leesch</i> – Region 1 Public Health Preparedness Coordinator, SD Office of Public Health Preparedness <i>Kevin Atkins</i> – Director, Center of the Advancement of Health IT, Dakota State University |

Fwd: [EXT] Your order has been cancelled. Dell Purchase ID:
2006845013577 Purchase Order: 55333187

Lyle Jensen <lyle.jensen@frcounty.org>

Thu 2/27/2020 4:00 PM

To:Ganje, Sue <Sue.Ganje@state.sd.us>;

----- Forwarded message -----

From: <Automated_Email@dell.com>

Date: Thu, Feb 27, 2020 at 3:05 PM

Subject: Your order has been cancelled. Dell Purchase ID: 2006845013577 Purchase Order: 55333187

To: <LYLEFRC@gmail.com>

Dell logo

Your order has been cancelled.

Some or all of the items in this order have been cancelled. You'll find your cancellation details below, and you can view all products in this order on your Order Status page.

If this order was cancelled in error, or if you'd like to place this order again, you can contact a Dell sales representative or call **800-624-9897** and we'll be happy to help. We hope you'll shop with Dell again soon!

Order summary

| | |
|-------------------|------------------|
| Order date | Dell Purchase ID |
| Feb. 27, 2020 | 2006845013577 |
| Cancellation date | Purchase Order |
| Feb. 27, 2020 | 55333187 |

Items cancelled (14)

| | |
|--------------|-----------|
| Order number | Status |
| 597081016 | Cancelled |

Shipping address
401 SOUTH DUFF ST

Description
OptiPlex 3070 SFF XCTO (14)

Contract code
C000000012055

Shipping & billing details

| | |
|-------------------|---------------------|
| Shipping address | Payment information |
| FALL RIVER COUNTY | Net Terms |
| LYLE JENSEN | |
| 401 SOUTH DUFF ST | |
| MITCHELL | |
| SD 57301-3331 | |
| US | |

Billing address
FALL RIVER COUNTY
LYLE JENSEN
906 N RIVER
HOT SPRINGS
SD 57747-1309
US

Need help?

Questions or problems related to your order? Visit us at dell.com/ordersupport. You can also manage returns, packing slips and invoices directly from your Purchase Details page.

Let's connect

This is an automated email that cannot accept replies.

Legal Disclaimers: Please note that Dell cannot be responsible for pricing or other errors and reserves the right to cancel any orders arising from such errors. The amount of tax and shipping added to your order depends on where you have asked for the product to be shipped as well as on which products and/or services you've chosen to purchase. All tax quoted above is estimated; final taxes will be listed on the invoice.

Consumers: Your order is subject to Dell's Consumer Terms of Sale (the terms include a binding arbitration provision).

Other Customers: Unless you have a separate written agreement that specifically applies to this order, your order is subject to the following agreements, each of which is available in hardcopy from Dell at your request:

If this purchase is for your internal use only: Dell's Commercial Terms of Sale, which incorporate Dell's U.S Return Policy and Warranty. If this purchase is intended for resale: Dell's Reseller Terms of Sale. If this purchase includes services: Dell's service contracts, in addition to Dell's Terms of Sale. If this purchase includes software: your use of the software is subject to the license terms accompanying the software (in absence of such terms, your use of Dell software is subject to Dell license agreements), in addition to Dell's Terms of Sale. You acknowledge having read and agree to be bound by the foregoing applicable terms. Any terms and conditions in your purchase order or any other correspondence that are in addition to, inconsistent or in conflict with, the foregoing applicable terms will be of no force or effect unless specifically agreed to in a writing signed by Dell that expressly references such terms. If you are a department, agency, division, or office of any district, state, county or municipal government within the United States, if any portion of the foregoing terms and conditions (or any terms referenced therein) is prohibited by applicable law, such portion shall not apply to you.

--

Lyle Jensen
Maintenance Supervisor
Fall River & Oglala Lakota County
Hot Springs SD 57747
Office 605-745-5144
Cell 605-890-0372

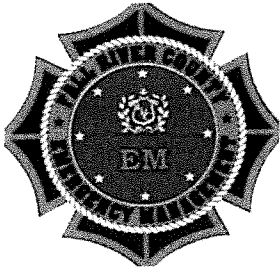

*Emergency Management
Fall River County*

*Franklin W. Maynard CEM CFM
906 N. River St.
Hot Springs, SD 57747*

605 745-7562 605 890-7245 frem@gwtc.net

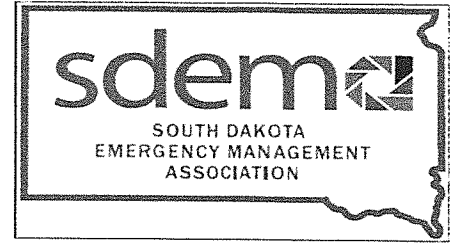

Date: March 3, 2020

Subj: Commission Update

1. **Flood Fight 2020:** The State OEM_office conducted a meeting on Monday, January 27th to discuss and gather information about county preparedness for the potential spring flooding issue. A survey has been provided to assess the capabilities for each county and is due by February 7th. A follow up conference call was conducted on February 27th with the Region 4 counties.
2. **Personnel Action Form:** I am requesting approval to have the Chairman sign the Personnel Action Form for Richard Kraima's resignation.
3. **Request for Staff:** I am requesting approval to advertise for either a 4 hour or 8 hour employee to back fill Richard's position. The South West District is funded for two full time positions per the LEMPG.
4. **Pre Disaster Mitigation Plan (PDM):** The PDM plan for Fall River County is at the end of the 5 year cycle, and the update is in draft form. Black Hills Council of Governments is the contractor that is completing the update. The plan identifies potential mitigation strategies and potential mitigation projects within the county to prevent loss of life and property. Planning meeting have been held with stakeholders to gather information for the plan. The draft plan is now being reviewed by the Planning Team.
5. **Fires & Incidents:**
 - 2/15/2020: Propane Leak: Hot Springs School: Hot Springs Fire & Police.
 - 2/17-18/2020: Structure Fire: Downtown Hot Springs: Hot Springs Fire, SD DOT, Pennington County Fire, Hot Springs Police, Hot Springs Ambulance, Red Cross and SD Fire Marshall's Office.
 - 2/22/2020: Motorcycle Accident: Hot Springs Fire, Police and Ambulance.
 - February/ 2020: Sixteen Controlled Burns

Franklin W. Maynard, CEM, CFM

Emergency Manager
Fall River County
906 N. River Street
Hot Springs, SD 57747

PERSONNEL ACTION FORM

DATE: February 20, 2020

TO: South Dakota Office of Emergency Management

FROM: Fall River County Emergency Management Organization

Approval of the following personnel action is requested for:

Richard Kraima

February 20, 2020

(Name of Employee)

(Effective Date)

| PERSONNEL ACTION | | | | | |
|------------------------|--|---|------------------|--|------------------------|
| | New Appointment | | Leave of Absence | | Appointment Terminated |
| | Promotion | | Demotion | | Dismissal |
| | Salary Adjustment | X | Resignation | | Other |
| Description/ Reason | Richard has been placed in Hospice Care due to his cancer. Treatment is no longer an option. | | | | |

CHANGE

(Complete all line items listed below)

| | FROM | | TO | |
|-------------------------|--------------|----------|--------------|----------|
| Position Title | Office Staff | | Office Staff | |
| Full Salary | 30,492.80 | Annually | 32,614.40 | Annually |
| Percentage of EM Time | 50 | | 50 | |
| Percentage Salary of EM | 15,246.40 | Annually | 16,307.20 | Annually |

I hereby certify that the above personnel change is in accordance with the current county compensation plan.

(Date)

=====

The signature below does not constitute any guarantee EMPG funding will be awarded for the above personnel action.

(Date)

Instructions: Complete and submit to your Regional Coordinator within thirty (30) days of the change. A copy will be returned after signature of the SDOEM Director.

MASS FATALITY MANAGEMENT CONFERENCE

MAY 12TH-13TH

Arrowwood Resort & Conference Center at Cedar Shore

1500 Shoreline Dr., Oacoma, SD 57365

For further information or to register
[Click Here](#)

Contact Adam Frerichs with any questions
adam.frerichs@state.sd.us
605-280-9412

**NO
CONFERENCE
FEE**

A block of rooms
has been
reserved at a
conference rate.
Contact
Arrowwood
Resort to make
your
reservation.

**SPONSORED
BY:**

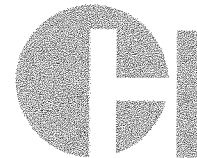

SOUTH DAKOTA
DEPARTMENT OF HEALTH

In cooperation with

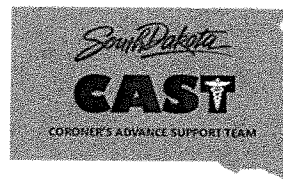

Mass Fatality Management Conference

Event Begins: May 12th, 2020 at 10 a.m.

Event Ends: May 13th, 2020 at 12 p.m.

Event Address: Arrowwood Resort and Conference Center at Cedar Shores
1500 Shoreline Dr, Oacoma, SD 57365

Call (888)697-6363 to book a room at a conference rate.

****No conference fee. Meals included.**

Conference topics include but are not limited to:

- Role of the County Coroner
- First Responder roles and considerations
- Decedent handling at scene
- Decontamination of remains and property
- Mental Health concerns for Responders and Victim's family members
- Understanding the purpose of a Family Assistance Center
- Death records

Full Agenda will be emailed prior to conference.

Contact Adam Frerichs with the SD Dept. of Health at 605-280-9412 or adam.frerichs@state.sd.us with any questions.

* Required

Name (First and Last) *

Your answer

Organization *

Your answer



2020

**APPEAL PROCESS GUIDE
FOR THE PROPERTY OWNER**

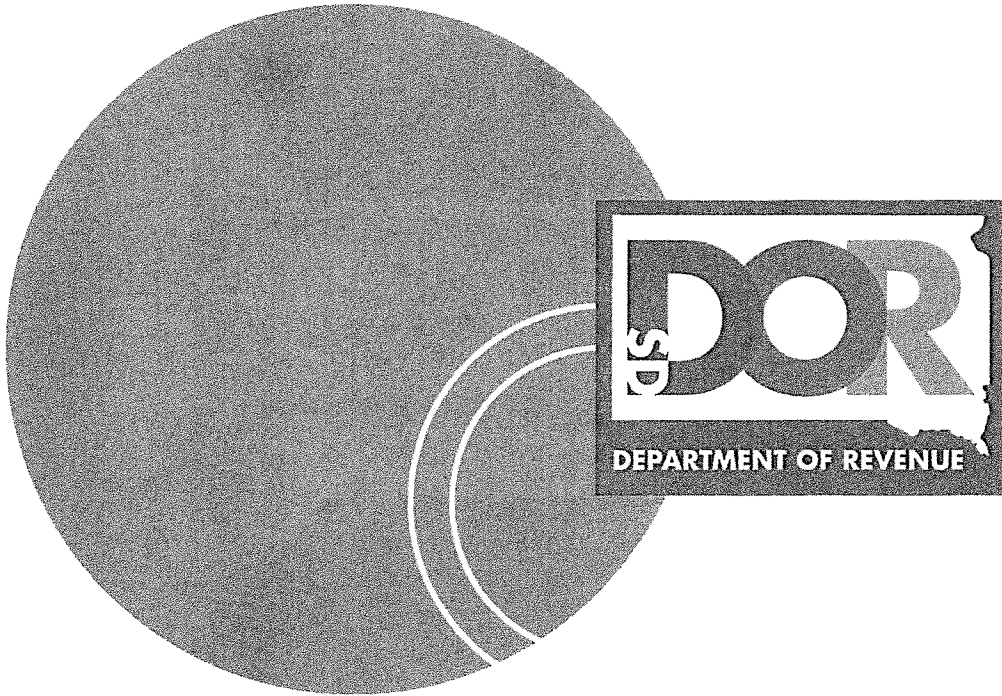

2020 APPEAL PROCESS TIME FRAME

March 1 - assessment notices must be mailed

March 15 - last day to file for owner-occupied status with Director of Equalization

Local Board of Equalization

March 12 - last day to mail or file¹ written appeal with clerk of local board (10-11-16)

March 16 - local board begins (10-11-13)

March 20 - local board ends (10-11-14)

March 27 - last day to receive written notice of local board's decision (10-11-16.1)

County Board of Equalization

April 7 - last day to mail or file¹ written appeal with county auditor (10-11-23)

April 14 - county board begins (10-11-25)

May 5 - county board ends (10-11-25)

May 8 - last day to receive written notice of county board's decision (10-11-26.1)

Consolidated Board of Equalization

April 7 - last day to mail or file¹ written appeal with county auditor (10-11-67)

April 14 - consolidated board begins (10-11-71)

May 5 - consolidated board ends (10-11-71)

May 8 - last day to receive written notice of consolidated board's decision (10-11-73)

Office of Hearing Examiners

May 15 - last day to mail or file¹ a written appeal (10-11-42) with:

Chief Administrative Hearing Officer

523 E. Capitol Ave

Pierre, SD 57501

Circuit Court

Appealing from County Board - you must appeal within 30 days after notice has been served of the decision.

Appealing from Office of Hearing Examiners - you must appeal within 30 days after notice of the decision.

¹ Use of the term "file" means in the hands of the official with whom it is to be filed. Postmarked by deadline is considered timely mailing.

It is important to remember that a property is to be valued fairly and uniformly. A property cannot be assessed higher than actual market value and cannot be assessed higher than other comparable properties.

If anyone has questions on this, please contact your local Director of Equalization or the Department of Revenue.

BASIC ASSESSMENT INFORMATION

In South Dakota, it is the assessor's responsibility to assign your property a value for tax purposes. For agricultural land, that value is based on the productivity value. For all other property, that value is equal to the amount for which it would sell on the open market. These values are sometimes called the "true and full value." After determining the market value and the classification of a parcel of property, the assessor sends a notice to the property owner. This assessment notice is to be mailed by March 1 of every year.

For Non-Agricultural property, Assessors determine the market value of property by using a combination of the following three approaches:

Cost approach - the assessor estimates the cost of replacing the property (structures), reduces that amount by its age (depreciation), and then adds the value of the land.

Market approach - the assessor compares the subject property to like properties that have recently been sold.

Income approach - the assessor uses the value of the projected income from like properties to determine value. The assessor also classifies property as agricultural or non-agricultural.

The assessor makes this determination by considering the amount of the owner's income derived from agriculture, the property's primary use and the property's size. All agricultural land is to be assessed using the productivity valuation method. Information concerning this valuation process and the data used to establish the values is available from your Director of Equalization and at the Department of Revenue and website at:

<https://dor.sd.gov/media/du0ftkef/aglandproductivity.pdf>

Owner-occupied single-family dwelling - This designates that the property is to receive a lower levy for school general fund tax purposes. To be eligible, the property owner must have filed an "Owner-Occupied Certificate" by March 15, 2020. (Any property previously designated as owner-occupied would remain so, unless it sold or had a change in use.)

You may appeal your property's owner-occupied status. This appeal is made directly to the County Board of Equalization. In your appeal you must state that you meet the qualifications which are:

- (1) You owned the property on November 1, 2019.
- (2) You occupied the property on November 1, 2019.
- (3) This is the only property you own that would receive the owner-occupied status.
- (4) That the property is your principal place of residence
- (5) You filed the certificate by March 15, 2020.

You may also appeal the taxable/exempt status of your property. This type of appeal is made directly to the County Board of Equalization. Decisions of County Board of Equalization may be appealed in the same manner as other decisions.

PROPERTY OWNER'S RIGHTS AND DUTIES

As the owner of real property in South Dakota, you have the right to ensure your property is being assessed at no more than market value, as well as assessed equitably in relationship to other properties. Any lessee responsible for payment of taxes pursuant to the provisions of a lease shall be considered the taxpayer and may also appeal the valuation, classification, taxable status of the property.

When you receive your assessment notice, it is your duty to review the notice to ensure the property is listed correctly. Also check the assessed value. Ask yourself "If I sold this property, is this the amount I would expect to receive?" If it is higher than what you think you could sell it for, first talk to your county director of equalization. He/she can explain how the values were determined and show you his/her methodology used in determining your value. If you still disagree with the assessment on your property, your first step in the appeal process is to the local board of equalization. Your appeal must be for the total value of the property. An appeal on just the structure value or just the land value will be considered an appeal of the entire property.

NOTE: The following people do not have to appeal to the local board before going to county board:

- Non-residents - A property owner is considered a non-resident if the person resides outside the local board jurisdiction. A non-resident does not have to appeal to the local board before appealing to county board but may do so if desired.
- Unorganized township property owners - as there is no local board for unorganized townships, these property owners appeal directly to the county board of equalization.

LOCAL BOARD

The first step in the appeal process is to the local board of equalization. The local boards consist of the township board of supervisors or the governing board of the municipality, and a member of the school board. The board's primary function is to determine that all taxable properties have been placed on the assessment roll and that a reasonable degree of equalization exists among these properties. The board, however, may only equalize assessments between individual properties. It may not change the level of assessment between entire classes of property, such as agricultural and non-agricultural.

To appeal to the local board, you must notify the clerk in writing of the local board, stating you wish to appeal the assessment of your property. The clerk must receive your notification by March 12, 2020. Postmarked by this date is considered timely. You should state the legal description of the property you are appealing and a brief explanation of why you are appealing, such as "property is higher than market value".

Your local board clerk will notify you when your appeal will be heard by the local board. During this hearing, the form PT17 must be completed. If you appear at the hearing, the clerk will help you complete the form. Your explanation of your appeal may be in person or in writing. It should state the reason you are appealing your assessment. You must also have evidence to prove your point. Just stating the value is too high is not enough. Suggested points are: sales of properties you believe are similar to your property, assessments of properties similar to yours, etc. Point out how the properties are comparable to your property.

The local board must notify you in writing of the decision by March 27, 2020.

COUNTY BOARD

If you disagree with the decision of the local board, you may appeal to the county board. This board is composed exclusively of county commissioners. The county board's primary functions are to hear appeals from property owners in unorganized territories and appeals from local board decisions and to see that all classes of property are equalized.

To appeal to the county board, you must write a letter to the county board, stating you wish to appeal the assessment of your property. The written appeal must be mailed to or received by the county auditor by April 7, 2020. Postmarked by this date is considered timely mailing. Your letter should state your name, the legal description of your property and a brief explanation of why you are appealing the valuation.

The county board will notify you when your appeal will be heard. The county board must notify you of their final decision by May 8, 2020.

CONSOLIDATED BOARD OF EQUALIZATION

If your property is in a jurisdiction that has chosen to consolidate the local and county board of equalization, your first step of the appeal process is to appeal to the Consolidated Board of Equalization. Look on your assessment notice to see if this applies to your property. This board is composed of the county commissioners and members from the local board of equalization, which may include township supervisors or city commissioners, and school board members.

To appeal to the consolidated board of equalization, you must write a letter to the consolidated board, c/o the county auditor, stating you wish to appeal the assessment of your property. The written appeal must be mailed to or received by the county auditor by April 7, 2020. Postmarked by this date is considered timely mailing. Your letter should state your name, the legal description of your property and a brief explanation of why you are appealing the valuation.

The consolidated board will notify you when your appeal will be heard. The consolidated board must notify you of their final decision by May 8, 2020.

OFFICE OF HEARING EXAMINERS (OHE)

If you disagree with the county or consolidated board's decision, you may appeal to the Office of Hearing Examiners. OHE is a central panel of administrative law judges who hear appeals within state government. You may also appeal directly from the county board to the circuit court. You may not, however, appeal to the OHE and the circuit court simultaneously.

To appeal to the OHE, you must write a letter to the chief administrative law judge. This letter must be mailed or received by May 15, 2020. If you appeal to OHE, you will receive additional information from that office on how and when the hearing of your appeal will be conducted.

Please note that the Department of Revenue is not involved in any OHE hearings or decisions. For more information on preparing and presenting your case, please visit the OHE website at: <https://boa.sd.gov/ohe/default.aspx>

CIRCUIT COURT

If you disagree with the decision of the OHE, you have the right to appeal to the circuit court. You may also take your appeal directly from the county board of equalization to the circuit court, bypassing the OHE. Please remember, you cannot appeal to the OHE and Circuit Court simultaneously.

APPEAL TO CIRCUIT COURT FROM COUNTY OR CONSOLIDATED BOARD OF EQUALIZATION - An appeal to circuit court from the county board of equalization or consolidated board of equalization shall be filed within thirty days of the published notice as required by SDCL 10-11-26.1 or the written notice that has been served of the decision by the county board of equalization.

APPEAL TO CIRCUIT COURT FROM OHE - To appeal to circuit court, you must do so within 30 days after receiving notice of the decision from OHE

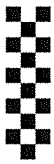

ACCEPTED
2/24/2020
KM

FAXED BID:

TO: FALL RIVER COUNTY HIGHWAY DEPT. FAX # 745-5912
PHONE # 745-5137

DATE: 2-24-20

745-4189

FROM: Nelson's Oil & Gas, Inc. PHONE: ~~745-600-5000~~

BID FOR: 8000 gallons 50/50 Dyall Fuel.

AMOUNT OF BID: \$ 2.07 / gallon
(This bid includes all appropriate taxes and fees)

Signed By: [Signature]

Richard Nelson

Note: all faxed bids must be received in the Fall River County Highway Dept. office at the above number before 11:00 a.m. to be considered unless otherwise stated by the caller for bids.

If declining to bid please fax back this form with the words; "Decline today's bid." On the line designated for the Bid Amount.

Thank You

will not deliver today

FAXED BID:

TO: FALL RIVER COUNTY HIGHWAY DEPT.

FAX # 745-5912

PHONE # 745-5137

DATE: 2/24/2020

FROM: MG OIL PHONE: BY EMAIL - PRINTS ATTACHED

BID FOR: 8000 GALS 50/50 DYED WINTER BLEND DIESEL

AMOUNT OF BID: N/A - BID DID NOT MEET 9 AM DEADLINE.

(THIS BID INCLUDES ALL APPROPRIATE TAXES AND FEES) Km

Signed By: MIKE KULISH BY MG OIL EMAIL
Km

NOTE: all faxed bids must be received in the Fall River County Highway Dept. office at the above number before 9:00 a.m. to be considered, unless otherwise stated by the caller for bids.

If declining to bid please fax back this form with the words; **"Decline todays bid"** on the line designated for the Bid Amount.

THANK YOU

Subject **RE: SEEKING BIDS ON 8000 GALS DYED WINTERBLEND 50/50 DIESEL**
From Mike Kulish <mkulish@MGOIL.com>
To hwyofficemgr@gwtc.net <hwyofficemgr@gwtc.net>
Cc Todd Moe <toddm@MGOIL.com>
Date 2020-02-24 09:30

50/50 Dyed

2.159 delivered.

Thank you

Mike

-----Original Message-----

From: hwyofficemgr@gwtc.net <hwyofficemgr@gwtc.net>
Sent: Monday, February 24, 2020 7:15 AM
To: Dispatch <dispatch@MGOIL.com>
Subject: SEEKING BIDS ON 8000 GALS DYED WINTERBLEND 50/50 DIESEL

SEEKING BIDS ON 8000 GALS DYED WINTERBLEND 50/50 DIESEL, TO BE DELIVERED TO THE FALL RIVER COUNTY HWY SHOP AT 27518 CASCADE ROAD, HOT SPRINGS, SD.

Confidentiality Notice: This email message, including any attachments, is for the sole use of the intended recipients and may contain confidential and privileged information. Any unauthorized review, use, disclosure or distribution is prohibited. If you are not the intended recipient, please contact the sender by reply email and destroy all copies of the original message and any attachment(s). Thank you.

Confidentiality Notice: This email message, including any attachments, is for the sole use of the intended recipients and may contain confidential and privileged information. Any unauthorized review, use, disclosure or distribution is prohibited. If you are not the intended recipient, please contact the sender by reply email and destroy all copies of the original message and any attachment(s). Thank you.

FAXED BID:

TO: FALL RIVER COUNTY HIGHWAY DEPT.

FAX # 745-5912

PHONE # 745-5137

DATE: 2/24/2020

FROM: HI-D-WAY FUEL PHONE: 890-1010

BID FOR: NO BID - NOT PLACING TANKER ORDERS Km

AMOUNT OF BID: _____

(THIS BID INCLUDES ALL APPROPRIATE TAXES AND FEES)

Signed By: Bill Tanner BY PHONE.
Km

NOTE: all faxed bids must be received in the Fall River County Highway Dept. office at the above number before 9:00 a.m. to be considered, unless otherwise stated by the caller for bids.

If declining to bid please fax back this form with the words; **"Decline todays bid"** on the line designated for the Bid Amount.

THANK YOU

APPLICATION FOR PERMIT TO OCCUPY COUNTY HIGHWAY RIGHT-OF-WAY

TO: THE BOARD OF COUNTY COMMISSIONERS

DATE: 2/25/2020

FALL RIVER COUNTY,
HOT SPRINGS, SOUTH DAKOTA

Application is hereby made by Golden West Telecommunications, South Dakota for permit to occupy highway right-of-way located from: Existing pedistal near driveway to 12876 Shep's Canyon Road
To: Property line between 12879 and 12889 Shep's Canyon Road.

AERIAL FACILITIES: Location, type and size of the proposed line and anchors with respect to the centerline of the road or outer edge of the right-of-way and location of crossings showing any right-of-way are shown on Exhibit "A" (Sketch) attached.

UNDERGROUND FACILITIES: A sketch showing the approximate route and location of the proposed facility for which a permit is hereby requested is attached as Exhibit "A" and made a part hereof.

The following information is pertinent to the proposed installation:

1. Intended usage or rating: To provide service to residence at 12889 Shep's Canyon Road
2. Pipe size, cable size and type: Cable: 6pr-22ga Copper; Duct: Sch 40 PVC
3. Outside diameter: Cable: 0.43"; Duct: 1.660"
4. Maximum pressure at which pipeline will be operated: N/A
5. Size and Type of metal casing: N/A
6. Minimum depth of cable or pipeline: 36"
7. Casing will be installed by minimum size boring and will extend from toe of in-slope to toe of in-slope.
8. This installation will comply with the most recently adopted ASA, Code for Gas Transmission and Distribution Pipe systems or the National Safety Code. Marker sign(s) will be installed where appropriate.

The installation and maintenance of said utility facilities will not interfere with or impair construction, maintenance or use of any highway and will comply with all safety regulations of the State and Federal Government. When trenching is done on County R.O.W. the trenches must be tamped to avoid any settlement.

Future adjustments and maintenance will be in accordance with State and Federal Laws and Regulations and will be performed at not cost to the County or the Federal Government.

APPROVED _____ 20 ____

SUBMITTED 25-Feb _____ 20 20

County Chairman

Golden West Telecommunications

County Auditor



By *Mickie Abell* Mickie Abell

Right-of-Way Technician

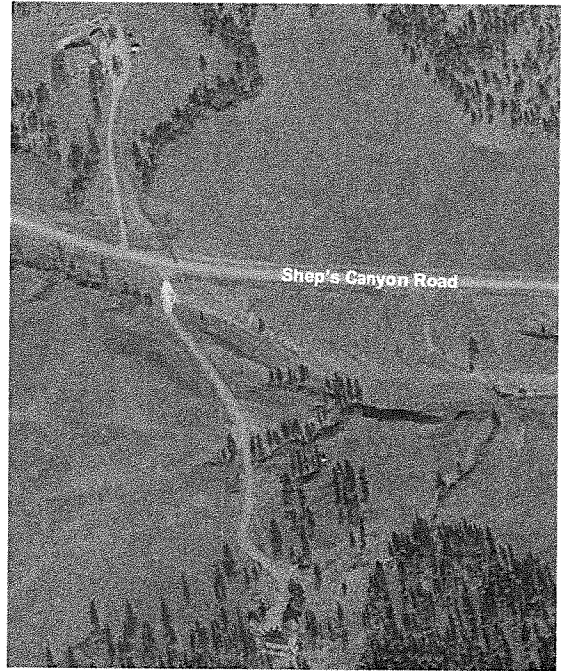
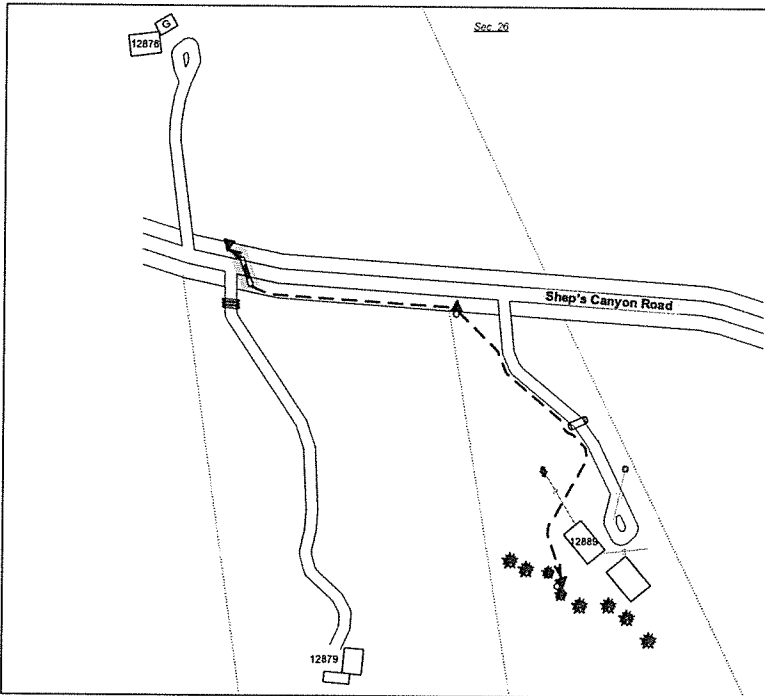
Title



CONFIDENTIAL

-  Proposed Cable Route
-  Proposed Bore

State: South Dakota
 County: Fall River
 Range: SE
 Twp: RS



CAUTION: BURIED FACILITIES MAY BE PRESENT. THE CONTRACTOR IS SOLELY RESPONSIBLE FOR LOCATING PRIOR TO CONSTRUCTION.

| As Stated | | |
|--------------------------------|--------------------|---------------|
| Golden West Telecommunications | | |
| Name: | Fall River Center | |
| WO: | Hot Springs 12035 | |
| Esth: | Hot Springs | |
| Route: | Shep's Canyon Rd | |
| ROW: | Public and Private | |
| Drawn By: | SEF | Date: 1-23-20 |
| Revised By: | SEF | Date: 2-24-20 |
| Revised By: | MAA | Date: 7-25-20 |
| Revised By: | | Date: |
| Revised By: | | Date: |
| Revised By: | | Date: |
| As Built By: | | Date: |
| Drawing Not To Scale | | |
| Sheet | 1 | of 1 |

**2020 GUIDE SPEC FOR CRUSHING GRAVEL ROAD SURFACING AGGREGATE
(2-2-2020)**

Please do not put the first three pages of this document in a contract

Specification User Note: The three-page gravel crushing spec at the end of this document is intended to produce gravel that will have the following benefits: develop a good road crust that reduces dust; reduce raveling, wash boarding and gravel loss; and retain chloride and other dust abatement materials. This guide spec has been changed annually since 2014. Feedback comes from counties, testing firms and contractors. The first three pages are user notes to help agencies decide what parts of the spec they should or should not use. The last part of the user note contains suggestions for lowering crushed gravel bid prices. Please contact me (steve@monlux@gmail.com 406-544-1919) for an MSWord version for editing, additional info, feedback or assistance.

Critical elements of this specification include the following:

Subsection 2.2A

- a. Gradation curves for three of the six Pay Adjustment Factors are shown at right.
- b. The pay adjustment factor improves gradation results and reduces disputes when materials are out of specification. For the pay adjustment to be effective there must be a 10% limitation on the mobilization bid item to prevent unbalanced bidding.
- c. Gradation, fracture and plasticity index test requirements must be tailored to materials sources that are owned by counties or local commercial sources.

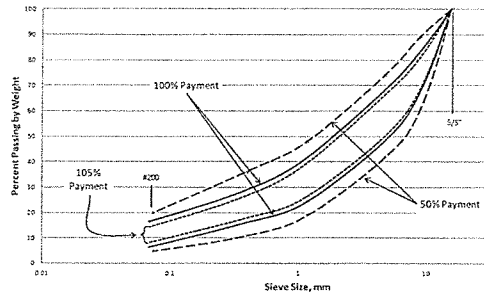

Before contract advertisement, sample and test designated sources, and then change Table 1 requirements to make sure spec limits are realistic. If you establish different gradation limits for the 1.0 pay factor column, note that the gradations for the other pay factor columns differ by 2%, except for the minus #200 that differs by 1%. The spec contains a gradation table for ¾ minus – you can cut that table out and paste in the 1” minus or 5/8” minus tables shown on page three of the user note. You may want to delete the requirements for PI and % Fracture if you know the designated source contains the right amount of clay and has large rock. Deleting the plasticity requirements will reduce bids and is suggested when (1) clay in source is known to be adequate or (2) two percent bentonite or four percent stockpiled clay is specified – be aware that although deleting requirements lowers bids, there are risks – it is safer to keep the requirements in the spec to be sure you get the desired end product. Yet another strategy is to figure out how much clay is needed before crushing, and make adding clay while crushing an additive bid item – after seeing bids decide if bids for adding clay while crushing are lower cost than adding clay on the road with your road crew. Contact me about methods to add clay on the road or to the stockpile.

Subsection 2.2B. Basing acceptance on the average of all acceptance test results will lower bids and better represents gravel placed on the road since mixing occurs while loading out stockpiles. If hauling and placing gravel on the road during crushing, change acceptance and payment to individual acceptance test results – make edits to the sentence in Subsection 4.2 (A)(1) and (2).

Subsection 2.2C. Since contractor testing controls the quality of gravel, the splitting of samples and testing must be done correctly. The County consultant lab is the most qualified party to check out the Contractor’s test procedures and equipment. This checking process builds relationships between the two parties ahead of disputes over test results that are always counterproductive. Maximum allowable differences between test results are shown in parenthesis in the first column of Table 1.

Subsection 2.3A. The daily acceptance sample process helps avoid bias in sampling by taking large bucket loader samples throughout the day that form a composite sample that represents the daily production much better than a typical “snapshot” belt sample. This approach also reduces testing costs. Normally 10 to 20 acceptance samples are enough for crushing contracts up to 30,000 cubic yards. The 200-ton interval for bucket loads can be changed to other tonnages or changed to five per shift or 5 per day depending on how much rock is crushed per hour and the total contract quantity. Many options exist.

Subsection 2.3B. Comparing Contractor test results on acceptance samples with the results from the Consultant lab will help assure that crusher adjustments are based on reliable information. This comparison should be done each

day during the first several days of crushing to gain confidence in Contractor testing. Since acceptance is based on the Consultant lab results, all testing should be done promptly to avoid problems.

Subsection 3.1A. The stockpile floor requirements are included where Counties do not have the resources or time to prepare a proper floor. The four-inch layer of crushed aggregate on the floor may not be necessary when a stable pit run floor is available. Normally at the start of crushing, some crushed aggregate is out of spec and is used to build the floor and reduces the chance for contamination.

Subsection 3.1B. This subsection intends to reduce segregation.

Subsection 3.2A. Selecting one of the five options for clay binder in the gravel depends on the materials source and how much you want to pay to achieve a gradation that builds a good road crust that reduces gravel loss, raveling and wash boarding. If the gravel source is non-plastic, adding 2% bentonite or 4% bank run clay is normally safe – higher amounts will build a better road crust, but could be slippery after rains and may rut in the spring. Change requirements in Table 1 to be consistent with the option selected. Option V can be cost-effective if you spread gravel more than 2 inches thick, and want to add clay in-place on the road with your road crew. Dry bentonite has been spread with belly dumps after mixing 2:1 with gravel and has also been spread in a slurry form with water trucks (more details are available). Some commercial sources of Bentonite are listed below. Costs at the source are usually \$65/Ton in bulk pneumatic shipments and \$120/Ton in bulk bags. Shipping costs can exceed that of Bentonite.

Bentonite Sources

Performance Minerals, Lovell WY 82431 (307) 548-2271

Performance Minerals, Belle Fourche SD (307) 896-2596

Black Hills Bentonite, Casper WY 82601 (307) 265-3740

BLM, Salmon ID 83467 (208) 756-5495

Canadian Clay Products, Wilcox SK S0G 5E0 (306) 732-2085

Central Oregon Bentonite, Prineville OR 97754 (541) 477-3351

Minerals Technologies, Lovell WY 82431 (303) 551-5529

Redmond Minerals, Aurora UT 84670 (866) 440-2529

Teague Mineral Products, Adrian OR 97901 (541) 339-3940

Tolsa Wyoming Bentonite, Casper WY 82604 (307) 224-5114

Western Clay Co, Aurora UT 84620 (888) 377-3719

Wyo-Ben, Greybull WY 82426 (406) 652-6351

Commented [CM1]:

Subsection 3.2C. This paragraph contains the typical disclaimer language needed when a county source is designated. Normally, if good source investigation methods are used and specs are tailored to the source, problems will be avoided.

Subsection 3.3A. The best of all worlds is for the owner to make the source meet MSHA requirements. Periodic digital photos of the high wall will help document source quality which can help resolve disputes. These photos can also be used during the next crushing contract to give prospective bidders a better idea of how to bid on your contract.

Subsection 4.1A. The cubic yard payment has several advantages now that accurate survey software and drones exist. This approach avoids contractor manipulation of belt or loader scales and also makes it easier to determine the stockpile quantity for internal annual audits required by most counties.

Subsection 4.1B. The 90 to 110 percent range for acceptable quantity was established to reduce bidding contingencies associated with the Contractor not getting paid for the quantity that was actually crushed.

Subsection 4.2A. The payment adjustment factor may be the most important part of this specification for both the County and the Contractor. Marginally qualified Contractors or those that traditionally bid low and submit numerous claims will typically bid higher because the payment process for out of spec gravel is not negotiable.

Subsection 4.2B. The purpose of this paragraph is to guard against bias sampling that could take place during the daily acceptance sampling process in Subsection 2.3A. Following ASTM D75-19 procedures are critical.

Subsection 4.2C. The five percent bonus for good stockpiling techniques and equipment was added to reflect the benefits of reduced segregation.

Spec Subsection references that refer to the drawings:

Subsection 3.1A. Pit plan drawings should show stockpile locations for top-soil, overburden and crushed aggregate.

Subsection 3.2A, C & D: Pit plan drawings should include the following: mining area boundaries, vertical and horizontal excavation limits, clay or other additive stockpile location (if applicable), cross-sections through each test pit hole location and test data, as well as stripping depths for top-soil and overburden that will ensure the project quantities and County source utilization objectives will be met.

Subsection 3.3: Pit reclamation requirements- indicate if a high wall is to be removed or left in place for later removal and reclamation by County. If desired, include complete pit reclamation (spreading topsoil, etc) as a separate bid item in the last crushing contract.

Suggestions that can lower crushed gravel bid prices:

- **Increase quantity** of crushed rock will reduce cost per cubic yard by offsetting mobilization costs.
- **Multi-year contracts** may allow contractors to work during winter months when they would normally be slow, or permit more flexible scheduling of work.
- **A good investigation** of material source and adjustment of gradation limits to make them realistic.
- **Delete PI and % Fracture requirements** if you know by past testing that the source produces adequate binder and % fracture.
- **Overburden stripping and stockpiling** that is consistent with a long term pit plan.
- **Allow the Contractor to determine the size of oversize to reject.** If sources contain large rock, costs can be reduced by allowing the contractor to determine the size & amount of reject. This can also benefit the county if they use large rock for erosion control, rip rap, buttress walls, etc. Do not delete % fracture spec.
- **Stockpiling contracts** are lower cost than having rock placed on the road. Another advantage with stockpiling contracts is that acceptance is simplified and quantity determination is less likely to result in disputes
- **Better Specifications:** Daily acceptance sample testing; Final acceptance on average gradation for stockpile contracts; Simple pay adjustment system with bonus; 10% flexibility on quantity based on actual measurement.
- **Gradations test data** from previous crushing contracts – indicate the data is available.
- **Relationship with the Contractor.** Meet individually with local crushing contractors to discuss spec changes and ask for input before putting out the contract.

Alternative to Table 1 requirements for 5/8" minus gravel

| Pay Adjustment Factor | 1.05 | 1.00 | 0.95 | 0.75 | 0.50 | 0.00 |
|--|-----------------|-------|-------|-------|-------|------------|
| Sieve Size | Percent Passing | | | | | |
| 5/8 inch | 100 | 100 | 100 | 100 | 100 | 100 |
| 3/8 inch (8) | 69-81 | 67-83 | 65-85 | 63-87 | 61-89 | <61 or >89 |
| No. 4 (6) | 50-66 | 48-68 | 46-70 | 44-72 | 42-74 | <42 or >74 |
| No. 16 (4) | 27-40 | 25-42 | 23-44 | 21-46 | 19-48 | <19 or >48 |
| No. 40 (3) | 19-28 | 17-30 | 15-32 | 13-34 | 11-36 | <11 or >36 |
| No. 200 (2) | 10-16 | 8-18 | 7-19 | 6-20 | 5-20 | <5 or >20 |
| % Fracture, one face, min (15) | 75 | 65 | 60 | 55 | 50 | <50 |
| Plasticity Index (5) | 4-10 | 4-10 | 2-10 | 0-10 | 0-12 | 0 or >12 |
| Values within parenthesis are maximum allowable differences between Consultant and Contractor Test results | | | | | | |

Alternative to Table 1 requirements for 1" minus gravel

| Pay Adjustment Factor | 1.05 | 1 | 0.95 | 0.75 | 0.5 | 0 |
|--|-----------------|--------|--------|--------|--------|------------|
| Sieve Size | Percent Passing | | | | | |
| 1-1/2 inch | 100 | 100 | 100 | 100 | 100 | 100 |
| 1 inch | 97-100 | 97-100 | 97-100 | 97-100 | 97-100 | <97 |
| 3/8 inch (8) | 70-83 | 68-85 | 66-87 | 64-89 | 62-91 | <62 or >91 |
| No. 4 (6) | 47-62 | 45-64 | 43-66 | 41-68 | 39-70 | <39 or >70 |
| No. 16 (4) | 27-40 | 25-42 | 23-44 | 21-46 | 19-48 | <19 or >48 |
| No. 40 (3) | 18-27 | 16-29 | 14-31 | 12-33 | 10-35 | <10 or >35 |
| No. 200 (2) | 10-16 | 8-18 | 7-19 | 6-20 | 5-20 | <5 or >20 |
| % Fracture, one face, min (15) | 75 | 65 | 60 | 55 | 50 | <50 |
| Plasticity Index (5) | 4-10 | 4-10 | 2-10 | 0-10 | 0-12 | 0 or >12 |
| Values within parenthesis are maximum allowable differences between Consultant and Contractor Test results | | | | | | |

**GUIDE SPEC FOR CRUSHING GRAVEL ROAD SURFACING AGGREGATE
(2-2-2020)**

PART 1: GENERAL

1.1 DESCRIPTION

- A. This work is the crushing and stockpiling of gravel road surfacing aggregate composed of crushed gravel, stone or other similar materials meeting the gradation and other quality criteria specified herein.

1.2 REFERENCES

- ASTM D75-19 Sampling of Aggregates
- AASHTO T11 Amount Finer than No 200 (0.075mm) Sieve in Aggregate
- AASHTO T27 Sieve Analysis of Fine and Coarse Aggregates
- AASHTO T89 Determining Liquid Limit of Soils
- AASHTO T90 Determining the Plastic Limit and Plasticity Index of Soils
- AASHTO T146 Wet Sample Preparation (Required when clay balls encountered)
- AASHTO T248 Reducing Samples of Aggregate to Testing Size
- ASTM D5821 Determining the Percentage of Fractured Particles in Coarse Aggregate

PART 2: PRODUCT

2.1 CRUSHED SURFACE MATERIAL QUALITY

- A. Furnish crushed aggregate that meets requirements in TABLE 1 Section 2.2A.
- B. Provide fine and coarse fragments of crushed stone or crushed gravel and/or natural gravel, and when approved, blended with sand or clay, finely crushed stone, crusher screenings, recycled concrete and/or asphalt or other similar materials.
- C. Use crushed stone or gravel consisting of hard, durable particles or fragments of stone, free of excess flat, elongated, soft or disintegrated pieces, or other deleterious matter.

2.2 GRADATION, PLASTICITY AND PERCENT FRACTURE

- A. Furnish material meeting requirements in TABLE 1 below. Pay Adjustment Factors are explained in Subsection 4.2A.

TABLE 1 REQUIREMENTS. GRADATION, % FRACTURE AND PLASTICITY INDEX

| Pay Adjustment Factor | 1.05 | 1 | 0.95 | 0.75 | 0.5 | 0 |
|--|-----------------|--------|--------|--------|--------|------------|
| Sieve Size | Percent Passing | | | | | |
| 1inch | 100 | 100 | 100 | 100 | 100 | 100 |
| 3/4 inch | 97-100 | 97-100 | 97-100 | 97-100 | 97-100 | <97 |
| 3/8 inch (8) | 70-83 | 68-85 | 66-87 | 64-89 | 62-91 | <62 or >91 |
| No. 4 (6) | 47-62 | 45-64 | 43-66 | 41-68 | 39-70 | <39 or >70 |
| No. 16 (4) | 27-40 | 25-42 | 23-44 | 21-46 | 19-48 | <19 or >48 |
| No. 40 (3) | 18-27 | 16-29 | 14-31 | 12-33 | 10-35 | <10 or >35 |
| No. 200 (2) | 10-16 | 8-18 | 7-19 | 6-20 | 5-20 | <5 or >20 |
| % Fracture, one face, min (15) | 75 | 65 | 60 | 55 | 50 | <50 |
| Plasticity Index (5) | 4-10 | 4-10 | 2-10 | 0-10 | 0-12 | 0 or >12 |
| Values within parenthesis are maximum allowable differences between Consultant and Contractor Test results | | | | | | |

- B. Acceptance of aggregate is based on the average test result from acceptance samples obtained during crushing unless samples from finished work differ by more than the maximum allowable differences shown in Table 1.
- C. Prior to crushing, demonstrate all sampling, splitting and testing to be done on-site. Provide contact information for any testing to be done by consultants off-site.

2.3 SAMPLING, SAMPLE PREPARATION AND TESTING OF DAILY ACCEPTANCE SAMPLES

- A. Build daily acceptance sample stockpiles by taking full bucket load samples with a front-end loader for every 200 tons crushed. Follow ASTM D75-19 Section 5.3.3.1. procedures. Sample from fixed rotary stacking conveyors by sampling from the fresh pile face between the coarse and fine sides of the pile. Sample from telescoping rotary stacking conveyors by diverting the stream to fill up a loader bucket. When stockpiling with hauling vehicles, take bucket loads from the surge pile or by filling the bucket from the surge bin before loading hauling vehicles. At the end of the day or shift, mix the sampling stockpile with a front-end loader, and then flatten to a 12 to 15-inch-thick layer by back dragging the bucket cutting edge. Make a daily acceptance sample from an equal number of shovelfuls from each of the four quadrants of the flattened surface such that the sample weight exceeds 110 pounds for one-inch minus or 55 pounds for ¾ inch minus aggregate. Take two acceptance samples, one for Contractor testing and one for the County Consultant lab testing. If a County representative is not present during sampling (1) photograph the sample area with a camera that is programmed to record date and time of day photo was taken, and (2) send a text message along with the photo to the County representative.
- B. Provide and utilize on-site testing equipment for running tests on daily acceptance samples. Test samples immediately so that timely adjustments can be made to the crushing operation, source utilization, etc. to ensure future materials are within specification limits. Save all sample splits for "retesting" at a later date if that becomes necessary. Label all samples with sample number, date and time sample was taken and tonnage from belt scale totalizer (if available).
- C. Stop crushing and submit a written plan detailing operational changes when the following occurs:
 - a. Pay adjustment factor becomes less than 1.0
 - b. Contractor and County Consultant lab test results are not within maximum allowable differences shown in parenthesis in Table 1.

Commented [CM2]:

Commented [CM3]:

PART 3: EXECUTION

3.1 STOCKPILE SITE PERPARATIONAND STOCKPILING

- A. Strip top-soil and overburden and stockpile separately unless otherwise indicated on the drawings. Clear stockpile sites of weeds, roots, stumps, large rock and other contaminating matter. Dispose of this material as directed. Make the stockpile floor firm, smooth, well-drained, uniform in cross-section, and able to support the stockpile. Water and compact the stockpile floor to prevent rutting and settlement and where filling is necessary, place and compact material in layers no greater than in eight-inch depths. Place a four-inch-thick layer

- of one inch minus crushed aggregate on the floor to reduce stockpile contamination. Contact the County representative before crushing gravel for payment.
- B. Stockpile with equipment and by methods that control segregation, degradation and contamination. If using a traditional rotary stacking conveyor, do not let drop height exceed five feet after the initial conical pile is built. If using trucks or front-end loaders to stockpile do not dump or push material over the stockpile sides.

3.2 CRUSHING.

- A. (Option I – for pits with no clay): Uniformly add material containing clay in the amount needed during crushing to meet requirements in Table 1. Clay may need to be pulverized such that the crushed gravel has no more than two percent clay lumps retained on the No. 4 sieve. The plasticity index requirement can also be achieved by adding processed clay or bentonite from private offsite sources.
- A. (Option II – for gravel sources where the amount of clay is unknown): If necessary, add offsite clay or processed bentonite to meet plasticity index specifications in Table 1. Clay may need to be pulverized such that the crushed gravel has no more than two percent clay lumps retained on the No. 4 sieve.
- A. (Option III – where the Agency provides a stockpile of clay): While crushing and stockpiling aggregate, load, haul and uniformly add stockpiled clay shown on the drawings in the amount needed during crushing to meet requirements in Table 1. Clay may need to be pulverized such that the crushed gravel has no more than two percent clay lumps retained on the No. 4 sieve.
- A. (Option IV – where the Agency designates a clay source and specifies a by weight percentage to add to the aggregate – plasticity index requirement in Table 1 is deleted): Add clay from the designated source in the percent by weight of aggregate indicated on the drawings or in the schedule of items.
- A. (Option V – where the Agency knows clay is present in the desired amount in the source or the Agency plans to add clay to the stockpile or to gravel on the road after placement): Delete this Subsection and also delete requirements for plasticity index in Table 1.
- B. Utilize necessary methods and equipment to meet gradation and percent fracture requirements such as reducing production rates, tertiary stage crushing, additional screening capacity, etc.
- C. The quality of material in provided sources is acceptable in general but may contain layers or pockets of unacceptable materials. It is not feasible to ascertain from test hole samples the quality of materials for an entire deposit, and variations should be expected. Materials source investigation data is available upon request, including sample site locations, depth of samples, and test results. The contractor must determine the quantity and type of equipment and work necessary to produce acceptable materials. Private off-site gravel sources or additive materials may be used to meet specifications provided the crushed gravel is stockpiled at location(s) indicated in the contract documents.
- D. Stay within the mining area staked on the ground and cross-sections shown on the drawings for agency provided sources. Comply with all mining area requirements shown on the drawings and in applicable regulations.
- E. Calculate pay adjustment factors immediately after test results are available.

3.3 PIT RECLAMATION.

- A. Unless noted otherwise on the drawings reclaim pit and remove high wall under the direction of the County representative. Prearrange date(s) for reclamation so that the County representative can be onsite.

PART 4: MEASUREMENT AND PAYMENT

4.1 MEASUREMENT

- A. Determine cubic yard quantities of crushed aggregate by conducting measurements before and after stockpiles are built by employing a licensed surveyor to conduct measurements via a 3D or 2.5D reconstruction. Determine volume using unmanned aerial vehicle photogrammetric processes that capture a ground sample distance (GSD) of no more than 5 cm. Adequate ground control points (GCP) and check points (CP) must be incorporated whereby all points are collected according to industry-standard survey practices. Provide all survey data to the County for verification.
- B. Cubic Yard quantities between 90 and 110 percent of the specified quantities will be paid for according to the quantities determined as indicated above. No payment will be made for quantities exceeding 110 percent of the specified quantity.

4.2 PAYMENT.

- A. Payment is determined by multiplying the lowest pay adjustment factor (See Table 1 in Subsection 2.2) times the unit price times the total cubic yard quantity determined under Subsection 4.1 MEASUREMENT. The lowest pay adjustment factor is determined by (1) averaging all of the acceptance sample test results, (2) determining the pay adjustment factor for each of the requirements in Table 1 and (3) selecting the lowest pay adjustment factor from Step 2.
- B. Take three to five samples of finished work from the stockpile or road surface in accordance with ASTM D75-19, compare the average of daily acceptance samples to the average of finished work samples, and base payment on the finished work samples if any of the average test results do not fall within the tolerances shown in parenthesis in Table 1.
- C. Final payment will be increased by five percent when: (a) telescoping rotary stacking conveyors (“Telestacker®” by Superior Industries or equal) are used for stockpiling, or (b) stockpiles are built in three or more layers of relatively similar depth.

**BRIDGE REINSPECTION
PROGRAM RESOLUTION
FOR USE WITH SDDOT RETAINER CONTRACTS**

WHEREAS, Title 23, Section 151, *United States Code* and Title 23, Part 650, Subpart C, *Code of Federal Regulations*, requires initial inspection of all bridges and reinspection at intervals not to exceed two years with the exception of reinforced concrete box culverts that meet specific criteria. These culverts are reinspected at intervals not to exceed four years.

THEREFORE, _____ County is desirous of participating in the Bridge Inspection Program using Bridge Replacement funds.

The County requests SDDOT to hire _____ (Consulting Engineers) for the inspection work. SDDOT will secure federal approvals, make payments to the Consulting Engineer for inspection services rendered, and bill the County for 20% of the cost. The County will be responsible for the required 20% matching funds.

Dated this _____ day of _____, 2020, at _____, South Dakota.
(city)

Board of County Commissioners

Of _____ County

ATTEST:

County Auditor

Chairman of the Board

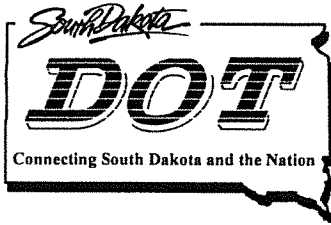

Department of Transportation

Division of Planning & Engineering

Office of Local Government Assistance

700 East Broadway Avenue

Pierre, South Dakota 57501-2586

OFFICE: 605/773-3390

FAX: 605/773-4870

TO: COUNTY HIGHWAY SUPERINTENDENT

FROM: Cody Axlund
Bridge Inspection Engineer

DATE: February 21, 2020

RE: BRIDGE INSPECTIONS (2020)

Dear Superintendent:

Attached to this memorandum is the consultant selection resolution and a computer printout of the bridges in your County that are due to be inspected during the calendar year 2020. Please review it carefully and make any comments regarding a change in status of any structure that may have been or is scheduled to be **CLOSED, REMOVED, REPLACED WITH A NEW STRUCTURE, OR REPLACED WITH A PIPE** since the last inspection. These comments may be shown on the computer printout. Your careful attention to this list will help reduce unnecessary inspection expenses.

The U.S. Federal Highway Administration requires the initial inspection of all bridges and the reinspection at intervals not to exceed two years (Title 23, Section 151, *United States Code* and Title 23, Part 650, Subpart C, *Code of Federal Regulations*) with the exception of reinforced concrete box culverts (RCBC) that meet specific criteria. These culverts are reinspected at intervals not to exceed four years. Any government jurisdiction failing to comply with the posting and reinspection requirements of the National Bridge Inspection Standards (NBIS) Program may lose its eligibility for Federal transportation dollars.

Most South Dakota Counties have done a commendable job in initiating and following through on bridge inspections and postings.

The NBIS Program requires all structures over 20 feet in length be inspected every two years (or four years for specific RCBC's) by a qualified inspector. To accomplish the inspections in your County during 2020, the following three approaches are open to you:

1. Hire a consulting engineer to inspect the bridges due for inspection and pay for these services utilizing 100% County funds;
2. Follow the prescribed South Dakota Department of Transportation (SDDOT) procedures for Consultant Selection of Engineering Services, hire the consultant of your choice and qualify for 80% Federal reimbursement participation in the cost of the inspections; or

3. Utilize one of the twenty-one (21) consulting firms listed on Attachment A that are under retainer contract with the SDDOT and pay 20% of the costs with County funds. The procedures to implement this step are detailed below.

Federal Bridge Replacement Funds can be utilized to hire qualified engineering firms to perform these inspections. However, Federal regulations define specific steps, including requests for proposals, evaluation committees, competitive negotiations, etc., which must be followed when using Federal funds. In an effort to assist Counties in securing Federal funds for bridge inspections, SDDOT has undertaken competitive negotiations with several consulting engineering firms. Twenty-one firms have been qualified to sign retainer agreements with SDDOT. Services performed under these retainer agreements are eligible for Federal participation.

If the County would like to utilize one of these firms under SDDOT retainer contracts, then the County should take the following steps:

1. The County should indicate the firm it wishes to employ in a resolution to SDDOT (copy attached) pledging to provide the local match required to obtain Federal Bridge Replacement funds.
2. SDDOT will initiate an agreement work order with the consulting engineering firm that you have selected for their execution. The consultant then forwards the original, fully executed, work order to you for your signature. You will forward the original, signed, work order to this office for signature. One copy will be returned to you, one copy is returned to the consultant, and the original is kept on file at SDDOT.

The work order indicates the location and types of structures to be inspected in your County. It also shows estimated travel, per diem, and other costs related to the inspection. The summation of all these costs will be the basis for the maximum limiting amount of the work order.

3. If the County does not concur with the work order, it can request SDDOT to contract with another firm under retainer.
4. SDDOT will then issue a *Notice to Proceed* to the consulting engineering firm with a copy sent to the County. SDDOT will bill the County for its local match as the consultant completes its unit work products.

Counties are under no obligation to use the twenty-one consulting engineering firms under SDDOT retainer agreements. Counties can still obtain Federal funds by conducting SDDOT approved competitive negotiations with other engineering firms or by using 100% County funds to pay for engineering services. SDDOT is offering these firms under retainer agreement to the Counties as a relatively quick way to get bridge inspections underway and still meet Federal requirements for competitive negotiations.

Please note that once again this year the consultants will be required to keep a ledger of their time and expenses for their inspection services. They will be reimbursed at a cost plus fixed fee rate for these services, similar to their reimbursement for design services. The flat rate per structure by structure type is no longer being used.

If you have any questions, please call me at (605) 773-3390.

ATTACHMENT A

**2020 CONSULTING ENGINEERING FIRM SELECTION LIST
FOR BRIDGE INSPECTIONS**

1. AECOM Technical Services – Waterloo, IA
2. Ayres Associates Inc. – Eau Claire, WI
3. Banner Associates, Inc. – Brookings, Milbank, and Sioux Falls, SD
4. Brosz Engineering, Inc. – Pierre, Sioux Falls and Sturgis, SD; Bowman, ND
5. Civil Design, Inc. – Brookings, SD
6. Clark Engineering Corporation – Aberdeen, Pierre, Sioux Falls, and Watertown, SD
7. Fickett Structural Solutions Inc. – Middleton, WI
8. HDR, Inc. – Sioux Falls, Rapid City, SD
9. Houston Engineering – Sioux Falls, SD; Fargo, ND
10. Infrastructure Design Group, Inc. – Sioux Falls and Watertown, SD
11. Interstate Engineering, Inc. – Pierre and Spearfish, SD; Wahpeton and Mandan, ND
12. Jacobs Engineering Group, Inc. – St. Louis, MO
13. JEO Consulting Group Inc. – Wahoo, NE
14. Johnson Engineering Company – Yankton, SD
15. Kirkham, Michael & Associates, Inc. – Omaha, NE
16. KLJ – Rapid City, SD; Bismarck, ND
17. Olsson, Inc. – Lincoln, NE
18. Short-Elliot-Hendrickson (SEH) Incorporated – Sioux Falls, SD
19. Stantec Consulting Services Inc. – St. Paul, MN
20. Ulteig Engineers, Inc. – Sioux Falls, SD; Fargo, ND
21. Wiss, Janney, Elstner Associates, Inc. – Northbrook, Illinois

| Bridge ID | County | Owner | Location | oppostcl | Next insp | Insp freq |
|-----------|---------------|-------|-------------------------|----------|-----------------------|-----------|
| 24020020 | 24 FALL RIVER | 2 | 1.1W & 0.3S BURDOCK | P | 4/25/2020 12:00:00 AM | 24 |
| 24029014 | 24 FALL RIVER | 2 | 0.2W & 0.3N BURDOCK | P | 4/25/2020 12:00:00 AM | 24 |
| 24099330 | 24 FALL RIVER | 2 | 10.2W & 1.5S ARDMORE | A | 4/25/2020 12:00:00 AM | 24 |
| 24102188 | 24 FALL RIVER | 2 | 0.1 E IGLOO (SD298) | P | 4/25/2020 12:00:00 AM | 24 |
| 24103188 | 24 FALL RIVER | 2 | 0.2 E IGLOO BHOD RD | P | 4/25/2020 12:00:00 AM | 24 |
| 24117130 | 24 FALL RIVER | 2 | 0.5S EDGEMONT | A | 5/24/2020 12:00:00 AM | 24 |
| 24135113 | 24 FALL RIVER | 2 | 2.2E EDGEMONT | A | 4/25/2020 12:00:00 AM | 24 |
| 24174064 | 24 FALL RIVER | 2 | 3S JCT SD 89 | A | 4/13/2020 12:00:00 AM | 48 |
| 24196315 | 24 FALL RIVER | 2 | 0.5W ARDMORE | A | 4/25/2020 12:00:00 AM | 24 |
| 24204160 | 24 FALL RIVER | 2 | 8.7E JCT SD 471 | A | 4/25/2020 12:00:00 AM | 24 |
| 24205315 | 24 FALL RIVER | 2 | 0.5E ARDMORE | A | 4/25/2020 12:00:00 AM | 24 |
| 24320085 | 24 FALL RIVER | 2 | 5.3S & 2.8E HOT SPRINGS | A | 4/24/2020 12:00:00 AM | 24 |
| 24325050 | 24 FALL RIVER | 2 | 3.2E & 1.8S HOT SPRINGS | P | 4/24/2020 12:00:00 AM | 24 |
| 24330084 | 24 FALL RIVER | 2 | 6.7W & 3.3S OF ORAL | A | 6/13/2020 12:00:00 AM | 24 |
| 24338080 | 24 FALL RIVER | 2 | 3S & 6W ORAL | A | 4/24/2020 12:00:00 AM | 24 |
| 24360143 | 24 FALL RIVER | 2 | 5.6W & 5.7N OELRICHS | A | 4/26/2020 12:00:00 AM | 24 |
| 24370070 | 24 FALL RIVER | 2 | 2.7W & 1.9S ORAL | A | 4/24/2020 12:00:00 AM | 24 |
| 24370145 | 24 FALL RIVER | 2 | 4.5W & 5.5N OELRICHS | A | 4/26/2020 12:00:00 AM | 24 |
| 24373070 | 24 FALL RIVER | 2 | 2S & 2W ORAL | A | 4/24/2020 12:00:00 AM | 24 |
| 24377200 | 24 FALL RIVER | 2 | 4W OELRICHS | A | 4/26/2020 12:00:00 AM | 24 |
| 24382200 | 24 FALL RIVER | 2 | 3.5W OELRICHS | A | 4/26/2020 12:00:00 AM | 24 |
| 24387040 | 24 FALL RIVER | 2 | 1N & 1W ORAL | A | 4/24/2020 12:00:00 AM | 24 |
| 24390069 | 24 FALL RIVER | 2 | 1.9S & 0.7W OF ORAL | A | 4/24/2020 12:00:00 AM | 24 |
| 24390289 | 24 FALL RIVER | 2 | 8.3S & 2.7W OELRICHS | A | 4/26/2020 12:00:00 AM | 24 |
| 24400174 | 24 FALL RIVER | 2 | 1.7W & 2.8N OELRICHS | A | 4/26/2020 12:00:00 AM | 24 |
| 24405201 | 24 FALL RIVER | 2 | 1.2W & 0.3S OELRICHS | A | 4/12/2020 12:00:00 AM | 48 |
| 24410063 | 24 FALL RIVER | 2 | 1.3E & 1.3S OF ORAL | A | 4/24/2020 12:00:00 AM | 24 |
| 24419212 | 24 FALL RIVER | 2 | 0.8S & 0.2E OELRICHS | P | 4/26/2020 12:00:00 AM | 24 |
| 24420053 | 24 FALL RIVER | 2 | 2.3E & 0.4S ORAL | A | 4/24/2020 12:00:00 AM | 24 |
| 24423120 | 24 FALL RIVER | 2 | E. CITY LIMIT SMITHWICK | A | 4/24/2020 12:00:00 AM | 24 |
| 24426050 | 24 FALL RIVER | 2 | 2.8E ORAL | A | 4/24/2020 12:00:00 AM | 24 |
| 24440046 | 24 FALL RIVER | 2 | 4.3E & 0.4N OF ORAL | A | 4/24/2020 12:00:00 AM | 24 |
| 24451040 | 24 FALL RIVER | 2 | 5.2N & 1N ORAL | A | 4/24/2020 12:00:00 AM | 24 |
| 24453037 | 24 FALL RIVER | 2 | 5.3E & 1.2N ORAL | A | 4/24/2020 12:00:00 AM | 24 |

| Length (ft) | Built | Material | Design |
|------------------|-------|------------------------|--------------------|
| 131.998031496063 | 1910 | 3 Steel | 10 Truss-Thru |
| 50 | 1991 | 5 Prestressed Concrete | 04 Tee Beam |
| 130.329995734908 | 2003 | 4 Steel Continuous | 02 Stringer/Girder |
| 154.002624671916 | 1940 | 7 Wood or Timber | 02 Stringer/Girder |
| 210 | 1945 | 7 Wood or Timber | 02 Stringer/Girder |
| 106.998031496063 | 1978 | 5 Prestressed Concrete | 02 Stringer/Girder |
| 162 | 2016 | 5 Prestressed Concrete | 02 Stringer/Girder |
| 20.0984251968504 | 1933 | 2 Concrete Continuous | 19 Culvert |
| 140.997375328084 | 1976 | 5 Prestressed Concrete | 04 Tee Beam |
| 35 | 1982 | 5 Prestressed Concrete | 04 Tee Beam |
| 51.998031496063 | 1935 | 5 Prestressed Concrete | 04 Tee Beam |
| 35 | 1950 | 5 Prestressed Concrete | 04 Tee Beam |
| 137.998687664042 | 1932 | 3 Steel | 02 Stringer/Girder |
| 40.997375328084 | 1986 | 5 Prestressed Concrete | 04 Tee Beam |
| 50 | 1974 | 5 Prestressed Concrete | 04 Tee Beam |
| 101.299212598425 | 1992 | 5 Prestressed Concrete | 04 Tee Beam |
| 31.998031496063 | 1981 | 5 Prestressed Concrete | 04 Tee Beam |
| 50 | 1979 | 5 Prestressed Concrete | 04 Tee Beam |
| 65 | 1978 | 5 Prestressed Concrete | 04 Tee Beam |
| 32.0898950131234 | 2000 | 2 Concrete Continuous | 19 Culvert |
| 34.85 | 2000 | 2 Concrete Continuous | 19 Culvert |
| 285.997375328084 | 1964 | 4 Steel Continuous | 02 Stringer/Girder |
| 31.998031496063 | 1987 | 5 Prestressed Concrete | 04 Tee Beam |
| 120 | 1988 | 5 Prestressed Concrete | 04 Tee Beam |
| 102.099737532808 | 1995 | 5 Prestressed Concrete | 04 Tee Beam |
| 32.75 | 2002 | 2 Concrete Continuous | 19 Culvert |
| 27.998687664042 | 1979 | 5 Prestressed Concrete | 04 Tee Beam |
| 31.998031496063 | 1930 | 3 Steel | 02 Stringer/Girder |
| 27.998687664042 | 1993 | 5 Prestressed Concrete | 04 Tee Beam |
| 40 | 1979 | 5 Prestressed Concrete | 04 Tee Beam |
| 28.497375328084 | 1936 | 5 Prestressed Concrete | 04 Tee Beam |
| 26.1975065616798 | 1950 | 5 Prestressed Concrete | 04 Tee Beam |
| 24.7998687664042 | 1950 | 5 Prestressed Concrete | 04 Tee Beam |
| 23.999343832021 | 1987 | 5 Prestressed Concrete | 04 Tee Beam |

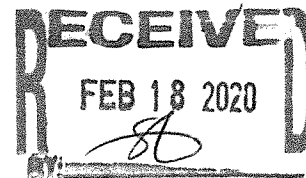
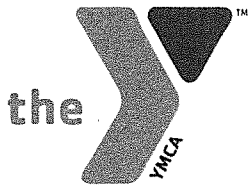

LETTER OF RECEIPT

FOR YOUTH DEVELOPMENT
FOR HEALTHY LIVING
FOR SOCIAL RESPONSIBILITY

February 14, 2020

Fall River County Commissioners
906 N River St.
Hot Springs, SD 57747

Dear Commissioners,

Thank you for your donation to the Edgemont YMCA! You are helping us continue our mission of putting Christian principles into practice through programs that build healthy spirit, mind and body for all.

You are helping provide the children in Edgemont the opportunity to participate in various programs throughout the year. Programs include after school care, sports, and summer camp. Currently, we have 23 students who attend Kidstop – our afterschool program, which offers a safe and fun learning environment to help children build strong character and grow our community.

Our sports programs include cheerleading, basketball, dance, and soccer during the school year. When we reach summer, children are able to spend time at the swimming pool and/or attend our five-week summer day camp to continue their learning during their break from school.

On behalf of all the youth touched by this funding, the board, volunteers and staff, thank you for making such a huge difference. If I can answer any questions or if you would like to visit our program, please call 662-7999 or email me at Kelsey@rcymca.org.

Yours truly,

Kelsey Trotter
Director

Receipt #: 13232
Amount: \$1,500.00

715 D Street
PO Box 29
Edgemont, SD 57735

605-662-7254
www.rcymca.org

The Edgemont Branch of the
YMCA of Rapid City formally acknowledges that
You received no goods or services in exchange
for this gift.

Please retain this letter of receipt for your records.



Thank You



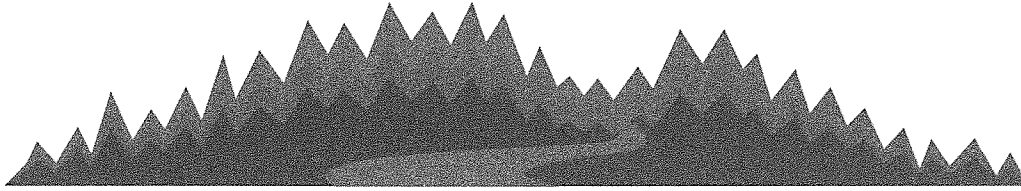

Black Hills Regional Multiple Use Coalition

P.O. Box 9496 • Rapid City, SD 57709 • 605-341-0875 • Fax 605-341-8651

MS. SUE GANJE
FALL RIVER COUNTY COMMISSIONERS
906 NORTH RIVER STREET
HOT SPRINGS, SD 57747

February 20, 2020

TO: BOARD OF DIRECTORS

SUBJECT: MEETING NOTICE

The February meeting of the Board of Directors will be at 4:00 pm February 28th at the Spearfish Holiday Inn. This will be a great meeting to attend as we will have Andrew Johnson, the acting Forest Supervisor for the Black Hills NF. Minutes from the January meeting will be available for review at the meeting.

The tentative agenda items are:

- Andrew Johnson, the acting Forest Supervisor for the Black Hills National Forest, will be our guest speaker. Andrew will discuss current issues on the BHNF and answer questions from members.
- Black Hills timber sale program
- Review BHRMUC letters
- Directors' Round Robin

Feel free to call me at 605-341-0875 if you have any questions or comments.

Ben Wudtke
Executive Secretary