

FALL RIVER COUNTY UNAPPROVED MINUTES OF APRIL 6, 2023

The Fall River Board of County Commissioners met in regular session on April 6, 2023. Present: Joe Allen, Les Cope, Joe Falkenburg, Deb Russell and Sue Ganje, Auditor. Heath Greenough was absent.

The Pledge of Allegiance was given, and the meeting called to order at 10:00 a.m.

The agenda was reviewed for conflicts; none were noted. ALL MOTIONS RECORDED IN THESE MINUTES WERE PASSED BY UNANIMOUS VOTE, UNLESS OTHERWISE STATED. The full context of the meeting can be found on the county website under Commissioners at <http://fallriver.sdcountries.org>, or, on Facebook, on the Fall River County page.

Motion made by Russell, seconded by Allen, to approve the agenda with the addition of Resolution 2023-16 regarding Deputy Charles Dobbs.

Motion made by Russell, seconded by Allen, to approve the minutes of March 2, 2023.

Motion made by Allen, seconded by Russell, to approve the Auditor's Account with the Treasurer as follows:

AUDITOR'S ACCOUNT WITH THE COUNTY TREASURER

TO THE HONORABLE BOARD OF FALL RIVER COUNTY COMMISSIONERS:

I hereby submit the following report of my examination of the cash and cash items in the hands of the County Treasurer of this County on this 28th day of February 2023.

AUDITOR'S ACCOUNT WITH THE COUNTY TREASURER

Total Amount of Deposit in First Interstate Bank, HS:	\$	536,052.37
Total Amount of Cash:	\$	1,144.47
Total Amount of Treasurer's Change Fund:	\$	900.00
Total Amount of Checks in Treasurer's Possession Not Exceeding Three Days:	\$	31,790.48
SAVINGS:		
#4) First Interstate Bank, HS:	\$	1,640,547.69
#20) First National Bank of Lead-RAI MM Acct	\$	112,087.24
CERTIFICATES OF DEPOSIT:		
#8) Black Hills Federal Credit Union, HS:	\$	250,000.00
#14) Schwab Treasury:	\$	954,802.53
#15) First National Bank, Lead:	\$	318,473.31
#21) Schwab Treasury 2 Yr:	\$	265,316.25
#22) Schwab Treasury 2 Yr:	\$	966,841.41
#23) Schwab Treasury 2 Yr:	\$	977,187.50

#24) Schwab Treasury 2 Yr:	\$	2,009,242.19
#25) Schwab Treasury 3 Yr:	\$	2,010,421.88
#26) Schwab Treasury 4 Yr:	\$	1,003,402.50

Itemized list of all items, checks and drafts that have been in the Treasurer's possession over three days:

Register of Deeds Change Fund:	\$	500.00
Highway Petty Cash:	\$	20.00
Election Petty Cash:	\$	15.00

RETURNED CHECKS:

\$ -

TOTAL \$ 11,078,744.82

Dated This 28th Day of February 2023.

/s/Sue Ganje, County Auditor of Fall River County

/s/Teresa Pullen, County Treasurer of Fall River County

County Monies	\$	10,183,651.35
Held for other Entities	\$	610,436.23
Held in Trust	\$	284,657.24
TOTAL	\$	11,078,744.82

The Above Balance Reflects County Monies, Monies Held in Trust, and Monies Collected for and to be remitted to Other ENTITIES: SCHOOLS, TOWNS, AND STATE.

Motion made by Cope, seconded by Russell, to rescind the motion from the July 7, 2022 minutes and surplus the 2013 Dodge Ram 1500 and 2014 Dodge Charger to transfer to another government entity – Oelrichs Fire Department for training purposes.

Motion made by Russell, seconded by Allen, to approve setting the hearing for 2023-2024 Retail (on-off sale) Malt Beverage and SD Farm Wine Licenses, May 4, 2023, at 9:30 a.m.

Motion made by Russell, seconded by Cope, to accept the petitions for Long's Lakeview Road District and set the election date for May 2, 2023.

The Board received notification from the P.E.O. Chapter M of a raffle to sell tickets to raise funds for women's education.

Motion made by Allen, seconded by Cope, to approve the following resolution:

Fall River County Resolution #2023-16

Whereas, the Fall River County Board of Commissioners have designated April 6th, 2023 as a day to honor Charles Dobbs, Fall River County Deputy Sheriff, for his life saving actions.

Whereas, Deputy Dobbs was courageous and his life saving actions on March 18th, 2023 helped to avert a possible drowning at the Cold Brook Recreation Area; and

Whereas, Deputy Dobbs put himself in harms way to save another human life with dedication and courage; and

Whereas, the Fall River County Board of Commissioners would like to express sincere appreciation for the service Deputy Dobbs rendered unto Fall River County; and

Now, therefore, be it resolved that the Fall River Board of County Commissioners calls upon all citizens of Fall River County to observe April 6th, 2023, in recognition of the service of Deputy Dobbs, who by his devotion to duties, had rendered invaluable service to the County.

Dated this 6th day of April, 2023.

/s/Joe Falkenburg, Chairman
Fall River County Commission

ATTEST:

/s/Sue Ganje, Auditor
Fall River County

Tracy Bastian, City of Hot Springs, met with the Board. Motion made by Russell, seconded by Allen, to approve the request for proposed easement for the existing sewer line that is on a tax deed property in Hot Springs, contingent on State's Attorney Russell's review.

Greenough joined the meeting at 10:10 a.m.

Isnalawica Belt, Deputy, met with the Board. Motion made by Russell, seconded by Allen, to approve the Sig Sauer Quote for firearms, in the amount of \$10,968.56.

Motion made by Greenough, seconded by Allen, to approve travel for Deputy Belt to attend Axon Taser Instructor Training, Madison, SD, May 19, 2023, in the amount of \$495.00.

Motion made by Allen, seconded by Russell, to approve hiring Brandon Petersen, Deputy, \$24.50 per hour, effective May 1, 2023.

Discussion was held on receiving a grant in the amount of \$5,062.36 for assistance in building a secure interview room. The Sheriff's department would like to split the 24/7 room in half to complete this project.

Frank Maynard, Emergency Management, met with the Board. Motion made by Cope, seconded by Russell, to approve the L.E.M.P.G single signature form and authorize the chairman to sign.

Motion made by Greenough, seconded by Allen, to approve travel for Gary Baker to attend EM101 on June 15, 2023, that was rescheduled due to weather.

The tornado drill was completed on March 20th and the After Action Report meeting was held on March 29th, 2023. Emergency Management will complete the necessary paperwork and send it to the local agencies that participated.

Motion made by Greenough, seconded by Russell, to surplus to junk the following items:

- #1669 Dell Computer Dimension 9100
- #1780 SYX Computer Tower
- #1936 HP Pro 3500
- #1942 ASUS Computer
- #1483 Gateway Computer E4100
- #1779 Dell Vostro 200 Computer
- #1771 Toshiba Laptop Computer
- #2020 Dell Computer Optiplex 3010
- #1781 Dell Vostro 200 Computer
- #1807 Lenovo Computer Think Center
- #1938 HP Computer Pro
- #1771 Toshiba Laptop Computer

Discussion was held on the SCBA Air Compressor. Motion made by Allen to donate \$1,000.00 to the Hot Springs Fire Department for the SCBA Air Compressor. Motion died for lack of a second. The Board asked that Maynard have someone from the Hot Springs Fire Department attend the next meeting to provide further information.

Maynard also reported on fires and incidents.

Jackie Waldner, Community Health Nurse, met with the Board. Motion made by Russell, seconded by Greenough, to approve hiring Chrissy Porter, \$15.50 per hour, effective April 3, 2023, as per union contract.

Lance Russell, State's Attorney, met with the Board. Motion made by Allen, seconded by Greenough, to approve travel for Russell and Lynn Two Bear to attend the Sexual Violence Institute, April 12 and April 13, 2023, in Spearfish.

Motion made by Greenough, seconded by Russell, to approve travel for Russell to attend the State's Attorney's Conference, May 3 through May 5, 2023, in Deadwood.

Lily Heidebrink, Director of Equalization, met with the Board. Motion made by Russell, seconded by Greenough, to approve having Sam Kipp start Assessor online classes.

Motion made by Greenough, seconded by Russell, to approve travel for Heidebrink, Frances Denison, Carlee Weishaupl-Freitag and Sam Kipp to attend the SDAAO Conference, June 12 through June 16, 2023, in Sioux Falls and for Carlee Weishaupl-Freitag and Sam Kipp to attend USPAP, July 12 and July 13, 2023, in Pierre.

Motion made by Cope, seconded by Greenough, to approve hiring Jonathan Harris, \$15.00 per hour, effective April 10, 2023.

Heidebrink reported to the Board that there were 140 calls for appeals this year; in 2022 there were 100 calls. They are projecting that there will be 26 to 38 people that will appear before the Board to appeal.

Heidebrink reminded the Board of the May 2, 2023 deadline to have them finished by. Further discussion was held on things that can or cannot be done according to state guidelines and lack of interest from legislators to find solutions.

Sue Ganje, Auditor, reported to the Board about the annual report for 2022. Discussion was held about cash and expenditures. The Board advised being careful about putting extra money in the building fund; Ganje stated that they could ask her any more questions in the future about the report.

Ganje also reported that by participating in the Teva, Allergan, CVS, Walgreens and Walmart opioids settlement the county received \$11,335.47 for 2022 and \$11,913.03 for 2023 from the Janssen Settlement.

Dustin Ross and John McBride, Andersen Engineers met with the Board. Motion made by Allen, seconded by Russell, to approve the following resolution:

FALL RIVER COUNTY RESOLUTION #2023-17

A Plat of Lot 28 of Shep's Canyon Estates Subdivision, located in the NW1/4NE1/4 of Section 27, T8S, R5E, BHM, Fall River County, South Dakota

WHEREAS, there has been presented to the County Commissioners of Fall River County, South Dakota, the within plat of the above described lands, and it appearing to this Board that the system of streets conforms to the system of streets of existing plats and section lines of the county; adequate provision is made for access to adjacent unplatted lands by public dedication or section line when physically accessible; all provisions of the county subdivision regulations have been complied with; all taxes and special assessments upon the property have been fully paid; and the plat and survey have been lawfully executed; now and therefore,

BE IT RESOLVED that said plat is hereby approved in all respects.

Dated this 6th day of April, 2023.

/s/Joe Falkenburg, Chairman
Fall River County Board of Commissioners

ATTEST:
/s/Sue Ganje
Fall River County Auditor

Motion made by Russell, seconded by Allen, to approve the following resolution:

FALL RIVER COUNTY RESOLUTION #2023-18

A Plat of Lots 1 thru 4 of Hot Springs Mountain Vista Subdivision, located in the E1/2 of Government Lot 1 of Section 18, T7S, R6E, BHM, Fall River County, South Dakota

WHEREAS, there has been presented to the County Commissioners of Fall River County, South Dakota, the within plat of the above described lands, and it appearing to this Board that the system of streets conforms to the system of streets of existing plats and section lines of the county; adequate provision is made for access to adjacent unplatted lands by public dedication or section line when physically accessible;

all provisions of the county subdivision regulations have been complied with; all taxes and special assessments upon the property have been fully paid; and the plat and survey have been lawfully executed; now and therefore,

BE IT RESOLVED that said plat is hereby approved in all respects.

Dated this 6th day of April, 2023.

/s/Joe Falkenburg, Chairman
Fall River County Board of Commissioners

ATTEST:

/s/Sue Ganje
Fall River County Auditor

Randy Seiler, Highway Superintendent, met with the Board. Motion made by Greenough, seconded by Allen, to approve Golden West Application for permit to Occupy County Highway Right-of-Way, 11601 Rocky Ford Road, Project Number 54694-T23126.

Motion made by Greenough, seconded by Allen, to approve the 3 Fall River Water User’s Applications for Permit to Occupy County Highway Right-of-Way as follows:

- From the top of Hill Road to the bottom of Hill Road
- From the east side of Howl Road to the end of Oak Tree Road
- From House Boat Drive to Feeder Way

Seiler updated the Board that the DOT is starting condemnation on 1 landowner regarding the Igloo Bridge; the State is hopeful to have bid letting in November for the Bridge. Discussion was held on the most recent storm and snow removal; some individuals hires private contractors to help.

Motion made by Greenough, seconded by Allen, to approve the bills as follows:

GENERAL FUND

ACTION MECHANICAL INC	PART	\$273.03
AMERICAN FAMILY ASSURANCE	AMERICAN FAMILY ASSURANCE	\$689.34
AMAZON CAPITAL SERVICES	SUPPLY	\$651.41
CURA HOSPITALITY	INMATE FOOD/SUPPLY	\$9,718.50
BOB BARKER COMPANY INC	INMATE SUPPLIES	\$1,222.51
BELT, SYDNEY	MILEAGE	\$25.50
BLACK HILLS CHEMICAL	SUPPLY	\$825.28
BQ & ASSOCIATES, P.C.,LLO	GARNISHMENT	\$131.00
BOMGAARS SUPPLY	SUPPLY	\$39.99
BOSTON MUTUAL LIFE INS CO	LIFE INSURANCE	\$32.76
COLBATH & SPERLICH, PC	CAAF/MAG/JUVENILE	\$5,416.40
CREDIT COLLECTION BUREAU	COLLECTIONS	\$1,703.05
DELTA DENTAL PLAN OF SD	DELTA DENTAL	\$2,598.38
DIV OF CHILD SUPPORT	CHILD SUPPORT	\$437.50
EFTPS	EFTPS PAYROLL TAXES	\$39,967.99

EXECUTIVE MGMT FINANCE	BIT NETWORK FEES	\$52.75
GOLDEN WEST TECHNOLOGIES	SERVICE/NETWORK/SERVER	\$8,910.99
HEAVY HIGHWAY FRINGE	INSURANCE FEES	\$540.00
HILLS EDGE AUTO SALES	SERVICE	\$85.18
HOT SPRINGS ACE HARDWARE	SUPPLY	\$223.85
CITY OF HOT SPRINGS	1ST QTR FIRE SPRINKLER	\$24.00
HUSTEAD LAW OFFICE, P.C.	CAAF	\$2,584.49
IDEMIA IDENTITY & SECURITY	SOFTWARE MAINTENANCE	\$2,356.00
IOWA LABORERS DISTRICT	HEALTH INSURANCE	\$24,827.00
LIUNA LABORERS LOCAL 620	UNION DUES	\$270.00
LIGHT & SIREN	EQUIPMENT INSTALLATION	\$15,598.60
LYNN'S DAK. MART PHARMACY	INMATE PHARMACY	\$686.65
MARCO	COPIER LEASE	\$154.38
MASTERCARD	COUNTY CREDIT CARD	\$1,383.89
MONUMENT HEALTH	INMATE MEDICAL	\$55.49
NATIONWIDE RETIREMENT SOL	NATIONWIDE RETIREMENT	\$700.00
NEW YORK LIFE INSURANCE	NEW YORK LIFE INSURANCE	\$65.00
NORTON, TINA	CONTRACT NURSE INMATE	\$1,625.00
O'DAY, VALARIE	COURT REPORTER	\$203.25
CHILD SUPPORT PAYMENT CNT	CHILD SUPPORT	\$655.00
O'NEILL, JUSTIN	CAAF	\$490.38
ONSITE FIRST AID, LLC	FIRST AID SUPPLY	\$304.73
OTIS ELEVATOR COMPANY	SERVICE CONTRACT	\$467.16
QUILL CORPORATION	OFFICE SUPPLIES	\$18.99
RELIANCE STANDARD LIFE	VISION PLAN	\$341.32
RUSHMORE COMMUNICATIONS	REPAIRS	\$328.60
RUSSELL, LANCE	TRAVEL REIMBURSEMENT	\$29.68
SOUTH DAKOTA ST TREASURER	SALES TAX	\$54.27
SD RETIREMENT SYSTEM	SDRS CONTRIBUTION	\$20,354.79
SD SECRETARY OF STATE	VOTER LIST	\$20.00
SERVALL	RUG SERVICE	\$733.77
SIG SAUER INC.	SUPPLY	\$1,216.00
SOFTWARE SERVICES INC	SOFTWARE SERVICES	\$330.00
SONNY'S SUPER FOODS	SUPPLY	\$64.44
SOUTHERN HILLS AVIATION	AIRPLANE ANNUAL INSPECTION	\$2,289.08
SOUTHERN HILLS LAW PLLC	CAAF	\$2,681.00
STURDEVANT'S AUTO VALUE	PARTS/SUPPLY	\$60.80
TREASURER - EXPENSES	TREASURER	\$27.52
VANGUARD APPRAISALS INC	SERVICE	\$175.00
VERIZON WIRELESS	CELL PHONE PLAN	\$722.89
THOMSON REUTERS	ONLINE LAW SUBSCRIPTION	\$148.00
MRAZ, JENNIFER	MILEAGE	\$38.25
MILES, SASHA	BLOOD DRAW	\$75.00
COMMISSIONERS	MARCH SALARIES	\$4,350.00
AUDITOR'S OFFICE	MARCH SALARIES	\$20,816.79
AUDITOR'S OFFICE	OVERTIME	\$146.80

TREASURER'S OFFICE	MARCH SALARIES	\$15,874.24
TREASURER'S OFFICE	OVERTIME	\$458.46
STATE'S ATTORNEY'S OFFICE	MARCH SALARIES	\$15,504.82
STATE'S ATTORNEY'S OFFICE	OVERTIME	\$483.15
MAINTENANCE	MARCH SALARIES	\$10,295.36
MAINTENANCE	OVERTIME	\$113.43
ASSESSOR'S OFFICE	MARCH SALARIES	\$15,230.00
ASSESSOR'S OFFICE	OVERTIME	\$5.81
REGISTER OF DEEDS OFFICE	MARCH SALARIES	\$12,032.59
REGISTER OF DEEDS OFFICE	OVERTIME	\$60.99
VETERAN'S SERVICE OFFICE	MARCH SALARIES	\$4,540.03
GIS OFFICE	MARCH SALARIES	\$4,536.82
SHERIFF	MARCH SALARIES	\$28,418.49
SHERIFF	OVERTIME	\$3,555.88
JAIL	MARCH SALARIES	\$25,700.59
JAIL	OVERTIME	\$3,455.94
CORONER	MARCH SALARIES	\$900.00
NURSE'S OFFICE	MARCH SALARIES	\$1,368.00
NURSE'S OFFICE	OVERTIME	\$57.94
EXTENSION OFFICE	MARCH SALARIES	\$1,867.75
WEED & PEST OFFICE	MARCH SALARIES	\$4,723.42
	TOTAL FOR GENERAL FUND	\$330,203.13

COUNTY ROAD & BRIDGE

A & B WELDING SUPPLY CO.	WELDING SUPPLIES/LEASE	\$120.88
AMERICAN FAMILY ASSURANCE	AMERICAN FAMILY ASSURANCE	\$365.50
BLACK HILLS ELECTRIC	UTILITY	\$79.53
BOMGAARS	SUPPLY	\$183.94
BUTLER MACHINERY CO.	SUPPLIES/REPAIRS	\$2,454.37
COSTA, SAMUEL	REIMBURSEMENT SUPPLY	\$10.63
CREDIT COLLECTION BUREAU	COLLECTIONS	\$161.90
CITY OF EDGEMONT	CITY OF EDGEMONT WATER	\$87.40
DELTA DENTAL PLAN OF SD	DELTA DENTAL	\$630.20
FLOYD'S TRUCK CENTER	REPAIRS/PARTS	\$47.42
EFTPS	EFTPS PAYROLL TAXES	\$11,667.96
EXPRESS COLLECTIONS, INC.	GARNISHMENT	\$399.50
EXPRESS COLLECTIONS, INC.	WRONG AMOUNT	\$-263.32
FORWARD DISTRIBUTING	SUPPLIES/PARTS	\$48.90
GODFREY BRAKE SERVICE	SUPPLY	\$356.22
GOLDEN WEST TECHNOLOGIES	SERVICE/NETWORK/SERV	\$8.25
HEAVY HIGHWAY FRINGE	INSURANCE FEES	\$180.00
HILLS EDGE AUTO SALES	SERVICE	\$134.38
SIMON CONTRACTORS OF SD	GRAVEL	\$49,595.00
HOT SPRINGS ACE HARDWARE	SUPPLY	\$72.82
IOWA LABORERS DISTRICT	HEALTH INSURANCE	\$7,303.00
LIUNA LABORERS LOCAL 620	UNION DUES	\$270.00
MASTERCARD	COUNTY CREDIT CARD	\$122.38

MIDCONTINENT TESTING, INC	TESTING	\$468.00
NEWMAN SIGNS INC.	SIGNAGE	\$230.86
ONSITE FIRST AID, LLC	FIRST AID SUPPLY	\$55.85
POMP'S TIRE SERVICE INC.	PARTS	\$1,152.98
RELIANCE STANDARD LIFE	VISION PLAN	\$65.00
RAPID DELIVERY	DELIVERY	\$16.90
SAFETY-KLEEN SYSTEMS, INC	SUPPLIES	\$124.47
SD RETIREMENT SYSTEM	SDRS CONTRIBUTION	\$5,904.22
SEILER, RANDY	CELLPHONE REIMBURSEMENT	\$75.00
SD SUPPLEMENT RETIREMENT	SUPPLEMENTAL RETIREMENT	\$40.00
STURDEVANT'S AUTO VALUE	PARTS/SUPPLY	\$1,096.85
THE LODGE AT DEADWOOD	LODGING HIGHWAY CONFERENCE	\$208.00
WILSON ELECTRIC	SERVICE	\$235.47
STOVER, CRISPEEN	REFUND	\$127.14
HIGHWAY DEPARTMENT	MARCH SALARIES	\$47,728.97
HIGHWAY DEPARTMENT	OVERTIME	\$1,472.75
	TOTAL COUNTY ROAD & BRIDGE	\$133,039.32
911 SURCHARGE REIMBURSEMENT		
AMERICAN FAMILY ASSURANCE	AMERICAN FAMILY ASSURANCE	\$67.21
CREDIT COLLECTION BUREAU	COLLECTIONS	\$302.86
DELTA DENTAL PLAN OF SD	DELTA DENTAL	\$317.54
EFTPS	EFTPS PAYROLL TAXES	\$5,058.38
GOLDEN WEST TECHNOLOGIES	SERVICE/NETWORK/SERVER	\$24.75
HEAVY HIGHWAY FRINGE	INSURANCE FEES	\$60.00
IOWA LABORERS DISTRICT	HEALTH INSURANCE	\$2,486.50
LIUNA LABORERS LOCAL 620	UNION DUES	\$27.00
MASTERCARD	COUNTY CREDIT CARD	\$44.99
RELIANCE STANDARD LIFE	VISION PLAN	\$7.48
SD RETIREMENT SYSTEM	SDRS CONTRIBUTION	\$2,560.37
VERIZON WIRELESS	CELL PHONE PLAN	\$41.83
DISPATCH	MARCH SALARIES	\$16,173.34
DISPATCH	OVERTIME	\$5,086.11
	TOTAL FOR 911 SURCHARGE REIMBURSEMENT	\$32,258.36
EMERGENCY MANAGEMENT		
AMAZON CAPITAL SERVICES	SUPPLY	\$110.98
EFTPS	EFTPS PAYROLL TAXES	\$1,878.78
GOLDEN WEST TECHNOLOGIES	SERVICE/NETWORK/SERVER	\$16.50
MARCO	COPIER LEASE	\$77.18
MASTERCARD	COUNTY CREDIT CARD	\$18.00
SD DEPT OF REV & REG.	NEW PLATES	\$16.70
SD RETIREMENT SYSTEM	SDRS CONTRIBUTION	\$669.62
VERIZON WIRELESS	CELL PHONE PLAN	\$155.48
FR EMERGENCY MANAGEMENT OFFICE	MARCH SALARIES	\$7,087.22
	TOTAL FOR EMERGENCY MANAGEMENT	\$10,030.46
24/7 SOBRIETY FUND		
EFTPS	EFTPS PAYROLL TAXES	\$307.20

24/7 OFFICE	MARCH SALARIES	\$2,008.00
	TOTAL FOR 24/7 SOBRIETY FUND	\$2,315.20
	TOTAL PAID BETWEEN 3/17/23 AND 4/6/23	\$507,846.50

Break was taken at 10:50 a.m. and the meeting reconvened at 10:59 a.m.

Heath Greenough, Commissioner, reported to the Board about the possibility of creating templates for job descriptions and evaluations; he would like to have a good working relationship with department heads.

Public comment was heard from Commissioner Falkenburg about the Forest Service wanting to ban the fire retardant that planes release during an emergency; he is hopeful that this doesn't go through and wondered if Commissioner Cope could address it if possible. Additional comments were heard from Highway Superintendent Seiler about the Volkswagen program now is at 35%, instead of 50% for assistance with trucks. The Board asked that Seiler look at anything that may need to be replaced in the future since this program could still be of some assistance. Seiler also stated that Covid monies can be used for matching funds on bridges now and that he had left the County Road Map with the State.

Further discussion was held on job descriptions and evaluations. Auditor Ganje will check codified laws to see if this could be done on elected officials or not, as well as which appointed ones could be evaluated. State's Attorney Russell wouldn't mind having feedback and getting together on a yearly basis to keep the lines of communication open. More information will be available at the next meeting.

Les Cope, Commissioner, reported to the Board about still having a lack of the representation at the State level. Discussion was held on the possibility of the County starting a lawsuit with the State. State's Attorney Russell advised that Senator Frye-Mueller had gotten her voting rights back, but no committee appointments; he will write a letter to send to the president of the house and the senate.

Motion made by Russell, seconded by Allen, to enter into executive session as per SDCL 1-25-2 (3) for legal purposes at 11:30 a.m.

The meeting resumed at 12:04 p.m.

Motion made by Greenough, seconded by Russell, to adjourn at 12:06 p.m.

/s/Joe Falkenburg
 Joe Falkenburg, Chairman
 Board of Fall River County Commissioners

ATTEST:
/s/Sue Ganje, Auditor
 Fall River County Auditor's Office



AUDITOR'S ACCOUNT WITH THE COUNTY TREASURER

TO THE HONORABLE BOARD OF FALL RIVER COUNTY COMMISSIONERS:

I hereby submit the following report of my examination of the cash and cash items in the hands of the County Treasurer of this County on this 31st day of March 2023.

Total Amount of Deposit in First Interstate Bank, HS:	\$ 591,830.40
Total Amount of Cash:	\$ 2,570.93
Total Amount of Treasurer's Change Fund:	\$ 900.00
Total Amount of Checks in Treasurer's Possession Not Exceeding Three Days:	\$ 70,200.05
SAVINGS:	
#4) First Interstate Bank, HS:	\$ 1,646,184.45
CERTIFICATES OF DEPOSIT:	
#8) Black Hills Federal Credit Union, HS:	\$ 250,000.00
#14) Schwab Treasury:	\$ 1,006,991.68
#15) First National Bank, Lead:	\$ 318,473.31
#21) Schwab Treasury 2 Yr:	\$ 268,400.31
#22) Schwab Treasury 2 Yr:	\$ 978,147.66
#23) Schwab Treasury 2 Yr:	\$ 977,187.50
#24) Schwab Treasury 2 Yr:	\$ 2,035,781.25
#25) Schwab Treasury 3 Yr:	\$ 2,010,421.88
#26) Schwab Treasury 4 Yr:	\$ 1,027,563.75

Itemized list of all items, checks and drafts that have been in the Treasurer's possession over three days:

Register of Deeds Change Fund:	\$ 500.00
Highway Petty Cash:	\$ 20.00
Election Petty Cash:	\$ 15.00

RETURNED CHECKS:

Hannah Thomas	\$ 426.01
---------------	-----------

TOTAL \$ 11,185,614.18

Dated This 31st Day of March 2023.

Sue Ganje, County Auditor of Fall River County

Teresa Pullen, County Treasurer of Fall River County

County Monies	\$ 10,175,168.54
Held for other Entities	\$ 727,954.78
Held in Trust	\$ 282,490.86
TOTAL	\$ 11,185,614.18

The Above Balance Reflects County Monies, Monies Held in Trust, and Monies Collected for and to be remitted to Other ENTITIES: SCHOOLS, TOWNS, AND STATE.



*Emergency Management
Fall River County*

*Franklin W. Maynard CEM CFM
906 N. River St.
Hot Springs, SD 57747*

605 745-7562 605 890-7245 em@frcounty.org



Date: April 25, 2023

Subj: Commission Update

1. **Travel Approval:** Request approval for Gary Baker to attend the Points of Dispensing (POD) conference on May 9th, 2023 at Cedar Shores. Every county is required to have an updated POD plan and conduct an annual exercise (table top or functional) annually.
2. **Marty Property, Evans Street:** Stu Marty would like to sell the lot on Evans Street. The county owns the lots on either side of his lot. The lot is located in the Cold Brook channel restoration area and is in the flood plain. Stu is asking \$5,000 for the lot. I recommend the county purchase the lot.
3. **SCBA Air Compressor:** The compressor unit is \$26,000 complete. The Hot Springs Fire Dept. has agreed that all departments within Fall River County could utilize the unit by bringing their bottles to the Hot Springs department to be filled.
4. **Statewide Regional Emergency Operations Center (EOC) Exercise:** Gary Baker attended the exercise held in Rapid City on April 11th & 12th.
5. **Flood Plain Management Training:** Frank Maynard attend the one day training in Rapid City on April 17th.
6. **Fires & Incidents:** None

Franklin W. Maynard, CEM, CFM
Emergency Manager
Fall River County
906 N. River Street
Hot Springs, SD 57747

FALL RIVER
COUNTY

MARTY,
STU

T007S
ROSE

Fall River

W.U. GERMOND'S
COLD BROOK
ADDN

FALL RIVER
COUNTY

MAY 9 2023



South Dakota Statewide Points of Dispensing Annual Conference

SAVE THE DATE!

9 am to 4 pm lunch will be served

TUESDAY, MAY 9, 2023

Location:

Arrowwood at Cedar Shores
1500 Shoreline Dr, Oacoma, SD 57365

Who Should Attend?

Those that are involved in their
community POD

Come meet fellow POD members, state and federal
partners, and learn more about the mission and future
direction of points of dispensing in South Dakota!



2727 N Plaza Dr.
Rapid City, SD 57702

Phone 605-348-6529 Fax 605-342-1160

Quote

No.: **69645**

Date: 4/4/2023

Prepared for:

Dave Weishaupl
Fall River County Highway Supt
27518 Cascade Road
Hot Springs, SD 57747 USA

Account No.: 1740
Phone: (605) 745-5137
Fax: (605) 745-5912

Qty	Description	UOM	Sell	Total
1	SonicWALL Advanced Gateway Security Suite Bundle for TZ500 Series - 1yr For serial number 18B169B36D30. Current services expire on May 21st, 2023.	EA	\$1,114.07	\$1,114.07

Your Price:
\$1,114.07

Total:
\$1,114.07

Prices are valid for 30 days from quote date.

Prepared by: Chris Bernard, chrisbernard@goldenwest.com

Date: 4/4/2023

Accepted by: _____ **Date:** _____

Disclaimer

Unless otherwise specified, all labor is charged on a time and materials basis. Any additional service charge or travel will apply. Any quoted cable runs assume that there is an available cable pathway; if not, additional charges may apply. Applicable taxes and/or shipping charges may be added to the invoice.
Terms: A 30% down payment may be required for sales of \$10,000 or more, with the balance due 15 days from the invoice date. Large, long-term projects are subject to progress billing.

FAXED BID: 605-745-4188

EMAILED BID:

TO: FALL RIVER COUNTY HIGHWAY DEPT. FAX # 745-5912

PHONE # 745-5137

DATE: 4/10/2023

FROM: NELSON'S

PHONE: 605-745-4189

BID: PROPANE 1000G (WEST)TANK HOT SPRINGS SHOP - 0%

PROPANE 1000G (EAST) TANK HOT SPRINGS SHOP -- 50%

AMOUNT OF BID:

\$ 1.99 Per gal.

(This bid includes all appropriate taxes and fees)

Signed By:

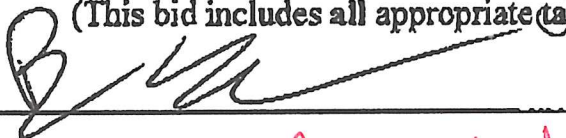

Awarded

Note: all faxed bids must be received in the Fall River County Highway Dept. office at the above number before 10:00 A.M. to be considered, unless otherwise stated by the caller for bids.

If declining to bid please write the words; "Decline todays bid." On the line designated for the Bid Amount.

Thank You

**FAXED BID:
EMAILED BID: HI-D-WAY@GWTC.NET**

**TO: FALL RIVER COUNTY HIGHWAY DEPT. FAX # 745-5912
PHONE # 745-5137**

DATE: 4/10/2023

FROM: HI-D-WAY PHONE: 605-662-5000

**BID: PROPANE 1000G (WEST)TANK HOT SPRINGS SHOP - 0%
PROPANE 1000G (EAST) TANK HOT SPRINGS SHOP - 50%**

AMOUNT OF BID: \$ 2.29
(This bid includes all appropriate taxes and fees)

Signed By: 

Note: all faxed bids must be received in the Fall River County Highway Dept. office at the above number before 10:00 A.M. to be considered, unless otherwise stated by the caller for bids.

If declining to bid please write the words; "Decline todays bid." On the line designated for the Bid Amount.

Thank You

**FAXED BID:
EMAILED BID:**

**TO: FALL RIVER COUNTY HIGHWAY DEPT. FAX # 745-5912
PHONE # 745-5137**

DATE: 4/10/2023

FROM: DAKOTA PROPANE PHONE:605-745-5959

**BID: PROPANE 1000G (WEST)TANK HOT SPRINGS SHOP - 0%
PROPANE 1000G (EAST) TANK HOT SPRINGS SHOP – 50%**

AMOUNT OF BID: NO BID
(This bid includes all appropriate taxes and fees)

Signed By: _____

Note: all faxed bids must be received in the Fall River County Highway Dept. office at the above number before 10:00 A.M. to be considered, unless otherwise stated by the caller for bids.

If declining to bid please write the words; “Decline todays bid.” On the line designated for the Bid Amount.

Thank You

AMENDMENT NUMBER 2
AGREEMENT NUMBER 910984

BACKGROUND:

1. On June 8, 2015, the State of South Dakota, acting by and through its Department of Transportation, referred to in this Amendment as the "STATE," and Fall River County, South Dakota, referred to in this Amendment as the "COUNTY," entered into an Agreement, which was signed by representatives of each party and assigned agreement number 910984 by the STATE. The parties executed an amendment to said agreement which was dated June 1, 2017. Said agreement, as amended, will be referred to in this Amendment as the "AGREEMENT".
2. Due to delays in the PROJECT and cost increases the parties wish to further amend the terms of the AGREEMENT.

THE PARTIES MUTUALLY AGREE AS FOLLOWS:

1. Paragraph A.10 of the AGREEMENT is amended to read as follows:

The STATE will pay any outside contractors, suppliers, and vendors directly for PROJECT costs. PROJECT costs include all work deemed necessary by the STATE to complete the PROJECT, including work performed by the STATE and work that is not particularly enumerated in sections A.1. through A.9., such as environmental assessment and mitigation, relocation reimbursements paid to utilities, and real property title work and acquisition. Notwithstanding the preceding sentence, the COUNTY will be solely responsible for the cost of negotiating needed utility adjustments and issuing certifications as set forth in Section B.2. of this Agreement.

2. Background Paragraph 4 and Paragraph B.4. of the AGREEMENT are deleted.
3. Except as specifically modified by this Amendment, all terms and conditions of the original AGREEMENT referred to above, together with any prior amendments to such AGREEMENT, will remain in full force and effect.

The COUNTY has designated its County Commission Chairperson as the COUNTY'S authorized representative and has empowered the Chairperson with the authority to sign this Agreement on behalf of the COUNTY. A copy of the COUNTY'S Commission minutes or resolution authorizing the execution of this Agreement by the Chairperson as the COUNTY'S authorized representative is attached to this Agreement as **Exhibit A**.

This Amendment is binding upon the signatories not as individuals, but solely in their capacities as officials of their respective organizations and acknowledges proper action of the STATE and the COUNTY to enter into the same.

Signatures on following page

Fall River County, South Dakota

By: _____

Printed Name: _____

Its: County Commission Chairperson

Date: _____

Attest:

By: _____

Printed Name: _____

County Auditor/Clerk

(COUNTY SEAL)

State of South Dakota
Department of Transportation

By: _____

Printed Name: _____

Its: Department Secretary

Date: _____

Approved as to Form:

By: /s/ Karla L. Engle

Printed Name: Karla L. Engle

Special Assistant Attorney General

0vi9

AGREEMENT NUMBER 910984

AN AGREEMENT BETWEEN THE STATE OF SOUTH DAKOTA,
DEPARTMENT OF TRANSPORTATION AND FALL RIVER COUNTY
TO BUILD A NEW ROAD BETWEEN PROVO AND IGLOO

This Agreement is made and entered into by and between the State of South Dakota, acting by and through its Department of Transportation, referred to in this Agreement as the "STATE," and Fall River County, South Dakota, referred to in this Agreement as the "COUNTY."

BACKGROUND:

1. The parties previously entered into an agreement entitled, "An Agreement for Improvement of State Trunk Highway 298 from SD47 Approximately 1.2 Miles Southwest," which agreement was entered into by the parties on July 1, 1997, and assigned agreement number 711255 by the STATE, referred to in this Agreement as "AGREEMENT NUMBER 711255." Section A.5. of AGREEMENT NUMBER 711255 required the STATE to replace the structure over the Burlington Northern Railroad (Structure Number 24-102-188). Rather than replace the structure over the Burlington Northern Railroad (Structure Number 24-102-188), as required under AGREEMENT NUMBER 711255, as well as replace the structure over Coal Creek (Structure Number 24-103-188), the parties agree it is more economical to construct a different route into the town of Igloo, South Dakota.
2. The STATE and the COUNTY want to construct a public highway located on a new alignment from SD Highway 471 (SD471) at Provo west and northwest to town of Igloo, approximately 2.0 miles, referred to in this Agreement as the "PROJECT." The Project Number is P 0043(00) PCN 049U. The total cost of the PROJECT is estimated to be \$950,000.
3. The PROJECT work will include but not be limited to design and construction engineering, environmental coordination, grading, drainage structures, gravel surfacing, and right of way acquisition for the new alignment. The PROJECT will also involve the removal of the two existing structures, Structure Numbers 24-102-188 and 24-103-188 as well as obliteration of approximately 1.17 miles of Fort Igloo Road from SD471 to the gate of Fort Igloo.
4. The STATE will provide a maximum of One Million, One Hundred Thousand Dollars (\$1,100,000.00), in STATE funds towards the cost of the PROJECT, which represents the estimated replacement cost of Structure Number 24-102-188 over the railroad on Fort Igloo Road, based on estimates made in 2013. The STATE, at the STATE'S discretion may re-evaluate and adjust the STATE'S contribution towards the cost of the PROJECT at the time the PROJECT is expected to be let to bids (approximately 2018).

THE STATE AND THE COUNTY MUTUALLY AGREE AS FOLLOWS:

A. The STATE:

1. The STATE will develop the Scope of Services for the design of the PROJECT in conjunction with the COUNTY.
2. The STATE will provide technical assistance for the PROJECT and review plans and specifications.
3. The STATE will purchase right-of-way and any necessary relocation for the PROJECT. The STATE will purchase, per the STATE'S construction plans, the right-of-way for the PROJECT in the name of the COUNTY.
4. If negotiations are unsuccessful in securing the property interests necessary for the PROJECT, the STATE will negotiate and acquire those property interests in the name of the STATE and will

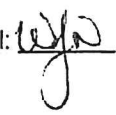
DOT Legal: 

handle the condemnation of any right of way and temporary easements. Upon completion of the construction and approval of the South Dakota Transportation Commission, the STATE will transfer to the COUNTY the parcel or parcels acquired by condemnation.

5. The STATE will provide the construction plans, specifications, and estimates for the COUNTY'S review and approval prior to advertising the PROJECT for bids.
6. The STATE will advertise, let to contract, award, and be the contracting party for the PROJECT.
7. The STATE will obtain the COUNTY'S concurrence before authorizing any changes to the PROJECT work under the STATE approved PROJECT plans and specifications.
8. The STATE will obliterate approximately 1.17 miles of Fort Igloo Road from SD471 to the gate of Fort Igloo Road as part of the PROJECT.
9. Rather than replace the structure over the Burlington Northern Railroad (Structure Number 24-102-188, as required under AGREEMENT NUMBER 711255, and the structure over Coal Creek (Structure Number 24-103-188), the STATE will construct a public highway located on a new alignment from SD Highway 471 (SD471) at Provo west and northwest to the town of Igloo, approximately 2.0 miles.
10. The STATE will provide payment directly to contractors, suppliers, and vendors. The STATE will bill the COUNTY for any costs exceeding One Million, One Hundred Thousand Dollars (\$1,100,000.00).

B. The COUNTY will:

1. The COUNTY will concur with the design of the PROJECT to ensure the design meets the COUNTY'S needs.
2. The COUNTY will arrange for all needed utility adjustments and certify that all utility adjustments or agreements are in place prior to the STATE'S advertisement and letting of the PROJECT.
3. The COUNTY will accept full ownership, jurisdiction, and maintenance responsibilities of the PROJECT.
4. The COUNTY will be one hundred percent (100%) responsible for any costs exceeding One Million, One Hundred Thousand Dollars (\$1,100,000). The COUNTY will pay the STATE upon receipt of billing from the STATE.
5. The COUNTY will continue to maintain the PROJECT as a public road after construction of the PROJECT.

C. General Conditions:

1. This Agreement may not be amended, except in writing, which writing will be expressly identified as a part of this Agreement, and be signed by an authorized representative of each of the parties.
2. The STATE may terminate this Agreement on thirty (30) days' written notice. If the COUNTY breaches any term or condition of this Agreement, the STATE may terminate this Agreement at any time with or without notice.
3. This Agreement depends upon the continued availability of appropriated funds and expenditure authority from the Legislature for this purpose. If for any reason the Legislature fails to appropriate funds or grant expenditure authority, or funds become unavailable by operation of law

or federal funds reductions, the STATE may terminate this Agreement. Termination for any of these reasons is not a default by the STATE nor does it give rise to a claim against the STATE.

4. **Authority to Sign Right of Way and Easement Documents:** The COUNTY has designated its County Commission Chairperson as the COUNTY'S authorized representative and has empowered its County Commission Chairperson with the authority to negotiate and approve of acquisition of right of way for the purpose of road and bridge construction in COUNTY'S jurisdiction. A copy of the COUNTY'S Commission minutes or resolution authorizing said authority is attached to this Agreement as Exhibit A.

5. **Authority to Sign Agreement with the STATE.** The COUNTY has designated its County Commission Chairperson as the COUNTY'S authorized representative and has empowered its County Commission Chairperson with the authority to sign this Agreement on behalf of the COUNTY. A copy of the COUNTY'S Commission minutes or resolution authorizing the execution of this Agreement by the County Commission Chairperson is attached to this Agreement as Exhibit B.

This Agreement is binding upon the signatories not as individuals but solely in their capacities as officials of their respective organizations and acknowledges proper action of the STATE and the COUNTY to enter into the same.

Fall River County, South Dakota

By: Deborah Russell

Its: County Commission Chairperson

Date: 5/19/15

Attest

[Signature]

County Auditor/Clerk

(COUNTY SEAL)

State of South Dakota
Department of Transportation

By: [Signature]

Its: Secretary

Date: 6/8/15

By: [Signature]

Its: Program Manager,
Office of Administration

Date: 6/5/15

Approved as to Form:

[Signature]
Special Assistant Attorney General

FALL RIVER COUNTY MINUTES OF MAY 19, 2015

The Fall River Board of County Commissioners met in regular session on May 19, 2015 in the courtroom of the Courthouse. Present: Joe Allen, Anne Cassens, Joe Falkenburg, Deb Russell and Sue Ganje, Auditor. Absent: Michael Ortner.

An invocation and the Pledge of Allegiance were given; the meeting called to order at 9:00 AM. The agenda was reviewed for conflicts; none were noted. Motion by Cassens, seconded by Falkenburg, to approve the agenda as written. With no further discussion and all voting yes, the motion carried.

Motion by Cassens, seconded by Falkenburg, to approve a wage increase per Union contract for appraiser Frances Denison to \$13.00 per hour, effective 4/29/15. With no further discussion and all voting yes, the motion carried.

Motion by Falkenburg, seconded by Cassens, to approve a wage increase per Union contract for for Richard Kraima to \$10.50 per hour, effective 5/21/15. With no further discussion and all voting yes, the motion carried.

Motion by Falkenburg, seconded by Allen, to surplus as junk a Dell CPU, #01517, from the Auditor; a Dell CPU, #01817, from the Treasurer; and a Dell Vostro 220 from Dispatch. With no further discussion and all voting yes, the motion carried.

Motion by Cassens, seconded by Falkenburg, to surplus five light bars to sell to other entities; surplus as scrap salvage two vehicle cages; and surplus to sell a lowband radio antenna and four vehicle battery chargers, all from the Sheriff's Office; a surge protector, #00740, from the Auditor; a Scanjet Scanner, #1503, a Fellowes shredder, #1933, an HP Officejet 6000, no asset #, all from the Dept. of Equalization; and a graphics tablet, #1829, and three phones, all from Emergency Management. With no further discussion and all voting yes, the motion carried.

Motion by Falkenburg, seconded by Cassens, to accept, with regrets and thanks for her service, the resignation of dispatcher Jennifer Mraz, effective May 19, 2015, unless part-time status can be agreed on between Mraz and Sheriff Evans. With no further discussion and all voting yes, the motion carried.

Motion by Falkenburg, seconded by Allen, to set June 2, 2015 as the time to appoint a commissioner to fill the remainder of Commissioner Cassens' term of office, which will be vacant June 1 due to her resignation. With no further discussion and all voting yes, the motion carried.

Motion by Falkenburg, seconded by Cassens, to approve the April, 2015 Auditor's account with the Treasurer as follows. The Board also asked that a letter from the County Treasurer be given to the State's Attorney when she receives a returned check. With no further discussion and all voting yes, the motion carried.

AUDITOR'S ACCOUNT WITH THE COUNTY TREASURER
TO THE HONORABLE BOARD OF COUNTY COMMISSIONERS OF FALL RIVER COUNTY:

AMENDMENT NUMBER 1 AGREEMENT NUMBER 910984

This AMENDMENT, dated this 1st day of June, 2017, is by and between the State of South Dakota, acting by and through its Department of Transportation, referred to as the "STATE" and Fall River County, referred to as the "COUNTY".

BACKGROUND

Effective June 8, 2015, the STATE and the COUNTY entered into an agreement, which is referred to in this AMENDMENT as the "AGREEMENT," and which was assigned Agreement Number 910984 by the DEPARTMENT. The parties wish to amend the terms of the AGREEMENT.

It is mutually agreed between the STATE and the COUNTY that paragraph A.10. of the AGREEMENT is amended as follows:

10. The STATE will pay any outside contractors, suppliers, and vendors directly for PROJECT costs. The STATE's share of the PROJECT costs, in the maximum amount of \$1,100,000.00, will be applied first. If the STATE's share is exhausted, the STATE will bill the COUNTY for all PROJECT costs exceeding the STATE's maximum share. PROJECT costs include all work deemed necessary by the STATE to complete the PROJECT, including work performed by the STATE and work that is not particularly enumerated in Sections A.1. through A.9., such as environmental assessment and mitigation, relocation reimbursements paid to utilities, and real property title work and acquisition. Notwithstanding the preceding sentence, the COUNTY will be solely responsible for the cost of negotiating needed utility adjustments and issuing certifications as set forth in Section B.2. of this Agreement.

Except as modified by this AMENDMENT, the terms and conditions of the original AGREEMENT will remain in full force and effect.

The COUNTY has designated its County Commission Chairperson as the COUNTY'S authorized representative and has empowered its County Commission Chairperson with the authority to sign this AMENDMENT on behalf of the COUNTY. A copy of the COUNTY'S Commission minutes or resolution authorizing the execution of this AMENDMENT by the County Commission Chairperson is attached to this AMENDMENT as EXHIBIT 1.

FALL RIVER COUNTY

STATE OF SOUTH DAKOTA
DEPARTMENT OF TRANSPORTATION

By: 
County Commission Chair

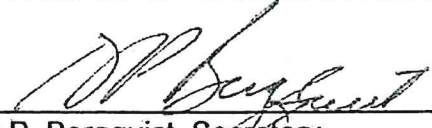
By: 
Darin P. Bergquist, Secretary

Date: 6-20-17

Date: 7/18/17

Approved as to form:

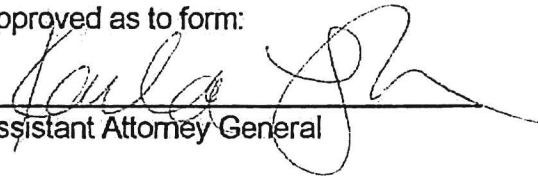
Assistant Attorney General

FROM DATE: 03/01/2023

FALL RIVER COUNTY HIGHWAY DEPT

CREATE DATE: 04/04/2023

TO DATE: 03/31/2023

UNPAID ACCOUNTS RECEIVABLES BY FUND

PAGE: 1 OF 1

FUND	RECODE	RECNAME	AMOUNT
701 INVENTORY ITEMS	CHFUEL	COURT HOUSE FUEL	232.71
	CITY F	CITY OF HS/ FUEL/GAS	1,402.54
	COUNTY	SHERIFFS DEPARTMENT FUEL	2,757.92
	WEED	WEED DEPT	108.67
	FUND TOTALS		4,501.84

HOT SPRINGS, SOUTH DAKOTA 57747

FALL RIVER COUNTY, SOUTH DAKOTA

Name of Claimant: Fall River County Highway Department
P.O. Box 939
Hot Springs, S.D. 57747

Date: 4/4/2023
WEED BOARD FUEL PURCHASES:
FROM DATE: 3/01/2023
THROUGH DATE: 3/31/2023
GALLONS: 31.10
TOTAL: \$108.67

HOT SPRINGS, SOUTH DAKOTA 57747
FALL RIVER COUNTY, SOUTH DAKOTA

Name of Claimant: Fall River County Highway Department
P.O. Box 939
Hot Springs, S.D. 57747

Date: 4/4/2023
SHERIFF'S DEPARTMENT GAS PURCHASES:
FROM DATE: 3/1/2023
THROUGH DATE: 3/31/2023
TOTAL GALLONS: 789.30
TOTAL: \$2757.92

HOT SPRINGS, SOUTH DAKOTA 57747

FALL RIVER COUNTY, SOUTH DAKOTA

Name of Claimant: Fall River County Highway Department

P.O. Box 939

Hot Springs, S.D. 57747

Date: 4/4/2023
COURT HOUSE ...FUEL/GAS PURCHASES: (All Departments)
FROM DATE: 3/01/2023
THROUGH DATE: 3/31/2023
GALLONS: 66.60
TOTAL: \$232.71

**FALL RIVER COUNTY HIGHWAY DEPARTMENT
APPROACH PERMIT
APPLICATION FOR ROAD APPROACH PERMIT**

On this date April 17, 2023, the Applicant hereby applies to the Fall River County Highway Department for permission to construct an approach road connection to the West side of (road name) Coffee Flats Road (road #) 8 approximately at 3.0 miles south of US 18 intersection. The road approach will serve a oil/gas well location and will be (residence, church, business, etc.)

constructed between August 1, 2023 and August 31, 2023 at (beginning date) (completion date) at

applicant's expense.

Applicant acknowledges that approach and culverts shall meet County specifications, which are on file at the County Highway Department. Please attach a drawing or sketch showing the proposed location of the approach and set stakes in the ground to enable the Superintendent/Foreman to locate the proposed approach.

Name: GULF EXPLORATION, LLC Address: 9701 North Broadway Extension
Oklahoma City, Oklahoma 73114

Phone #: 307-473-1268 Signed: Robert M. Anderson
[Signature]
--(Property Owner)--

Authorized Agent for Gulf Exploration, LLC

TO BE COMPLETED BY FALL RIVER COUNTY HIGHWAY DEPARTMENT

Permit #: _____
MO/DY/YR

PRELIMINARY INSPECTION: Date _____ By: _____

Culvert Diameter _____ Culvert Length _____

The crown of the presently traveled surface, including shoulder, to be continued at a distance of 20 feet from the nearest edge of the traveled surface of the road-shoulder facing the property.

Remarks: _____

PERMIT: _____ APPROVED _____ DENIED _____

Date: _____
Superintendent/Foreman

GULF EXPLORATION, LLC

AVALANCHE #1-16

PROPOSED ACCESS ROAD

LOCATED IN: SEC. 16, T9S, R1E, B.H.M.
FALL RIVER COUNTY, SOUTH DAKOTA

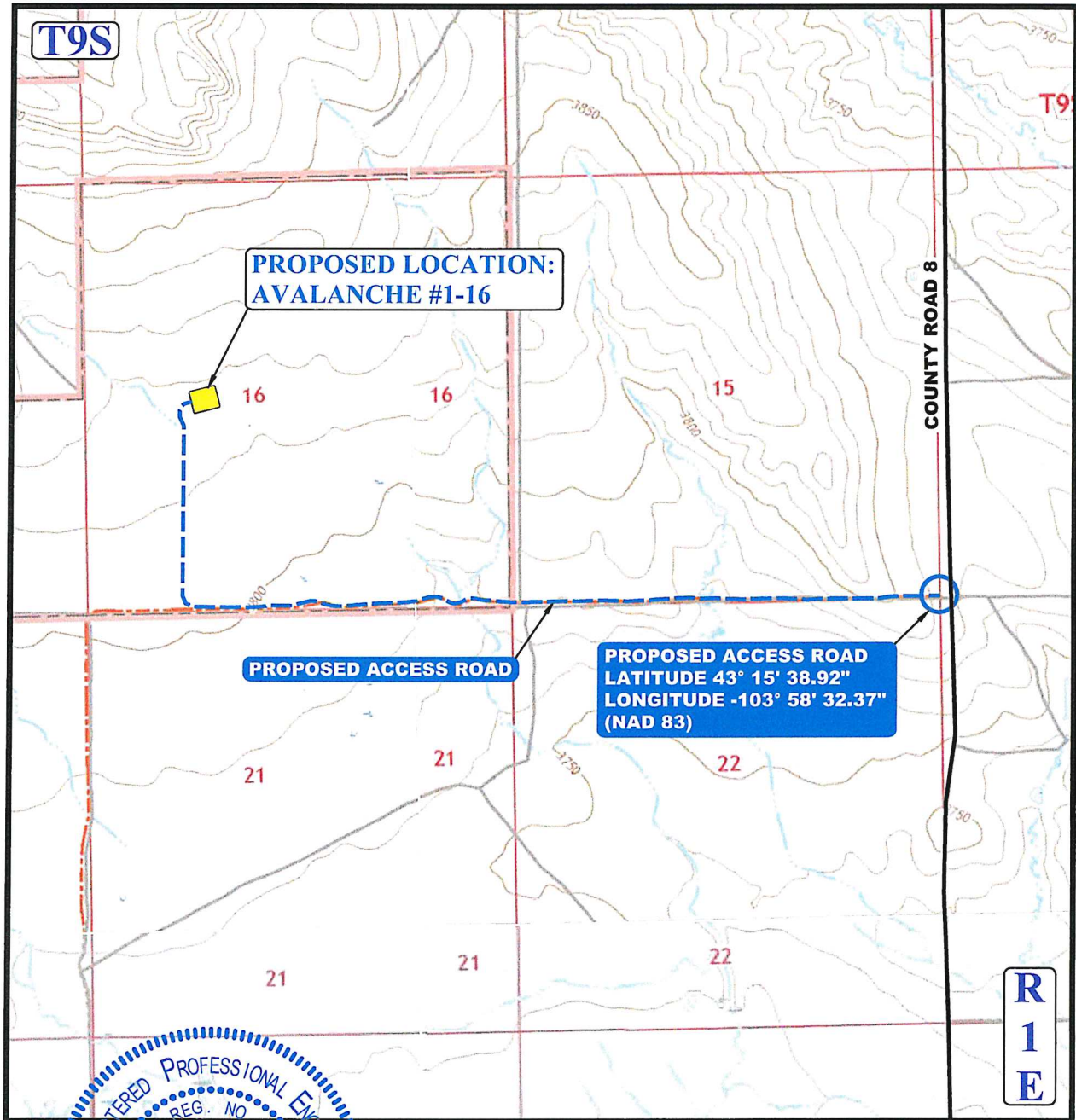

REGISTERED PROFESSIONAL ENGINEER
REG. NO. 9736
HAROLD NELSON MARSHALL
SOUTH DAKOTA
Harold Marshall
RESPONSIBLE ENGINEER

CONTENTS	
GENERAL NOTES.....	1
GEOMETRIC STANDARDS.....	2
CULVERT INSTALLATION DETAILS.....	3
TRAFFIC CONTROL PLANS.....	T1-2
PLAN & PROFILE.....	P1



UELS, LLC
Corporate Office * 85 South 200 East
Vernal, UT 84078 * (435) 789-1017

DRAWN BY	A.T.	03-24-23	SCALE
			1" = 2,000'
ACCESS ROAD			COVER

All materials for construction of the complete project including but not limited to rip-rap, water for dust control and compaction, culverts, bedding materials for culverts, surface course gravel, signs, etc. are to be provided by the contractor at his bid price unless other arrangements are made.

Construction of the approach from the county road must conform to current AASHTO and Fall River County standards. An access permit must be obtained for this approach prior to beginning construction. During construction, the contractor will follow all signing and flagging requirements as stated in the Manual of Uniform Traffic Control Devices latest edition.

Uintah Engineering and Land Surveying assumes no liability written or implied as to the location of pipelines or cable lines in the vicinity of this road design. South Dakota 811 (public lines) and or the owner of the transportation line (Private/Corporate lines) must be contacted for identification and location before construction begins. Transportation lines that may be identified on these plans may not be the only transportation lines in the vicinity of the road. These plans are not intended to be used to identify the location of transportation lines. Extreme caution shall be used when constructing road near or over transportation lines.

EXPLANATIONS:

PLAN & PROFILE SHEETS

Plan & Profile sheets show the horizontal and vertical alignment of the road, sign placement if any, turnout placement if any, estimated culvert placements and sizes, estimated wing ditches, horizontal and vertical curve data, and the percent super for construction of horizontal curves.

SCOPE OF WORK:

SHAPING THE ROADWAY

The roadway is to be shaped to the dimensions shown on the typical cross section included in this document. Care shall be given to insure that the travel-way width is not less or significantly more than the dimensions given on the typical cross section. Where turnouts are indicated, the typical section widths shown on the typical cross section will need to be modified by the amounts shown on the typical turn-out. Where there are horizontal curves, super-elevations will be constructed to the percentages shown on the plan and profile sheets. One-third of the super transition occurs on the curve and two-thirds on the tangent.

Top soil will be handled in the manner agreed upon and stated within the APD and the conditions of approval. If top soil is to be moved; Top soil will be peeled back during construction. Some over-excavation of cut slopes and bar ditches will provide needed material for road construction. Top soil will then be spread back over the cut and fill slopes and bar ditches.

The road shall have a crown as shown on the typical cross section to insure that water will drain off of the travel-way surface.



GEOMETRIC SPECIFICATIONS

GRAVEL SPECIFICATION:

3" minus pit run gravel (AASHTO M145-49 A-1-a Soil)

Do not place gravel on road until Inspector/Engineer has approved the sub-grade.

Place gravel to full widened width on turnouts, curve widening, and intersection flares.

TYPICAL CROSS SECTIONS

(for Proposed Access Road)

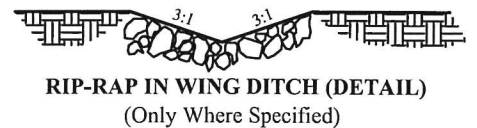
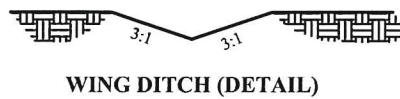
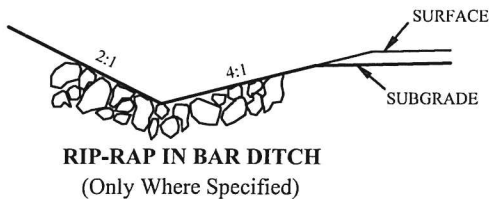
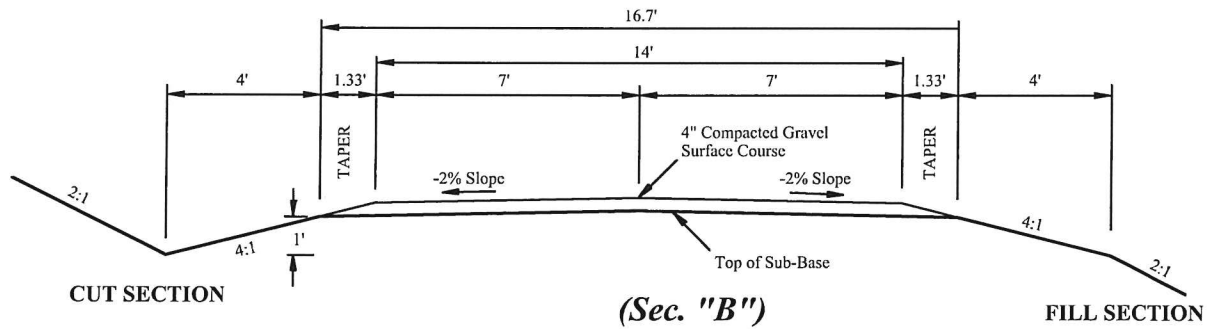
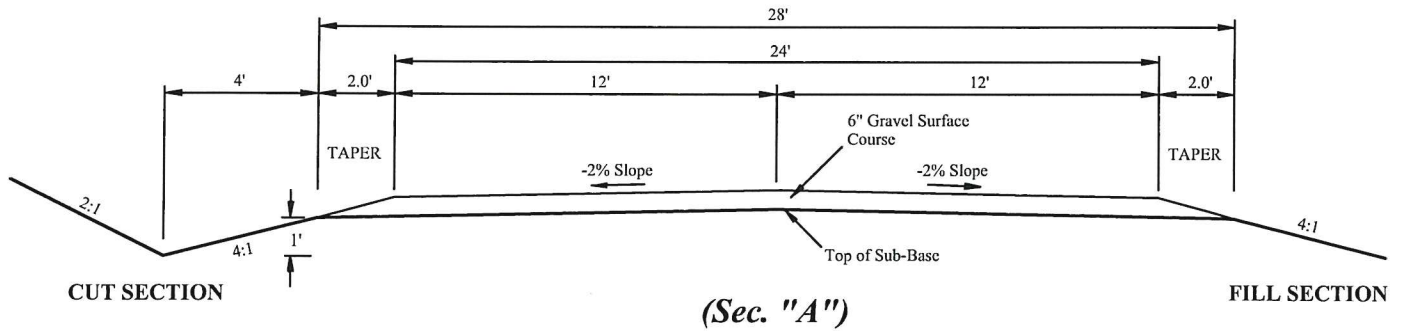

THE PLANS SHOW AN ESTIMATE OF THE NUMBER AND THE SIZE OF THE CULVERTS TO BE PLACED ON THE ROAD. THERE MAY NEED TO BE SOME FIELD ADJUSTMENTS MADE BY THE CONTRACTOR, BLM, AND/OR INSPECTOR/ENGINEER TO THE PLACEMENT AND LENGTH OF THE CULVERTS AND WING DITCHES.

CULVERT INGRESS AND EGRESS DITCH LENGTHS ARE TO BE DETERMINED DURING CONSTRUCTION. ALL DITCHES ARE TO BE CONSTRUCTED WITH SUFFICIENT SLOPE SO THAT WATER WILL EXIT THE DOWNSTREAM SIDE AND NOT POND IN THE DITCH.

ALL CULVERTS SHALL BE OF SUFFICIENT STRENGTH TO SUPPORT AN HS-20 LOADING OR HEAVIER. CHECK WITH MANUFACTURER FOR INFORMATION ABOUT MINIMUM COVER AND LOAD RATINGS. IN NO CASE SHALL COVER OVER CULVERTS BE LESS THAN 1'. CULVERT LENGTHS ARE ESTIMATED ON THE PLANS BUT THERE MAY NEED TO BE SOME ADJUSTMENTS MADE TO THE LENGTHS OF THE CULVERTS DURING CONSTRUCTION.

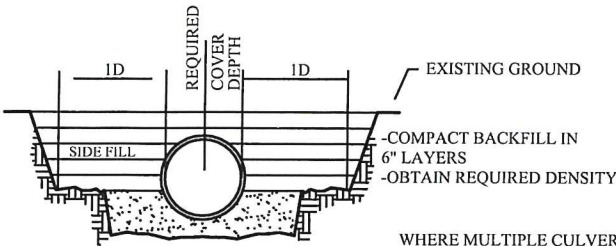

BACKFILL DETAIL

IN LIVE FISH BEARING STREAMS
LOWER BOTTOM OF CULVERT 6"
BELOW NATURAL CHANNEL SURFACE

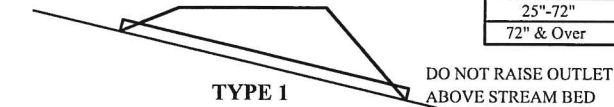

TYPE 1

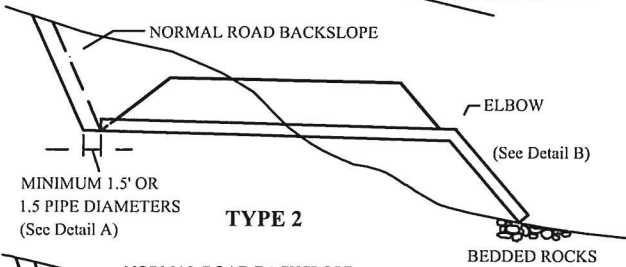

TYPE 2

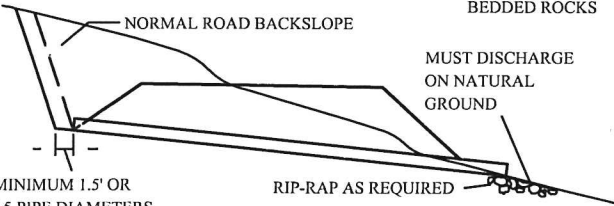

TYPE 3

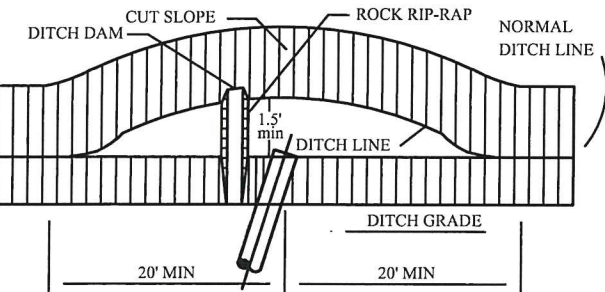

CATCH BASIN PLAN VIEW (TYPES 2 AND 3)
(DITCH DAM ONLY TYPE 1)

DETAIL A

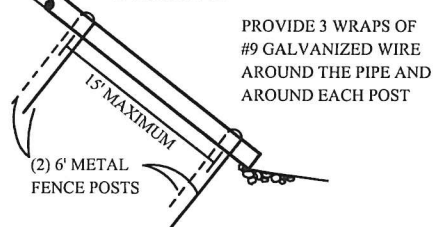

SPECIAL ANCHORING TYPE 2 DOWNDRAINS
DETAIL B

WHERE MULTIPLE CULVERTS ARE SPECIFIED ON THE PLANS, THERE SHALL BE NO LESS THAN THE FOLLOWING CLEARANCE BETWEEN THE CULVERTS.

PIPE DIAM.-D	CLEARANCE
0"-24"	12"
25"-48"	1/2 Pipe Diam.
49"-72"	36"

RIP-RAP WILL BE PLACED AT ALL CULVERT INLETS AND OUTLETS AND ALSO, WHERE SPECIFIED ON THE PLAN & PROFILE SHEETS. RIP-RAP WILL BE SIZED DEPENDENT UPON PIPE DIAMETER AS SHOWN. RIP-RAP SHALL BE WELL GRADED WITH A SUFFICIENT AMOUNT OF SMALLER STONES UNIFORMLY DISTRIBUTED THROUGHOUT.

PIPE DIAM.-D	RIP-RAP SIZE	L	M	YARDAGE
0"-24"	60% shall be 8" in diameter or larger	5'	12"	±1 cyds
25"-48"	60% shall be 12" in diameter or larger	10'	18"	±6 cyds
49"-72"	60% shall be 18" in diameter or larger	15'	24"	±19 cyds

*Larger than 72", consult engineer.

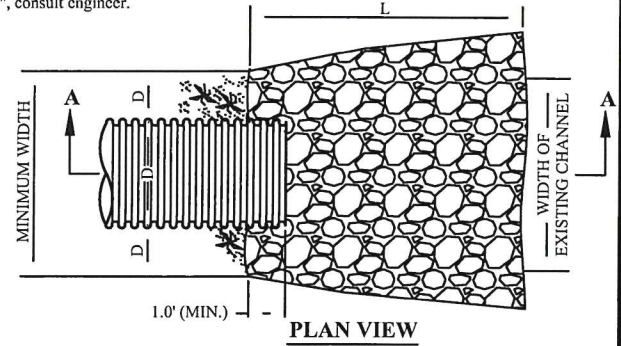

PLAN VIEW

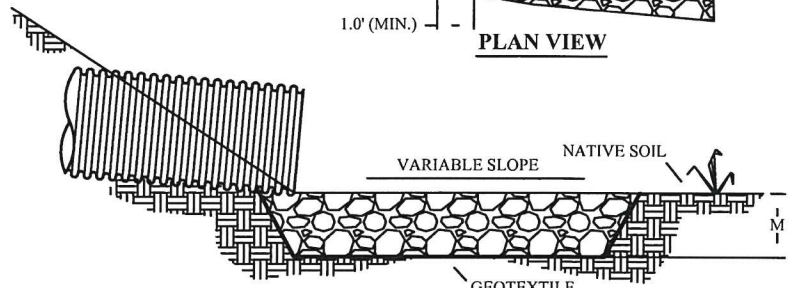

SECTION A-A

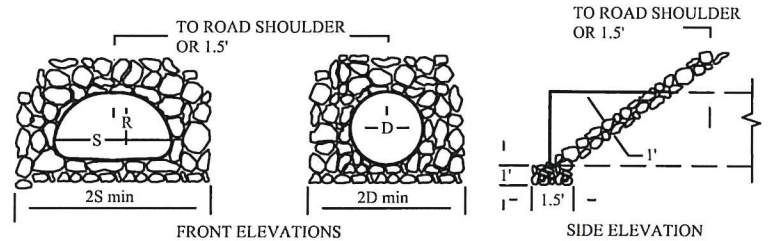

FRONT ELEVATIONS

SIDE ELEVATION

IN NARROW CHANNELS ADJUST RIP-RAP TO FIT ORIGINAL STREAM BANKS.

RIP-RAP DETAILS

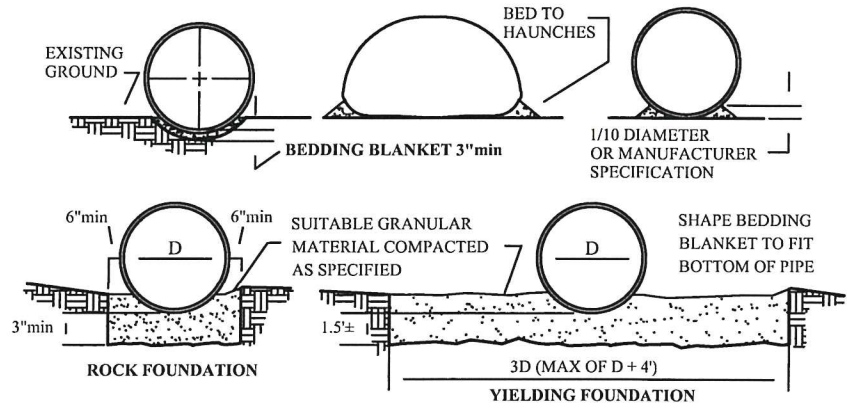

BEDDING DETAILS

WORK WITHIN TRAVELWAY - LOW TRAFFIC VOLUME

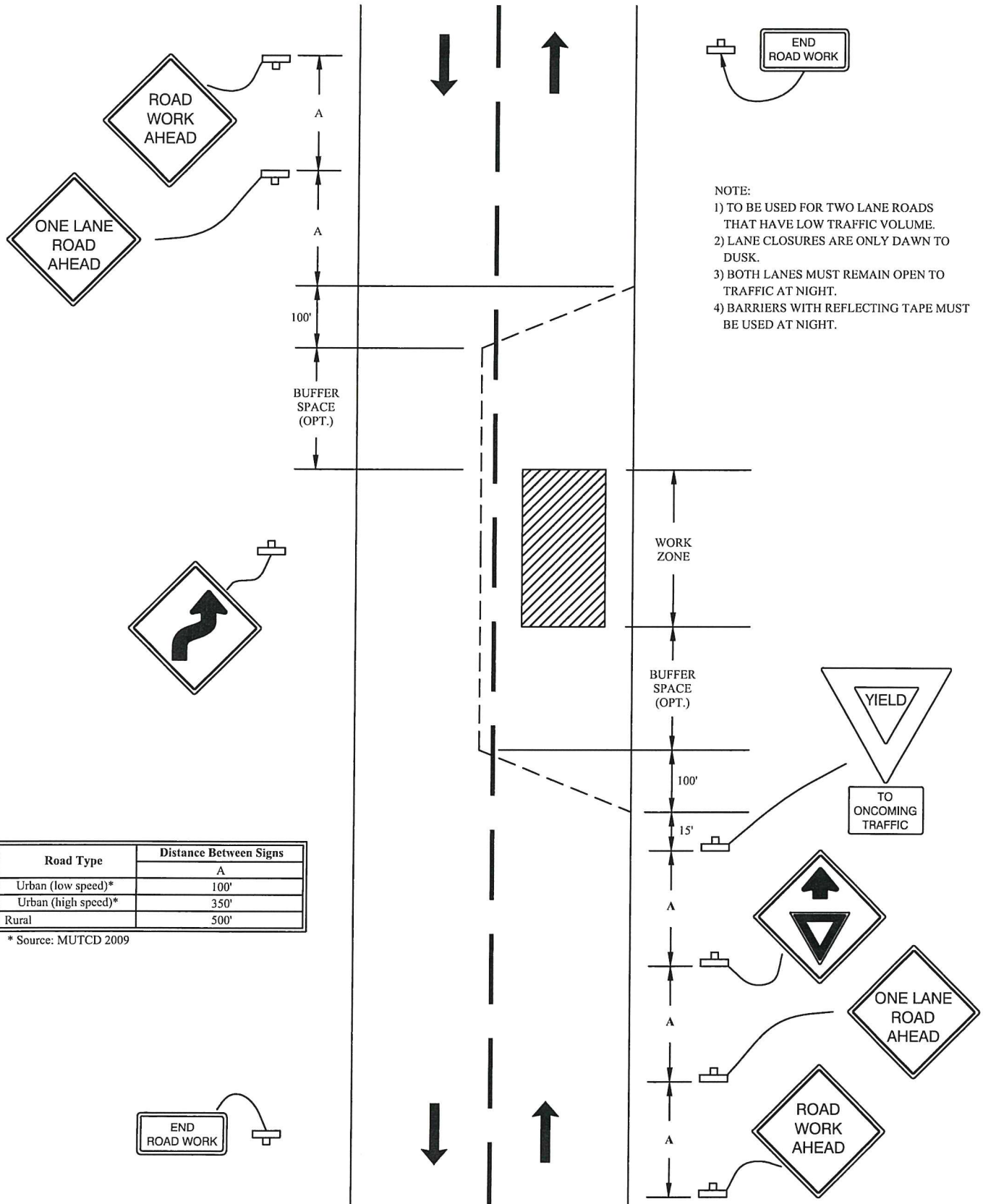

Road Type	Distance Between Signs
	A
Urban (low speed)*	100'
Urban (high speed)*	350'
Rural	500'

* Source: MUTCD 2009

WORK BEYOND THE SHOULDER - WITHIN RIGHT-OF-WAY

Road Type	Distance Between Signs
	A
Urban (low speed)*	100'
Urban (high speed)*	350'
Rural	500'

* Source: MUTCD 2009



NOTE:
1) TO BE USED WHEN WORKING BEYOND THE SHOULDER.

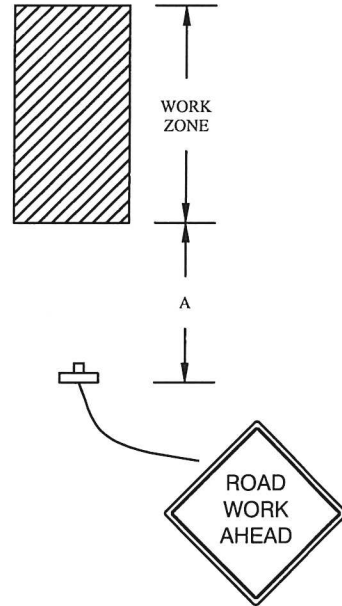

GULF EXPLORATION, LLC
AVALANCHE #1-16
(PROPOSED ROAD ACCESS)
PLAN & PROFILE
SEC. 15 & 22, T9S, R1E, B.H.M.
FALL RIVER COUNTY, SOUTH DAKOTA
DATE: 03-24-23 BY: A.T.
REV.: 04-17-23 (A.T.)

BASIS OF BEARINGS IS THE EAST LINE OF SECTION 15, T9S, R1E, B.H.M. WHICH WAS ASSUMED TO BEAR N00°52'18"W FOR 5283.66'.
 NOTE:
 1. BEGIN PROFILE STATION 0+00 BEARS S89°02'28"W, 13.14' FROM THE SOUTHEAST CORNER OF SECTION 15, T9S, R1E, B.H.M.
 2. END PROFILE STATION 4+00 BEARS S89°02'28"W, 413.14' FROM THE SOUTHEAST CORNER OF SECTION 15, T9S, R1E, B.H.M.
 3. USE EXTREME CAUTION WHEN CONSTRUCTING APPROACH NEAR EXISTING FIBER OPTIC LINE. EXISTING FIBER OPTIC LINE MIGHT NEED TO BE BURIED DEEPER. CONTACT UTILITY OWNER FOR SPECIFICATIONS.

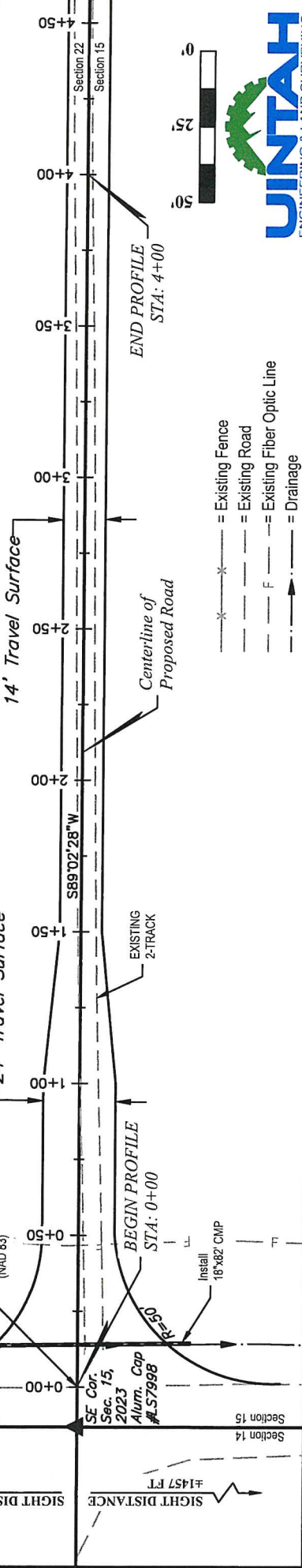

GRADE %	-2.0	+4.0
TYP. SECTION	"A"	"B"
	TRANSITION	

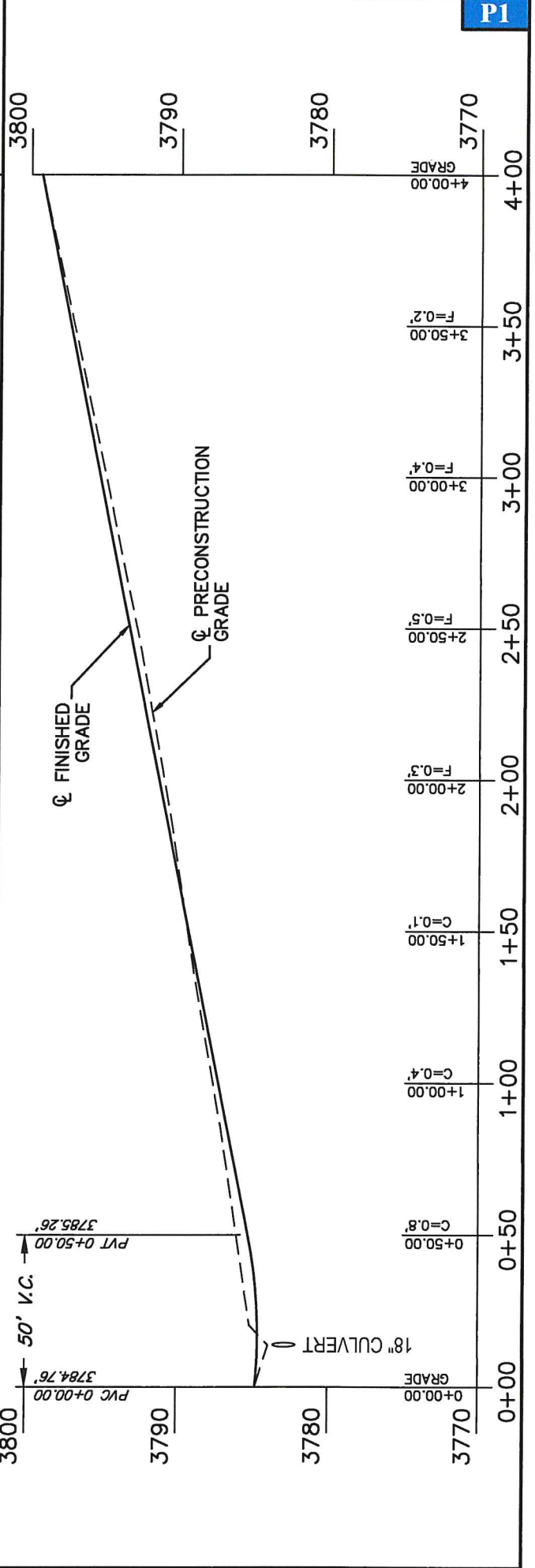

**FALL RIVER COUNTY HIGHWAY DEPARTMENT
APPROACH PERMIT
APPLICATION FOR ROAD APPROACH PERMIT**

On this date March 31, 2023, the Applicant hereby applies to the Fall River County Highway Department for permission to construct an approach road connection to the West side of (road name) Coffee Flats Road (road #) 8 approximately at 0.2 miles south of US 18 intersection. The road approach will serve a oil/gas well location and will be (residence, church, business, etc.) constructed between April 15, 2023 (est) and May 15, 2023 (est) at (beginning date) (completion date)

applicant's expense.

Applicant acknowledges that approach and culverts shall meet County specifications, which are on file at the County Highway Department. Please attach a drawing or sketch showing the proposed location of the approach and set stakes in the ground to enable the Superintendent/Foreman to locate the proposed approach.

Name: GULF EXPLORATION, LLC Address: 9701 North Broadway Extension Oklahoma City, Oklahoma 73114

Phone #: 307-473-1268 Signed: Robert M. Anderson

~~(Property Owner)~~

Authorized Agent for Gulf Exploration, LLC

TO BE COMPLETED BY FALL RIVER COUNTY HIGHWAY DEPARTMENT

Permit #: 4 17 23
MO/DY/YR

PRELIMINARY INSPECTION: Date 4-17-23 By: Randy Seiler

Culvert Diameter 18" Culvert Length 62'

The crown of the presently traveled surface, including shoulder, to be continued at a distance of 20 feet from the nearest edge of the traveled surface of the road-shoulder facing the property.

Remarks: _____

PERMIT: ✓ APPROVED _____ DENIED _____

Randy Seiler Date: 4-17-23
Superintendent/Foreman

FALL RIVER COUNTY HIGHWAY DEPARTMENT
 SPECIFICATIONS FOR COUNTY ROADS AND APPROACHES

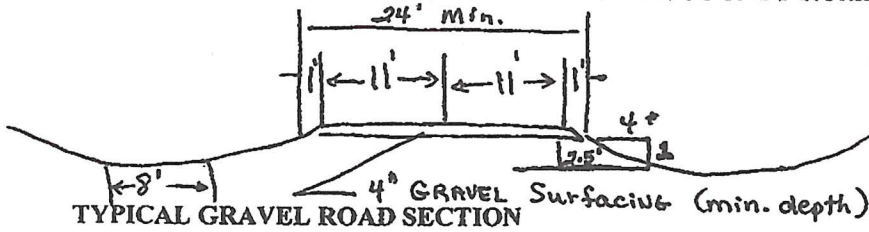

* Maximum slope is 4 to 1 (current Standard of the South Dakota DOT Steeper slopes are subject to the Approval of Fall River County

The above Typical Road Section and Typical Approach Detail (below) shall be followed in the construction of roads to be placed on the County Road System. Road design shall be consistent with published Standards of the American Association of State Highway Transportation Officials. Road construction materials and methods shall conform to the current published edition the "Standard Specifications for Roads and Bridges" of the South Dakota Department of Transportation, when referenced in the Standards below. Copy of these Specifications is on file at the County Highway Department Office.

The following are standards which shall be met:

1. Maximum Grade of any road or portion of road shall not exceed ten percent (10%)
2. Maximum Degree of Curvature shall not exceed twenty one degrees (21 degrees)
3. Crown rates shall be between 0.02 11/11 to 0.06 11/11. Maximum Super elevation rate in curves shall be 0.07 11/11.
4. Culverts shall be sized to assure proper drainage. The minimum size of culvert shall be eighteen inches (18") in diameter. Although fifteen inch (15") diameter will be allowed under certain conditions.
5. Gravel Surfacing shall meet the requirements of Part B of the Standard Specifications.
6. Asphalt and Concrete construction methods and materials shall meet the requirements of Part C and Part D of the "Standard Specifications".
7. All Dead-End Roads shall have Cul-De-Sacs with a minimum constructed radius of fifty feet (50').
8. Approaches shall be constructed perpendicular as practical to the County Road.
9. The Minimum dedicated Right-Of-Way width shall be sixty six feet (66').

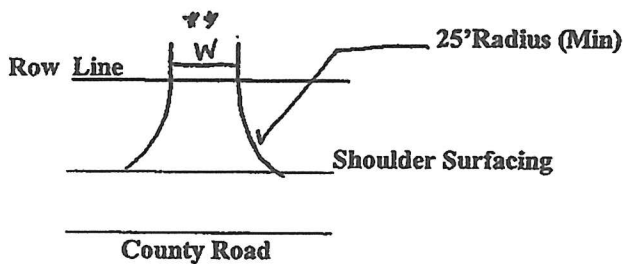

W Is Surface Width at Right-Of-Way line
 W - 16' Min. for Single Residences
 W - 20' Min for Multiple Residences
 W - 28' Min. for Commercial

Maximum W - 50'

TYPICAL APPROACH DETAIL

1. Only one approach shall be allowed to each tract or parcel of land.
2. Existing roadway drainage will be maintained. Culverts shall be sized to assure proper drainage. The maximum size of culvert shall be eighteen Inches (18") in diameter, although fifteen Inch (15") diameter will be allowed under certain conditions. The minimum length of approach culvert shall be thirty-two feet (32')
3. Sight distance of approaches shall meet published Standards of the American Association of State Highway Transportation Officials.

APPROVED By:

(Chairman) FALL RIVER COUNTY COMMISSIONERS

DATE

RECOMMENDED BY:

Randy Seiler
 FALL RIVER COUNTY HIGHWAY SUPERINTENDENT

4-17-23

DATE

GULF EXPLORATION, LLC

ENIGMA #1-3

PROPOSED ROAD ACCESS

LOCATED IN: SEC. 3, T9S, R1E, B.H.M.
FALL RIVER COUNTY, SOUTH DAKOTA

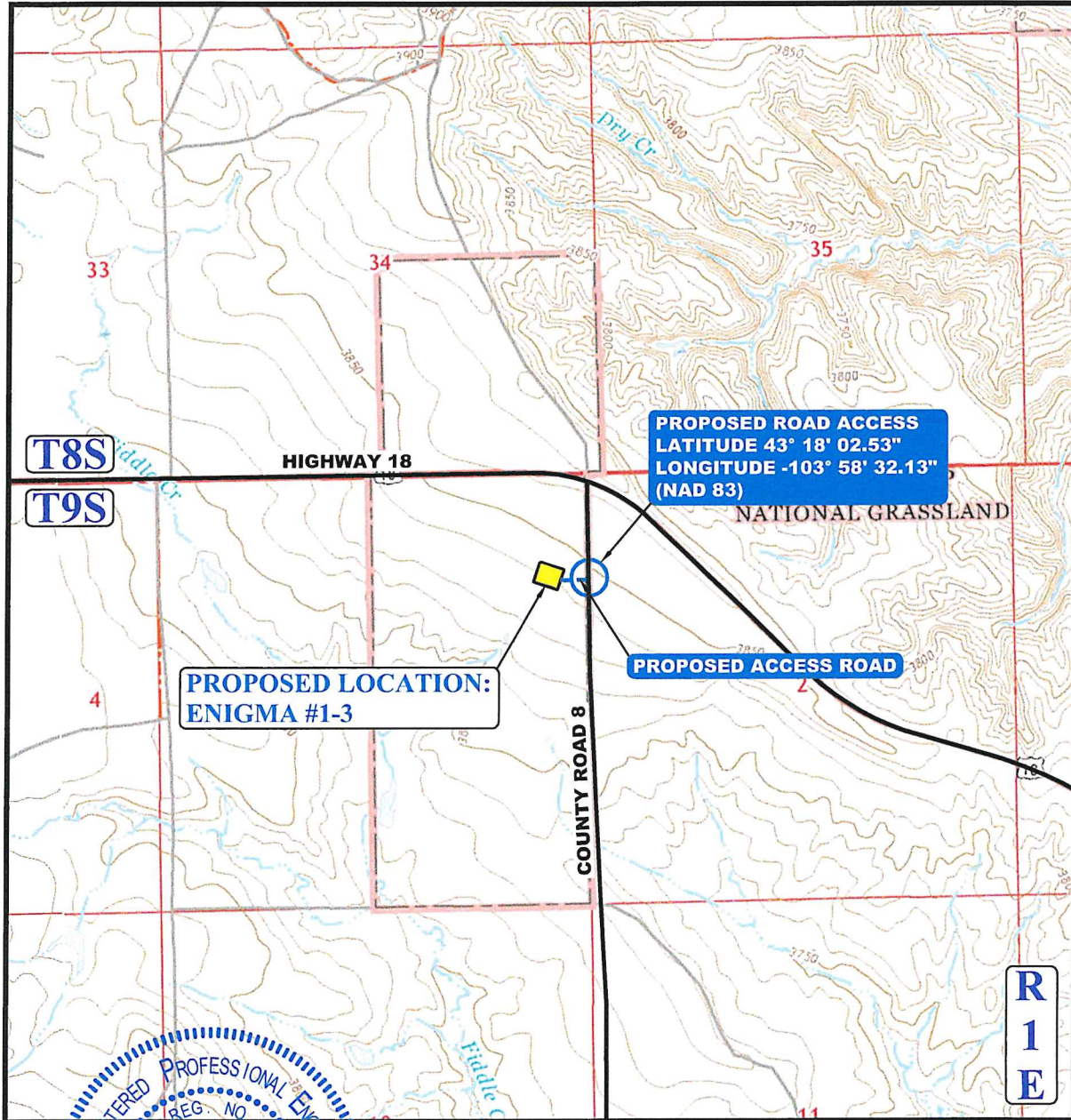

REGISTERED PROFESSIONAL ENGINEER
REG. NO. 9736
HAROLD NELSON MARSHALL
SOUTH DAKOTA

Harold Marshall
RESPONSIBLE ENGINEER

CONTENTS	
GENERAL NOTES.....	1
GEOMETRIC STANDARDS.....	2
CULVERT INSTALLATION DETAILS.....	3
CATTLE GUARD DETAILS	4-5
TRAFFIC CONTROL PLANS.....	T1-2
PLAN & PROFILE.....	P1



UELS, LLC
Corporate Office * 85 South 200 East
Vernal, UT 84078 * (435) 789-1017

DRAWN BY	A.T.	03-24-23	SCALE
			1" = 2,000'
ACCESS ROAD		COVER	

All materials for construction of the complete project including but not limited to rip-rap, water for dust control and compaction, culverts, bedding materials for culverts, surface course gravel, signs, etc. are to be provided by the contractor at his bid price unless other arrangements are made.

Construction of the approach from the county road must conform to current AASHTO and Fall River County standards. An access permit must be obtained for this approach prior to beginning construction. During construction, the contractor will follow all signing and flagging requirements as stated in the Manual of Uniform Traffic Control Devices latest edition.

Uintah Engineering and Land Surveying assumes no liability written or implied as to the location of pipelines or cable lines in the vicinity of this road design. South Dakota 811 (public lines) and or the owner of the transportation line (Private/Corporate lines) must be contacted for identification and location before construction begins. Transportation lines that may be identified on these plans may not be the only transportation lines in the vicinity of the road. These plans are not intended to be used to identify the location of transportation lines. Extreme caution shall be used when constructing road near or over transportation lines.

EXPLANATIONS:

PLAN & PROFILE SHEETS

Plan & Profile sheets show the horizontal and vertical alignment of the road, sign placement if any, turnout placement if any, estimated culvert placements and sizes, estimated wing ditches, horizontal and vertical curve data, and the percent super for construction of horizontal curves.

SCOPE OF WORK:

SHAPING THE ROADWAY

The roadway is to be shaped to the dimensions shown on the typical cross section included in this document. Care shall be given to insure that the travel-way width is not less or significantly more than the dimensions given on the typical cross section. Where turnouts are indicated, the typical section widths shown on the typical cross section will need to be modified by the amounts shown on the typical turn-out. Where there are horizontal curves, super-elevations will be constructed to the percentages shown on the plan and profile sheets. One-third of the super transition occurs on the curve and two-thirds on the tangent.

Top soil will be handled in the manner agreed upon and stated within the APD and the conditions of approval. If top soil is to be moved; Top soil will be peeled back during construction. Some over-excavation of cut slopes and bar ditches will provide needed material for road construction. Top soil will then be spread back over the cut and fill slopes and bar ditches.

The road shall have a crown as shown on the typical cross section to insure that water will drain off of the travel-way surface.



GEOMETRIC SPECIFICATIONS

GRAVEL SPECIFICATION:

3" minus pit run gravel (AASHTO M145-49 A-1-a Soil)

Do not place gravel on road until Inspector/Engineer has approved the sub-grade.

Place gravel to full widened width on turnouts, curve widening, and intersection flares.

TYPICAL CROSS SECTIONS

(for Proposed Access Road)

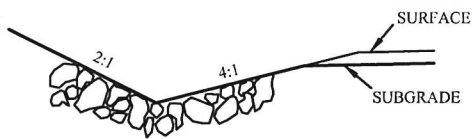
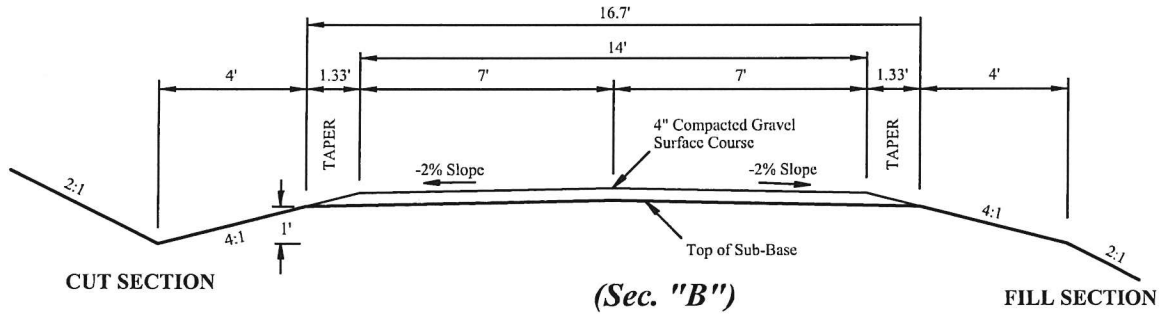
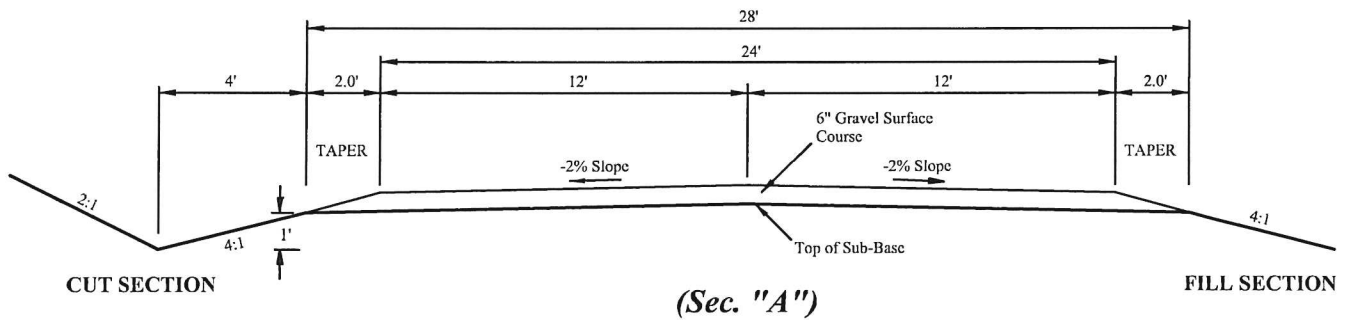

RIP-RAP IN BAR DITCH
(Only Where Specified)



WING DITCH (DETAIL)



RIP-RAP IN WING DITCH (DETAIL)
(Only Where Specified)

THE PLANS SHOW AN ESTIMATE OF THE NUMBER AND THE SIZE OF THE CULVERTS TO BE PLACED ON THE ROAD. THERE MAY NEED TO BE SOME FIELD ADJUSTMENTS MADE BY THE CONTRACTOR, BLM, AND/OR INSPECTOR/ENGINEER TO THE PLACEMENT AND LENGTH OF THE CULVERTS AND WING DITCHES.

CULVERT INGRESS AND EGRESS DITCH LENGTHS ARE TO BE DETERMINED DURING CONSTRUCTION. ALL DITCHES ARE TO BE CONSTRUCTED WITH SUFFICIENT SLOPE SO THAT WATER WILL EXIT THE DOWNSTREAM SIDE AND NOT POND IN THE DITCH.

ALL CULVERTS SHALL BE OF SUFFICIENT STRENGTH TO SUPPORT AN HS-20 LOADING OR HEAVIER. CHECK WITH MANUFACTURER FOR INFORMATION ABOUT MINIMUM COVER AND LOAD RATINGS. IN NO CASE SHALL COVER OVER CULVERTS BE LESS THAN 1'. CULVERT LENGTHS ARE ESTIMATED ON THE PLANS BUT THERE MAY NEED TO BE SOME ADJUSTMENTS MADE TO THE LENGTHS OF THE CULVERTS DURING CONSTRUCTION.

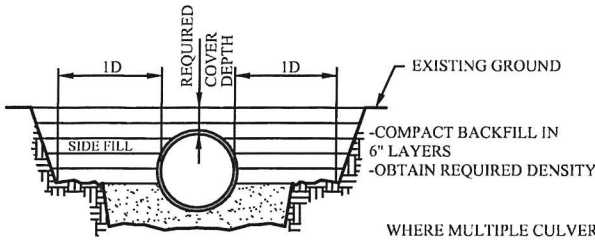

BACKFILL DETAIL

IN LIVE FISH BEARING STREAMS
LOWER BOTTOM OF CULVERT 6"
BELOW NATURAL CHANNEL SURFACE

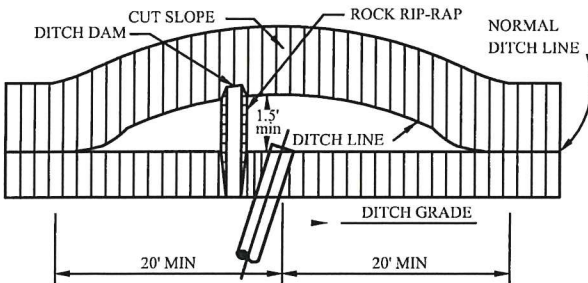
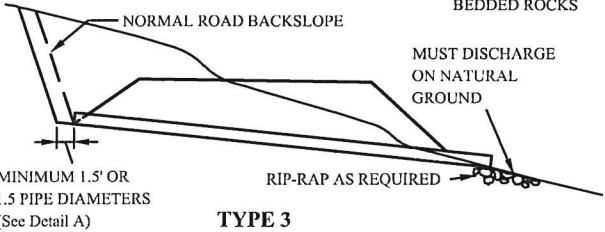
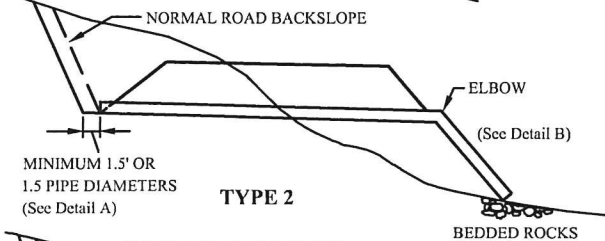
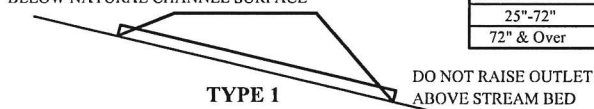

CATCH BASIN PLAN VIEW (TYPES 2 AND 3)
(DITCH DAM ONLY TYPE 1)

DETAIL A

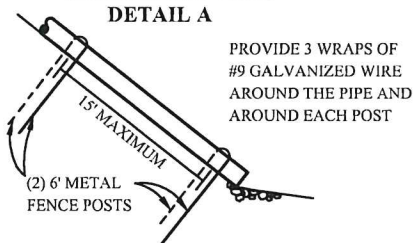

DETAIL B

WHERE MULTIPLE CULVERTS ARE SPECIFIED ON THE PLANS, THERE SHALL BE NO LESS THAN THE FOLLOWING CLEARANCE BETWEEN THE CULVERTS.

PIPE DIAM.-D	CLEARANCE
0"-24"	12"
25"-72"	1/2 Pipe Diam.
72" & Over	36"

RIP-RAP WILL BE PLACED AT ALL CULVERT INLETS AND OUTLETS AND ALSO, WHERE SPECIFIED ON THE PLAN & PROFILE SHEETS. RIP-RAP WILL BE SIZED DEPENDENT UPON PIPE DIAMETER AS SHOWN. RIP-RAP SHALL BE WELL GRADED WITH A SUFFICIENT AMOUNT OF SMALLER STONES UNIFORMLY DISTRIBUTED THROUGHOUT.

PIPE DIAM.-D	RIP-RAP SIZE	L	M	YARDAGE
0"-24"	60% shall be 8" in diameter or larger	5'	12"	±1 cyds
25"-48"	60% shall be 12" in diameter or larger	10'	18"	±6 cyds
49"-72"	60% shall be 18" in diameter or larger	15'	24"	±19 cyds

*Larger than 72", consult engineer.

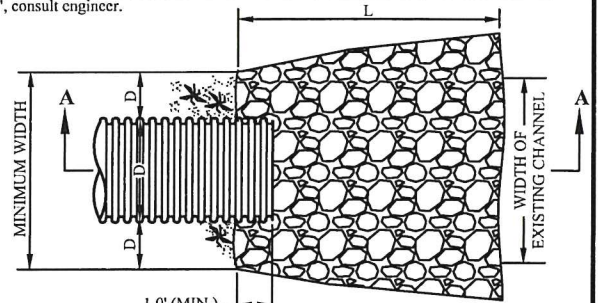

PLAN VIEW

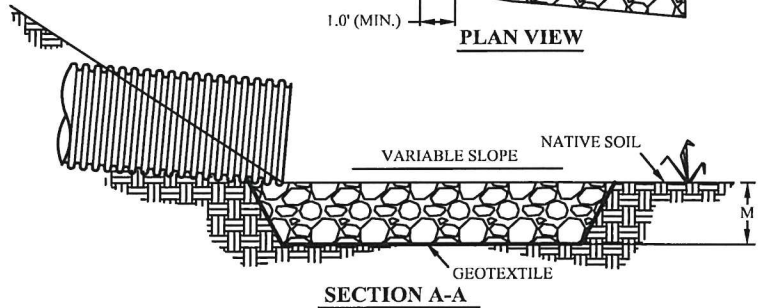

SECTION A-A

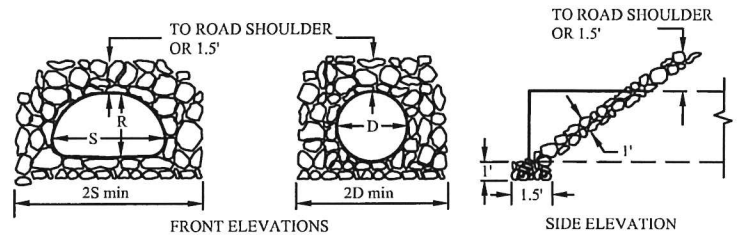

IN NARROW CHANNELS ADJUST RIP-RAP TO FIT ORIGINAL STREAM BANKS.

RIP-RAP DETAILS

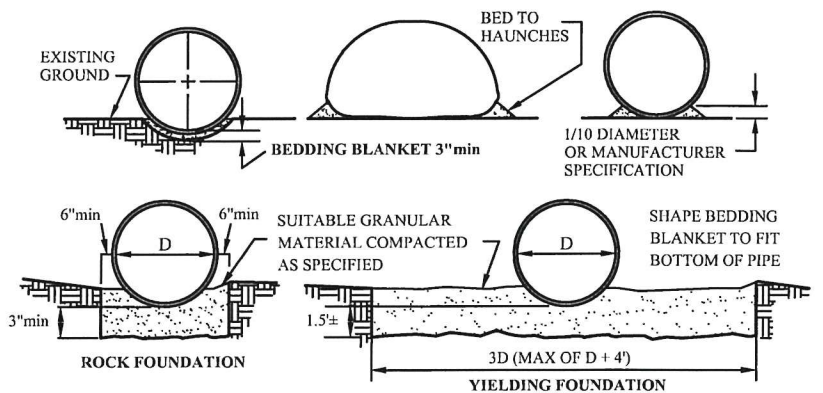

BEDDING DETAILS

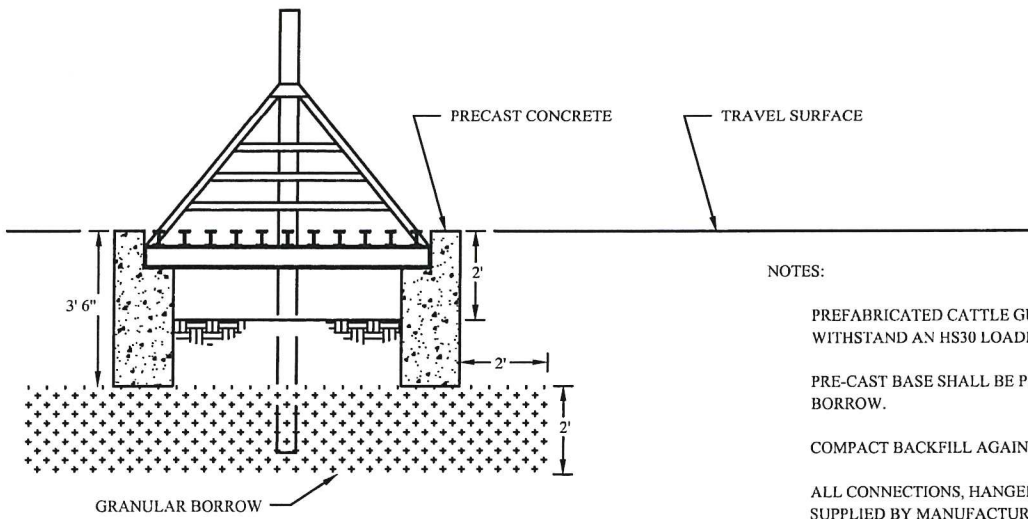

NOTES:

PREFABRICATED CATTLE GUARD SHALL BE DESIGNED TO WITHSTAND AN HS30 LOADING.

PRE-CAST BASE SHALL BE PLACED ON COMPACTED GRANULAR BORROW.

COMPACT BACKFILL AGAINST SIDES OF PRE-CAST BASE.

ALL CONNECTIONS, HANGERS, FASTENERS, ETC., SHALL BE SUPPLIED BY MANUFACTURER.

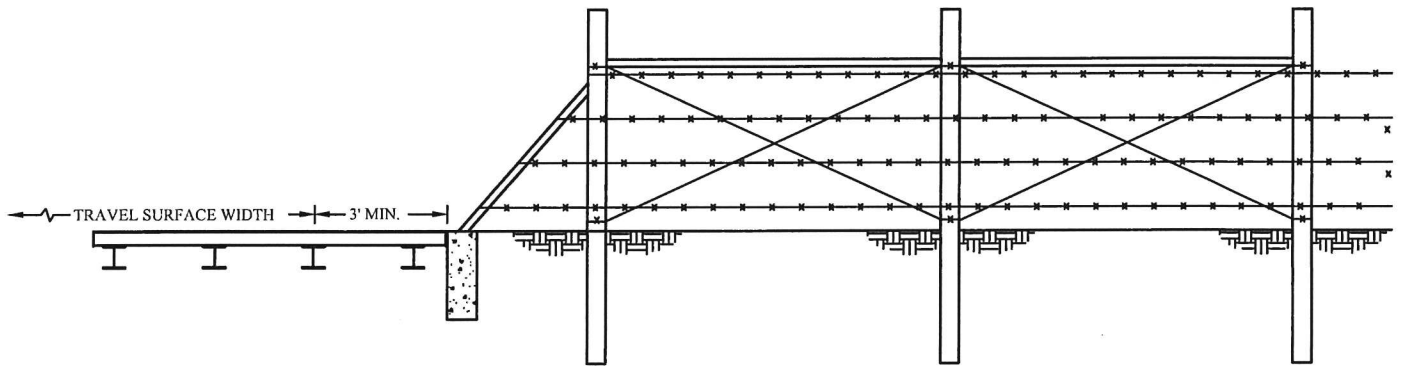

FENCE / GATE

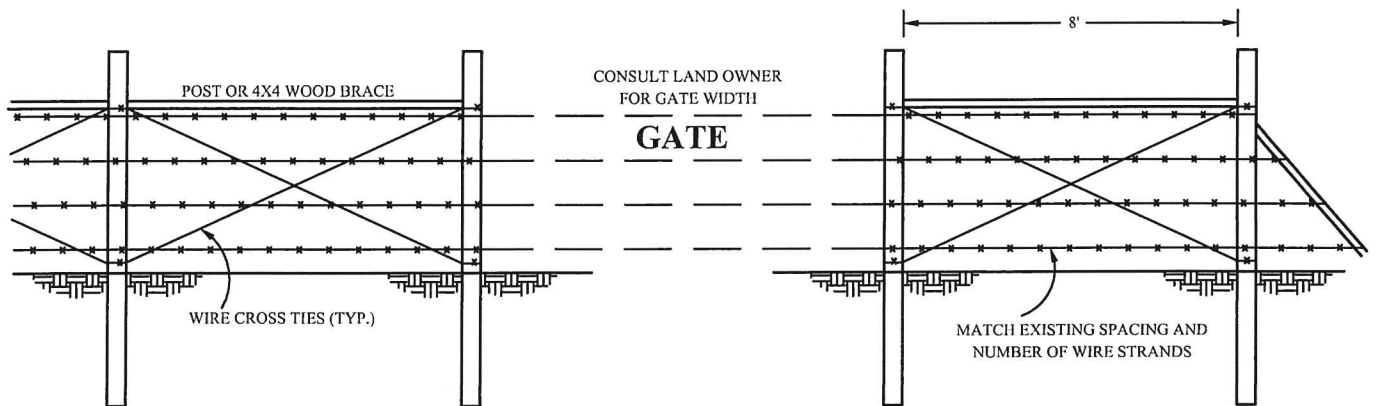

CONSULT LAND OWNER FOR GATE WIDTH

GATE

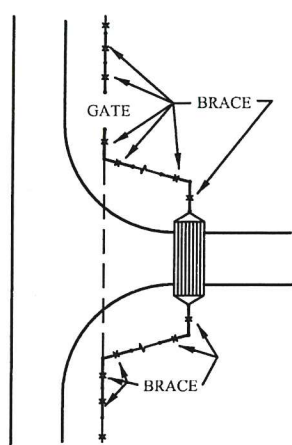

Option A

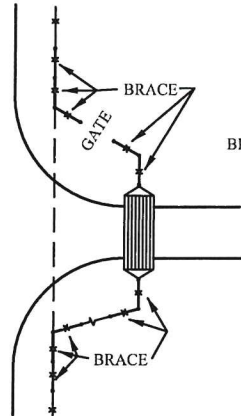

Option B

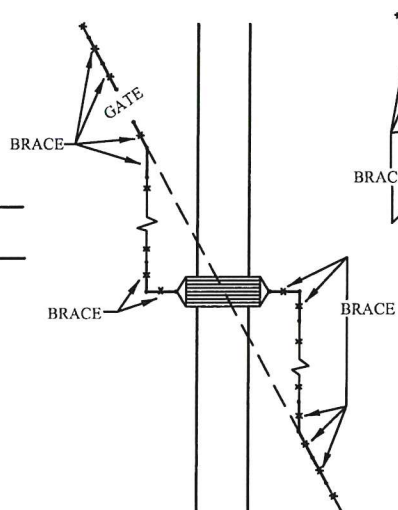

Option C

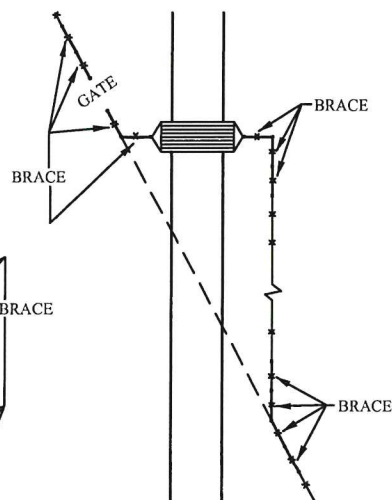

Option D

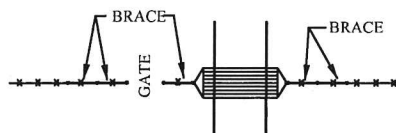

Option E

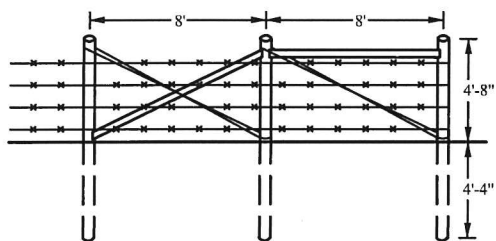

END PANEL-TYPE I

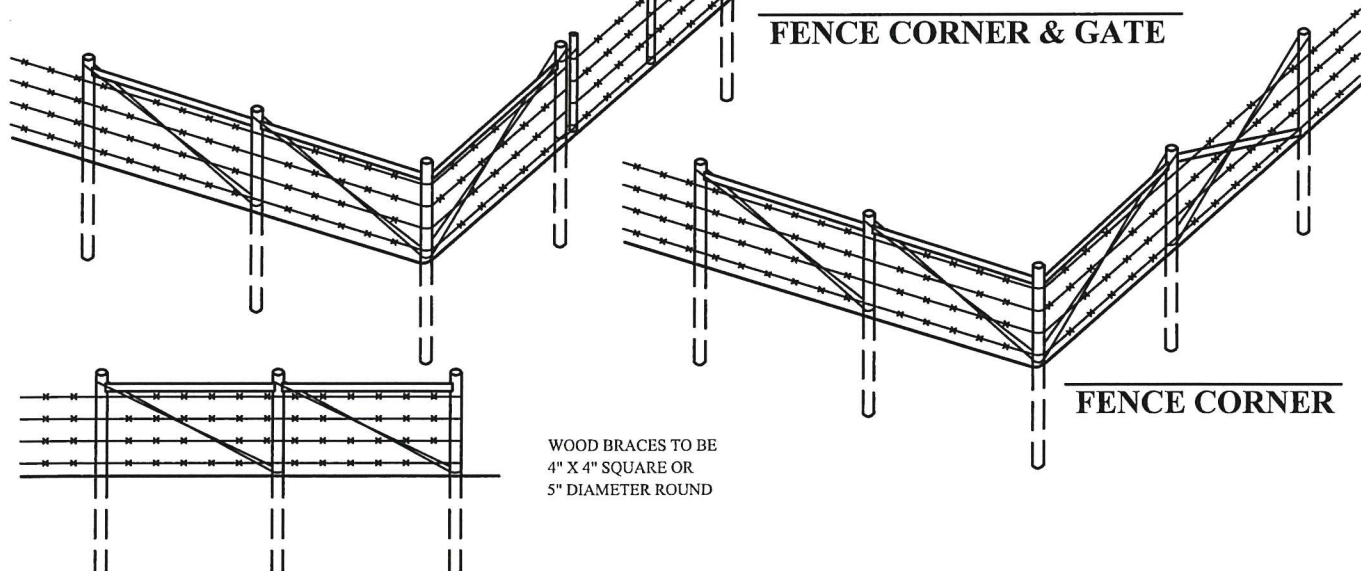

FENCE CORNER & GATE

FENCE CORNER

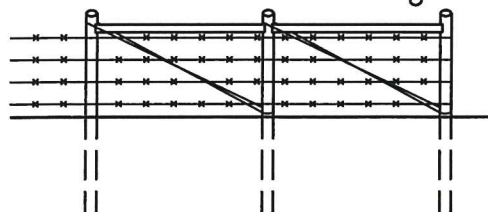

END PANEL-TYPE II

WOOD BRACES TO BE
4" X 4" SQUARE OR
5" DIAMETER ROUND

WORK WITHIN TRAVELWAY - LOW TRAFFIC VOLUME

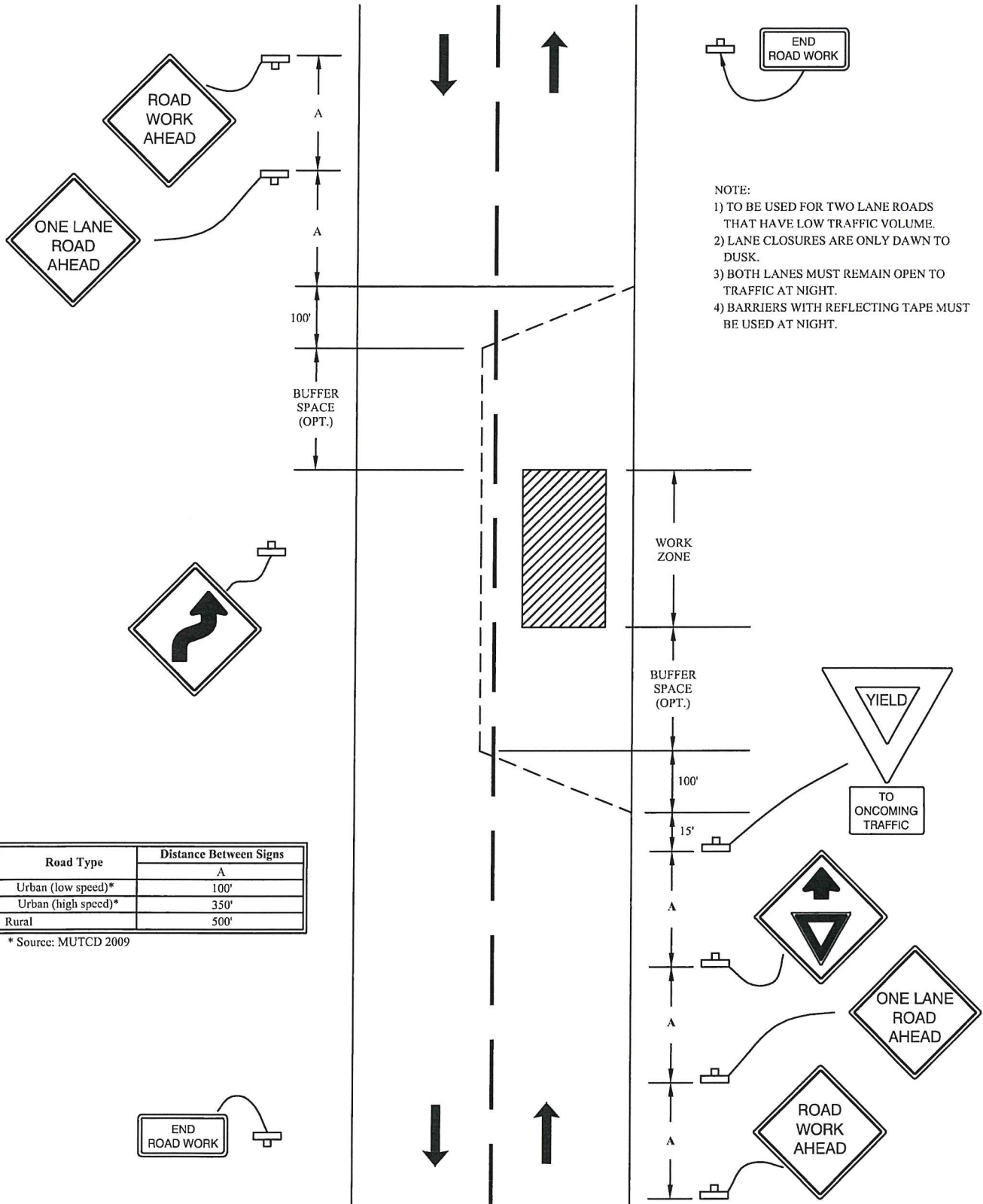

Road Type	Distance Between Signs
	A
Urban (low speed)*	100'
Urban (high speed)*	350'
Rural	500'

* Source: MUTCD 2009

WORK BEYOND THE SHOULDER - WITHIN RIGHT-OF-WAY

NOTE:
1) TO BE USED WHEN WORKING BEYOND THE SHOULDER.

Road Type	Distance Between Signs
	A
Urban (low speed)*	100'
Urban (high speed)*	350'
Rural	500'

* Source: MUTCD 2009

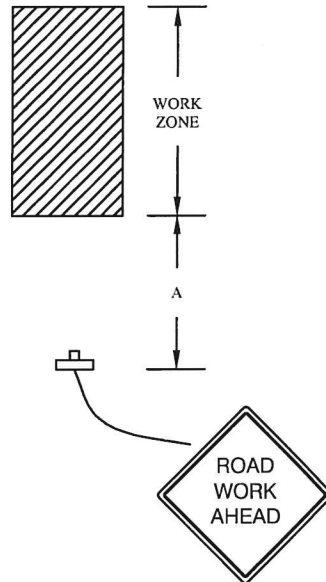

GULF EXPLORATION, LLC
ENIGMA #1-3
(PROPOSED ROAD ACCESS)
PLAN & PROFILE
SEC. 3, T9S, R1E, B.H.M.
FALL RIVER COUNTY, SOUTH DAKOTA
DATE: 03-24-23 BY: A.T.

BASIS OF BEARINGS IS THE EAST LINE OF THE NE 1/4 NE 1/4 OF SECTION 3, T9S, R1E, B.H.M. WHICH WAS ASSUMED TO BEAR N01°00'56"W FOR 1326.46'.
 NOTE:
 1. BEGIN PROFILE STATION 0+00 BEARS N32°29'01"W, 23.74' FROM THE NORTH 1/16 CORNER OF SECTION 3 & 2, T9S, R1E, B.H.M.
 2. END PROFILE STATION 3+50 BEARS N86°31'50"W, 362.84' FROM THE NORTH 1/16 CORNER OF SECTION 3 & 2, T9S, R1E, B.H.M..
 3. REMOVE FENCE WHERE PROPOSED ACCESS ENCROACHES. INSTALL CATTLE GUARD AND FENCE AS SHOWN.
 4. USE EXTREME CAUTION WHEN CONSTRUCTING APPROACH NEAR EXISTING PIPELINE. EXISTING PIPELINE MIGHT NEED TO BE BURIED DEEPER. CONTACT PIPELINE OWNER FOR SPECIFICATIONS.

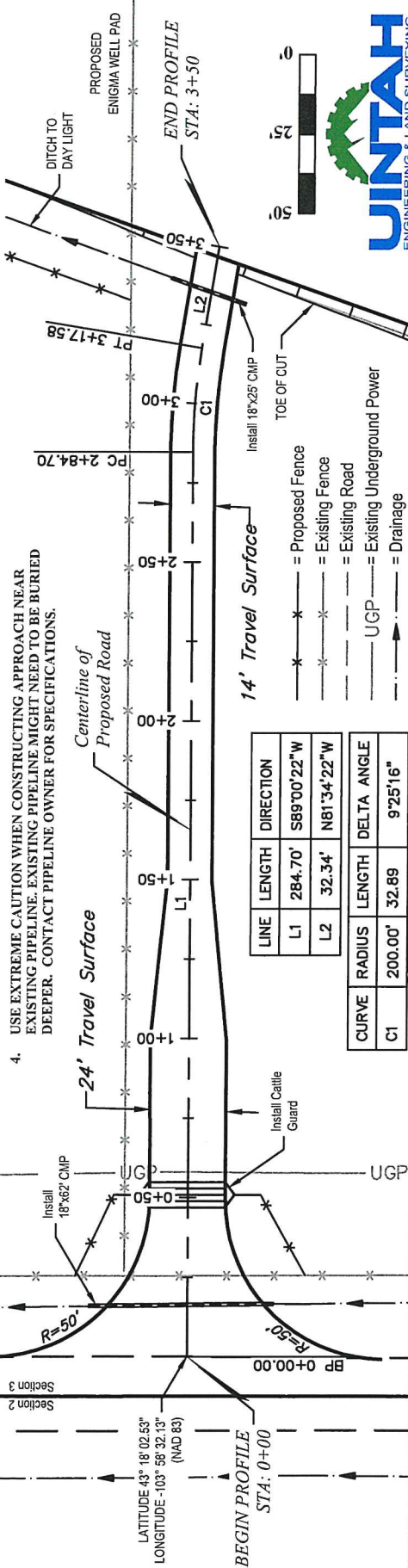

LINE	LENGTH	DIRECTION
L1	284.70'	S89°00'22"W
L2	32.34'	N81°34'22"W

CURVE	RADIUS	LENGTH	DELTA ANGLE
C1	200.00'	32.89'	9°25'16"

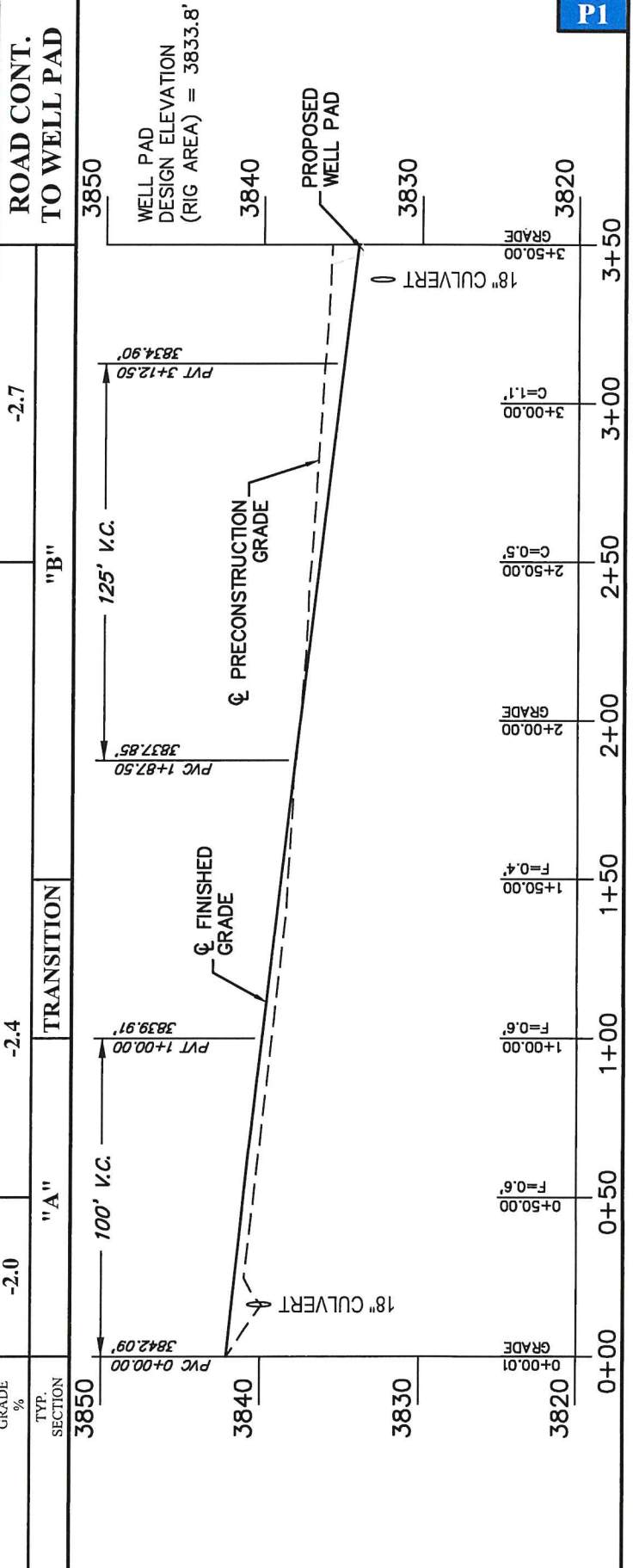

GRADE %	TYP. SECTION	TRANSITION
-2.0	"A"	"B"
-2.7		

**FALL RIVER COUNTY HIGHWAY DEPARTMENT
APPROACH PERMIT
APPLICATION FOR ROAD APPROACH PERMIT**

On this date March 2, 2023, the Applicant hereby applies to the Fall River County Highway Department for permission to construct an approach road connection to the North side of (road name) Coffee Flats Road (road #) 8 approximately at 6.5 miles south of US 18 intersection. The road approach will serve a oil/gas well location and will be (residence, church, business, etc.) constructed between April 1, 2023 and April 30, 2023 at (beginning date) (completion date) at

applicant's expense.

Applicant acknowledges that approach and culverts shall meet County specifications, which are on file at the County Highway Department. Please attach a drawing or sketch showing the proposed location of the approach and set stakes in the ground to enable the Superintendent/Foreman to locate the proposed approach.

Name: GULF EXPLORATION, LLC Address: 9701 North Broadway Extension Oklahoma City, Oklahoma 73114

Phone #: 307-473-1268 Signed: Robert M. Anderson
(Property Owner)

Authorized Agent for Gulf Exploration, LLC

TO BE COMPLETED BY FALL RIVER COUNTY HIGHWAY DEPARTMENT

Permit #: 4-17-23
MO/DY/YR

PRELIMINARY INSPECTION: Date 4-17-23 By: Randy Seik

Culvert Diameter 18" Culvert Length 78'

The crown of the presently traveled surface, including shoulder, to be continued at a distance of 20 feet from the nearest edge of the traveled surface of the road-shoulder facing the property.

Remarks: _____

PERMIT: ✓ APPROVED _____ DENIED _____

Randy Seik Date: 4-17-23
Superintendent/Foreman

FALL RIVER COUNTY HIGHWAY DEPARTMENT
SPECIFICATIONS FOR COUNTY ROADS AND APPROACHES

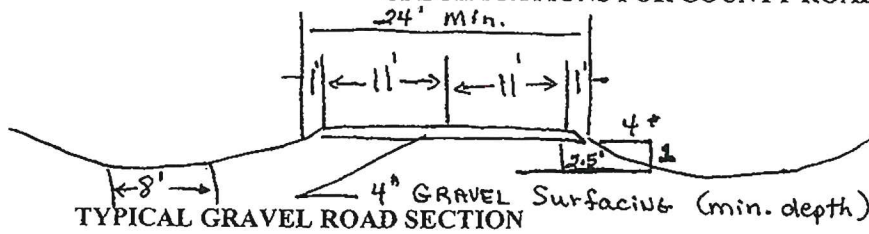

* Maximum slope is 4 to 1 (current Standard of the South Dakota DOT Steeper slopes are subject to the Approval of Fall River County

The above Typical Road Section and Typical Approach Detail (below) shall be followed in the construction of roads to be placed on the County Road System. Road design shall be consistent with published Standards of the American Association of State Highway Transportation Officials. Road construction materials and methods shall conform to the current published edition the "Standard Specifications for Roads and Bridges" of the South Dakota Department of Transportation, when referenced in the Standards below. Copy of these Specifications is on file at the County Highway Department Office.

The following are standards which shall be met:

1. Maximum Grade of any road or portion of road shall not exceed ten percent (10%)
2. Maximum Degree of Curvature shall not exceed twenty one degrees (21 degrees)
3. Crown rates shall be between 0.02 11/11 to 0.06 11/11. Maximum Super elevation rate in curves shall be 0.07 11/11.
4. Culverts shall be sized to assure proper drainage. The minimum size of culvert shall be eighteen inches (18") in diameter. Although fifteen inch (15") diameter will be allowed under certain conditions.
5. Gravel Surfacing shall meet the requirements of Part B of the Standard Specifications.
6. Asphalt and Concrete construction methods and materials shall meet the requirements of Part C and Part D of the "Standard Specifications".
7. All Dead-End Roads shall have Cul-De-Sacs with a minimum constructed radius of fifty feet (50').
8. Approaches shall be constructed perpendicular as practical to the County Road.
9. The Minimum dedicated Right-Of-Way width shall be sixty six feet (66').

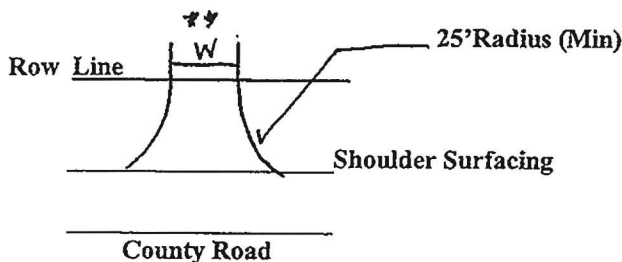

** W Is Surface Width at Right-Of- Way line
W - 16' Min. for Single Residences
W - 20' Min for Multiple Residences
W - 28' Min. for Commercial

Maximum W - 50'

TYPICAL APPROACH DETAIL

1. Only one approach shall be allowed to each tract or parcel of land.
2. Existing roadway drainage will be maintained. Culverts shall be sized to assure proper drainage. The maximum size of culvert shall be eighteen Inches (18") in diameter, although fifteen Inch (15") diameter will be allowed under certain conditions. The minimum length of approach culvert shall be thirty-two feet (32')
3. Sight distance of approaches shall meet published Standards of the American Association of State Highway Transportation Officials.

APPROVED BY: _____ DATE _____
(Chairman) FALL RIVER COUNTY COMMISSIONERS

RECOMMENDED BY: Randy Seck 4-17-23
FALL RIVER COUNTY HIGHWAY SUPERINTENDENT DATE

GULF EXPOLORATION, LLC

SUNRISE #1-28

PROPOSED ACCESS ROAD

LOCATED IN: SEC. 28, T9S, R1E, B.H.M.
FALL RIVER COUNTY, SOUTH DAKOTA

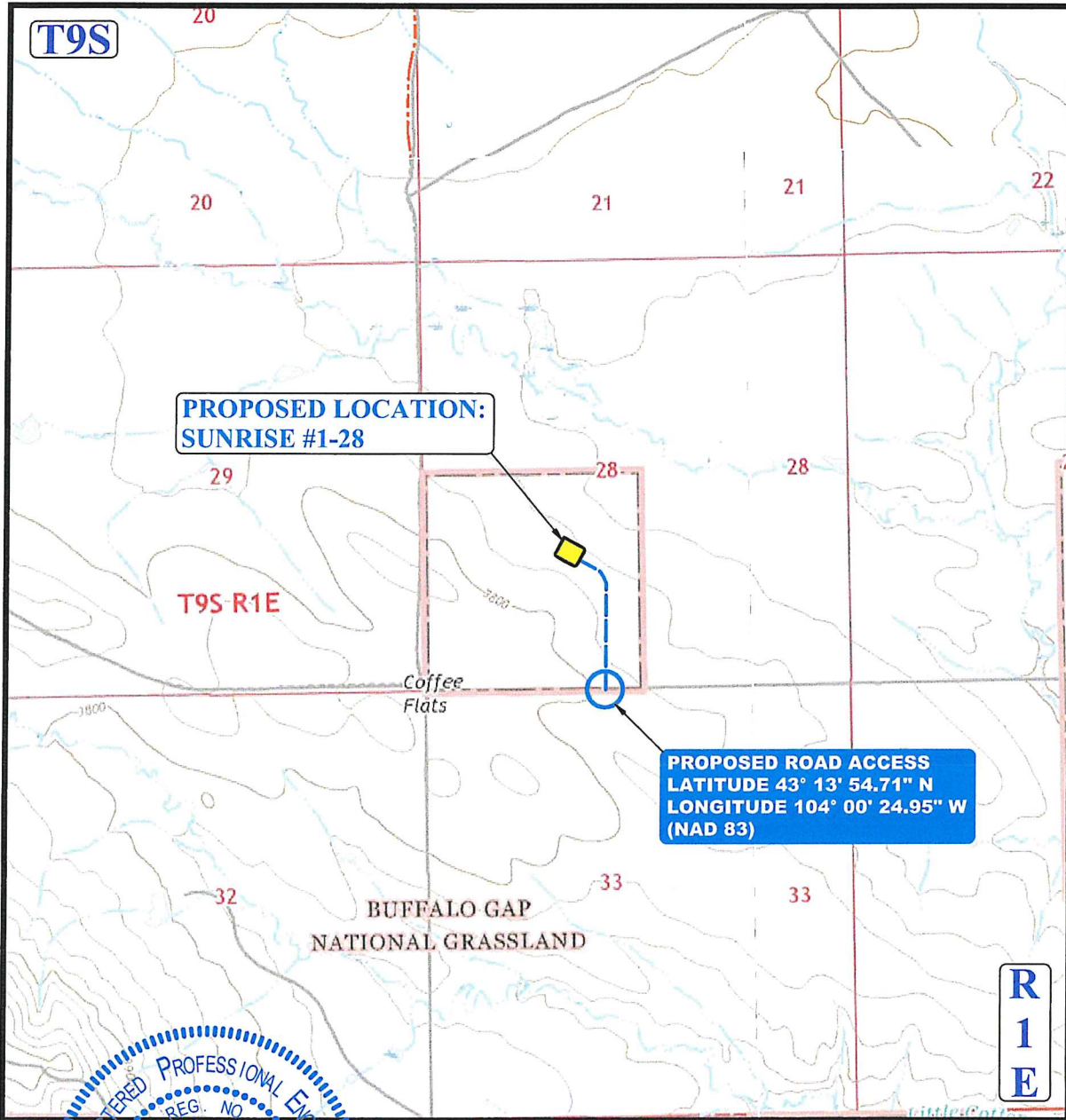

REGISTERED PROFESSIONAL ENGINEER
REG. NO. 9736
HAROLD NELSON MARSHALL
SOUTH DAKOTA
Harold Marshall
RESPONSIBLE ENGINEER

CONTENTS	
GENERAL NOTES.....	1
GEOMETRIC STANDARDS.....	2
CULVERT INSTALLATION DETAILS.....	3
CATTLE GUARD DETAILS	4-5
TRAFFIC CONTROL PLANS.....	T1-2
PLAN & PROFILE.....	P1



UELS, LLC
Corporate Office * 85 South 200 East
Vernal, UT 84078 * (435) 789-1017

DRAWN BY	A.T.	02-22-23	SCALE
			1" = 2,000'
ACCESS ROAD		COVER	

All materials for construction of the complete project including but not limited to rip-rap, water for dust control and compaction, culverts, bedding materials for culverts, surface course gravel, signs, etc. are to be provided by the contractor at his bid price unless other arrangements are made.

Construction of the approach from the county road must conform to current AASHTO and Fall River County standards. An access permit must be obtained for this approach prior to beginning construction. During construction, the contractor will follow all signing and flagging requirements as stated in the Manual of Uniform Traffic Control Devices latest edition.

Uintah Engineering and Land Surveying assumes no liability written or implied as to the location of pipelines or cable lines in the vicinity of this road design. South Dakota 811 (public lines) and or the owner of the transportation line (Private/Corporate lines) must be contacted for identification and location before construction begins. Transportation lines that may be identified on these plans may not be the only transportation lines in the vicinity of the road. These plans are not intended to be used to identify the location of transportation lines. Extreme caution shall be used when constructing road near or over transportation lines.

EXPLANATIONS:

PLAN & PROFILE SHEETS

Plan & Profile sheets show the horizontal and vertical alignment of the road, sign placement if any, turnout placement if any, estimated culvert placements and sizes, estimated wing ditches, horizontal and vertical curve data, and the percent super for construction of horizontal curves.

SCOPE OF WORK:

SHAPING THE ROADWAY

The roadway is to be shaped to the dimensions shown on the typical cross section included in this document. Care shall be given to insure that the travel-way width is not less or significantly more than the dimensions given on the typical cross section. Where turnouts are indicated, the typical section widths shown on the typical cross section will need to be modified by the amounts shown on the typical turn-out. Where there are horizontal curves, super-elevations will be constructed to the percentages shown on the plan and profile sheets. One-third of the super transition occurs on the curve and two-thirds on the tangent.

Top soil will be handled in the manner agreed upon and stated within the APD and the conditions of approval. If top soil is to be moved; Top soil will be peeled back during construction. Some over-excavation of cut slopes and bar ditches will provide needed material for road construction. Top soil will then be spread back over the cut and fill slopes and bar ditches.

The road shall have a crown as shown on the typical cross section to insure that water will drain off of the travel-way surface.



UELS, LLC
Corporate Office * 85 South 200 East
Vernal, UT 84078 * (435) 789-1017

GEOMETRIC SPECIFICATIONS

GRAVEL SPECIFICATION:

3" minus pit run gravel (AASHTO M145-49 A-1-a Soil)

Do not place gravel on road until Inspector/Engineer has approved the sub-grade.

Place gravel to full widened width on turnouts, curve widening, and intersection flares.

TYPICAL CROSS SECTIONS

(for Proposed Access Road)

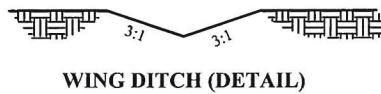
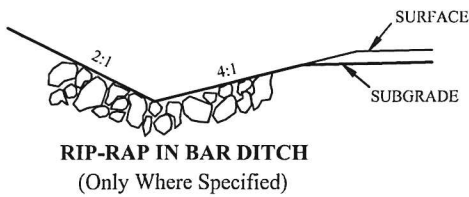
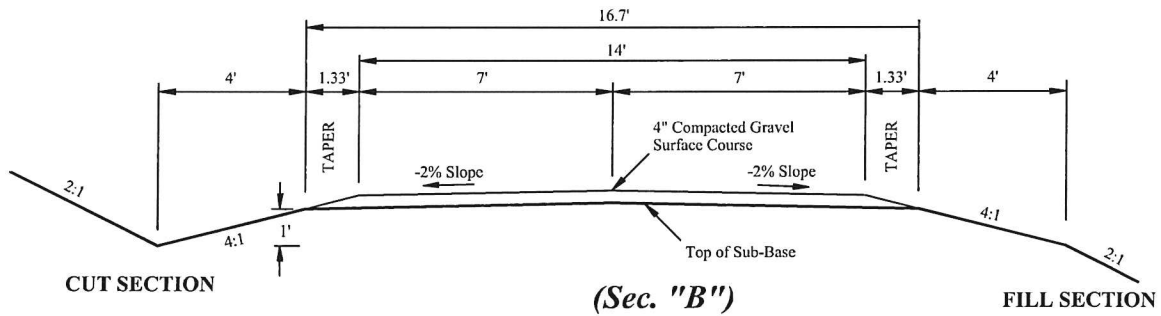
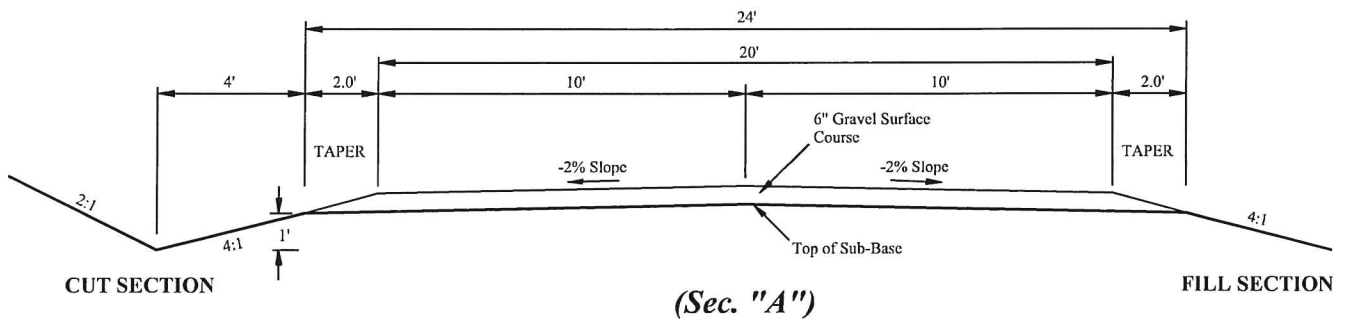

THE PLANS SHOW AN ESTIMATE OF THE NUMBER AND THE SIZE OF THE CULVERTS TO BE PLACED ON THE ROAD. THERE MAY NEED TO BE SOME FIELD ADJUSTMENTS MADE BY THE CONTRACTOR, BLM, AND/OR INSPECTOR/ENGINEER TO THE PLACEMENT AND LENGTH OF THE CULVERTS AND WING DITCHES.

CULVERT INGRESS AND EGRESS DITCH LENGTHS ARE TO BE DETERMINED DURING CONSTRUCTION. ALL DITCHES ARE TO BE CONSTRUCTED WITH SUFFICIENT SLOPE SO THAT WATER WILL EXIT THE DOWNSTREAM SIDE AND NOT POND IN THE DITCH.

ALL CULVERTS SHALL BE OF SUFFICIENT STRENGTH TO SUPPORT AN HS-20 LOADING OR HEAVIER. CHECK WITH MANUFACTURER FOR INFORMATION ABOUT MINIMUM COVER AND LOAD RATINGS. IN NO CASE SHALL COVER OVER CULVERTS BE LESS THAN 1'. CULVERT LENGTHS ARE ESTIMATED ON THE PLANS BUT THERE MAY NEED TO BE SOME ADJUSTMENTS MADE TO THE LENGTHS OF THE CULVERTS DURING CONSTRUCTION.

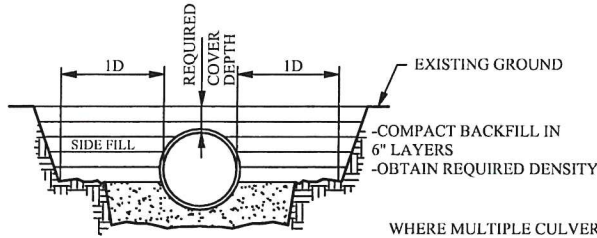

BACKFILL DETAIL

IN LIVE FISH BEARING STREAMS
LOWER BOTTOM OF CULVERT 6"
BELOW NATURAL CHANNEL SURFACE

WHERE MULTIPLE CULVERTS ARE SPECIFIED ON THE PLANS, THERE SHALL BE NO LESS THAN THE FOLLOWING CLEARANCE BETWEEN THE CULVERTS.

PIPE DIAM.-D	CLEARANCE
0"-24"	12"
25"-72"	1/2 Pipe Diam.
72" & Over	36"

RIP-RAP WILL BE PLACED AT ALL CULVERT INLETS AND OUTLETS AND ALSO, WHERE SPECIFIED ON THE PLAN & PROFILE SHEETS. RIP-RAP WILL BE SIZED DEPENDENT UPON PIPE DIAMETER AS SHOWN. RIP-RAP SHALL BE WELL GRADED WITH A SUFFICIENT AMOUNT OF SMALLER STONES UNIFORMLY DISTRIBUTED THROUGHOUT.

PIPE DIAM.-D	RIP-RAP SIZE	L	M	YARDAGE
0"-24"	60% shall be 8" in diameter or larger	5'	12"	±1 cyds
25"-48"	60% shall be 12" in diameter or larger	10'	18"	±6 cyds
49"-72"	60% shall be 18" in diameter or larger	15'	24"	±19 cyds

*Larger than 72", consult engineer.

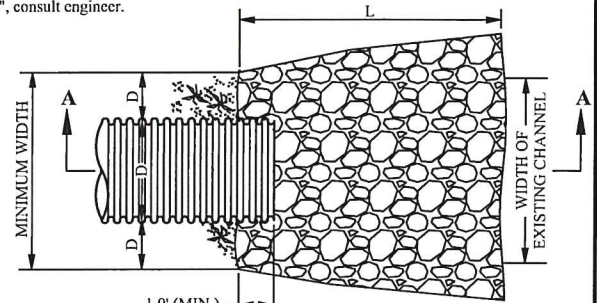

PLAN VIEW

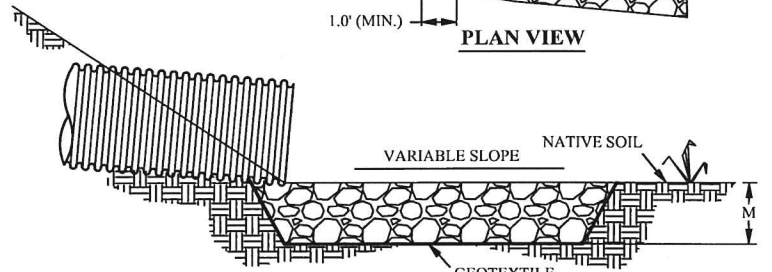
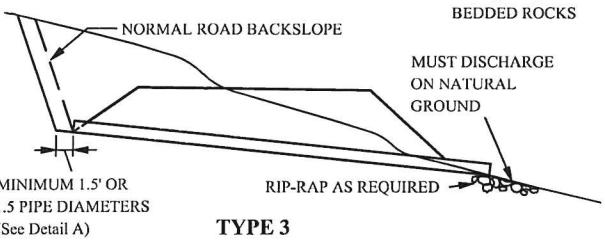
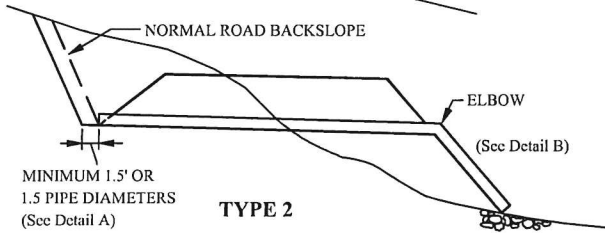

SECTION A-A

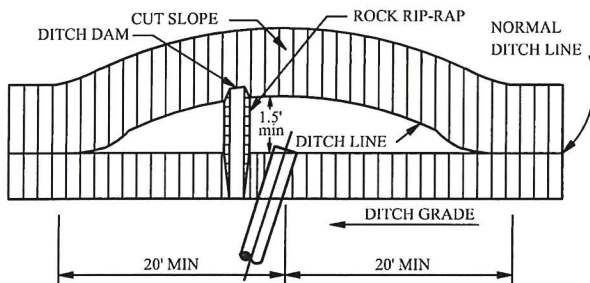

CATCH BASIN PLAN VIEW (TYPES 2 AND 3)
(DITCH DAM ONLY TYPE 1)

DETAIL A

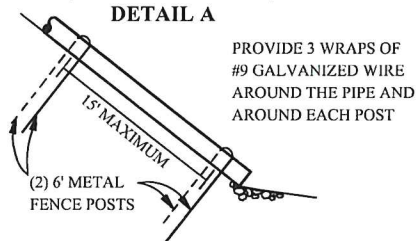

DETAIL B

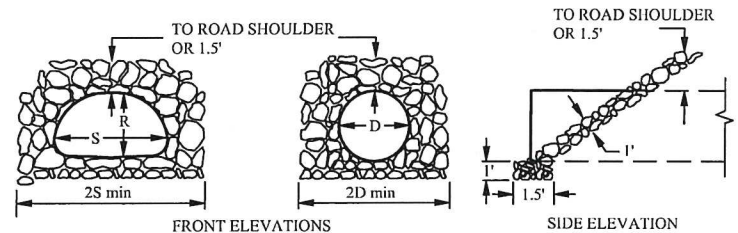

FRONT ELEVATIONS

SIDE ELEVATION

IN NARROW CHANNELS ADJUST RIP-RAP TO FIT ORIGINAL STREAM BANKS.

RIP-RAP DETAILS

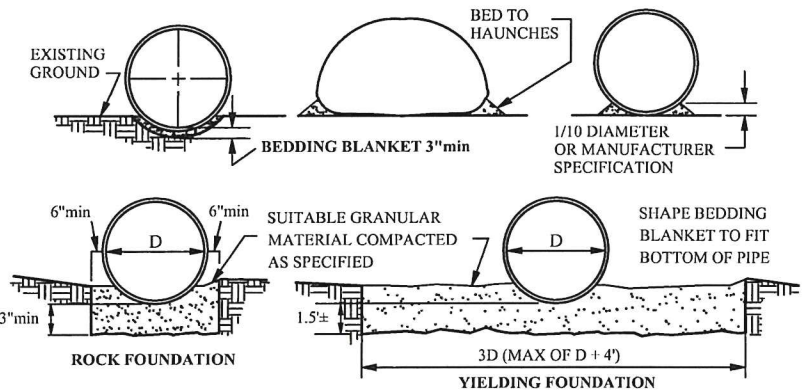

BEDDING DETAILS

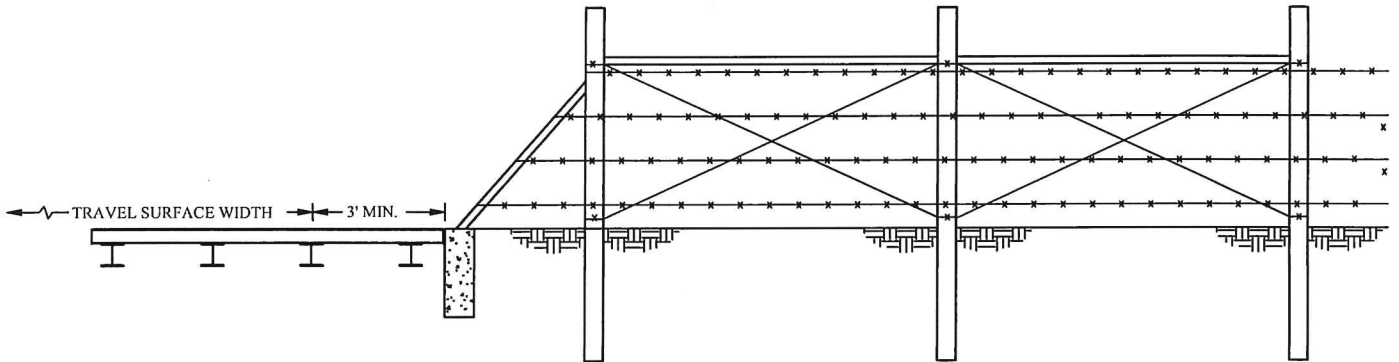
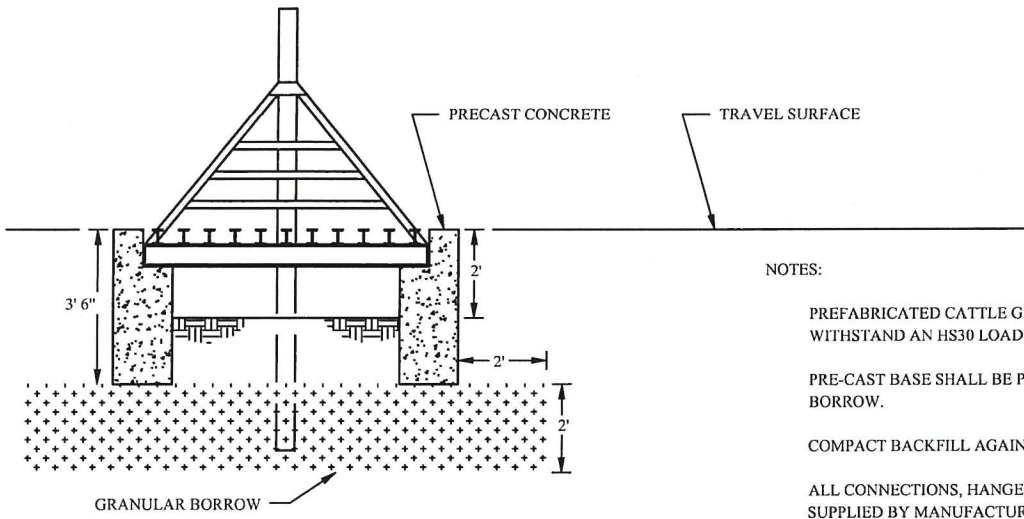

FENCE / GATE

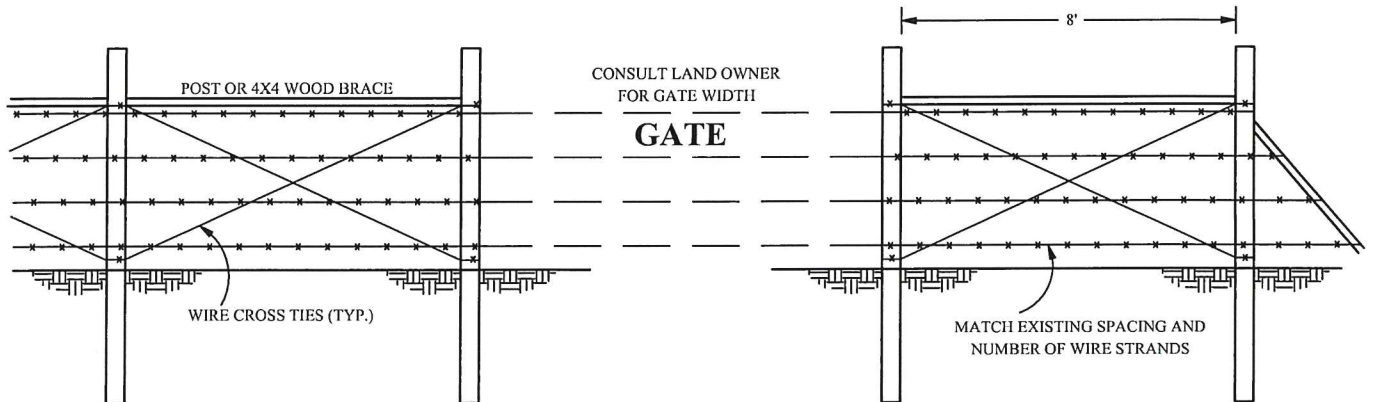

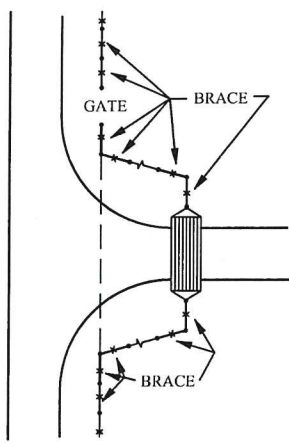

Option A

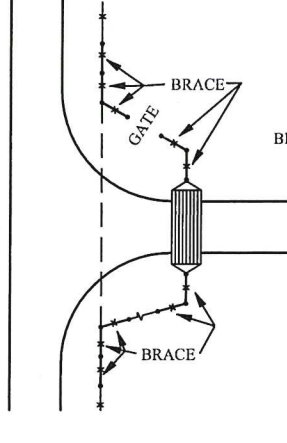

Option B

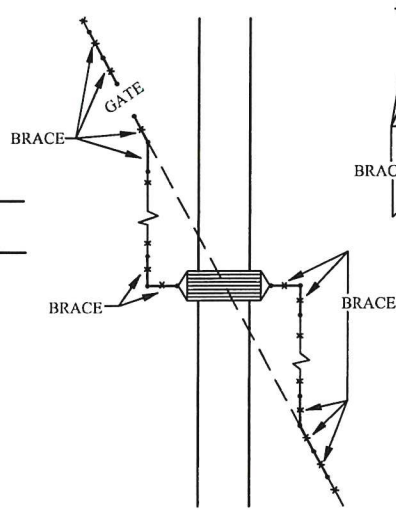

Option C

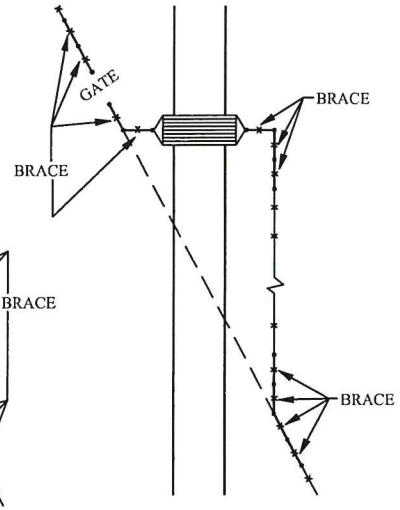

Option D

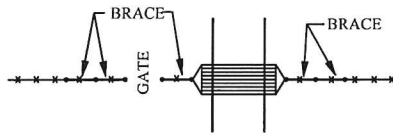

Option E

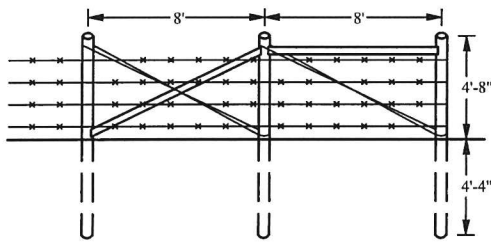

END PANEL-TYPE I

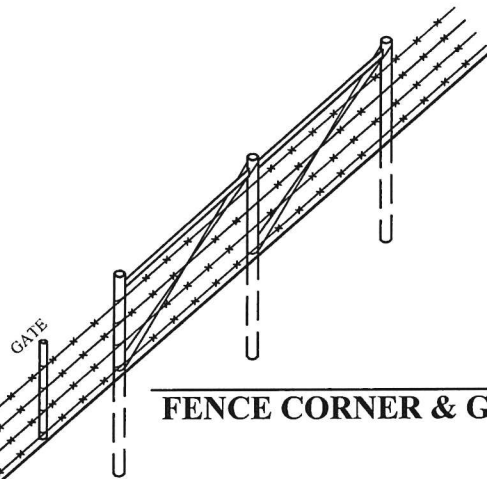

FENCE CORNER & GATE

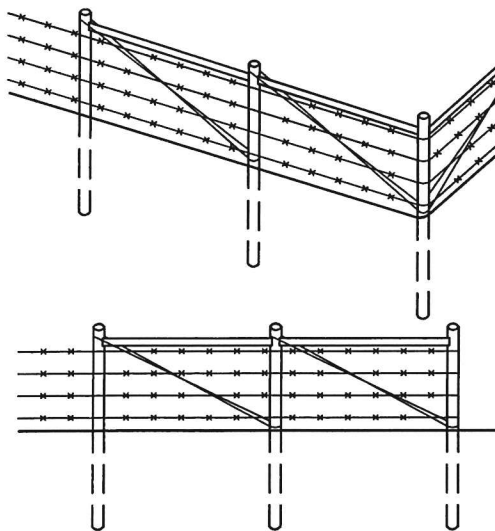

END PANEL-TYPE II

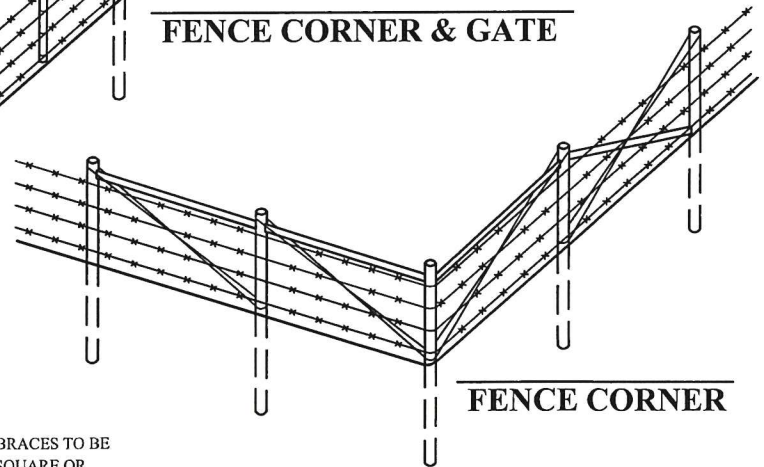

FENCE CORNER

WOOD BRACES TO BE
4" X 4" SQUARE OR
5" DIAMETER ROUND

WORK WITHIN TRAVELWAY - LOW TRAFFIC VOLUME

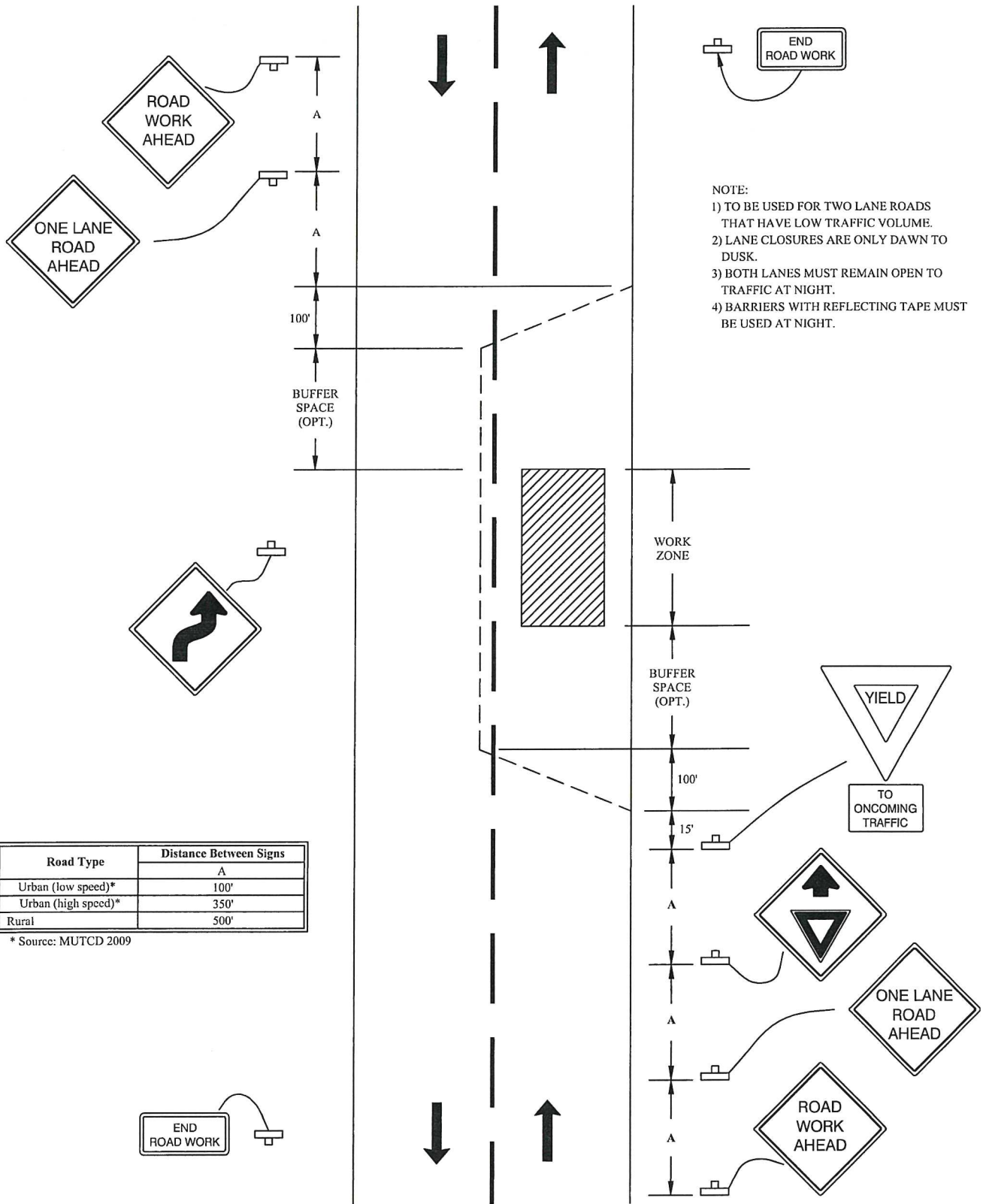

Road Type	Distance Between Signs
	A
Urban (low speed)*	100'
Urban (high speed)*	350'
Rural	500'

* Source: MUTCD 2009

WORK BEYOND THE SHOULDER - WITHIN RIGHT-OF-WAY

Road Type	Distance Between Signs
	A
Urban (low speed)*	100'
Urban (high speed)*	350'
Rural	500'

* Source: MUTCD 2009



NOTE:
1) TO BE USED WHEN WORKING BEYOND THE SHOULDER.

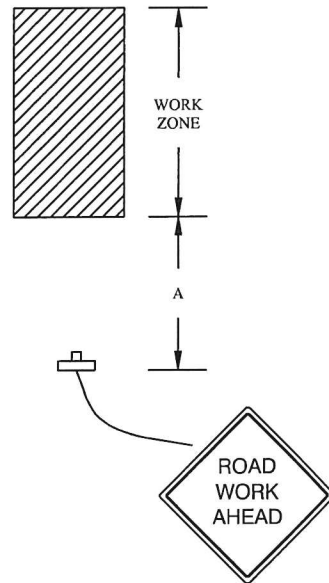

BASIS OF BEARINGS IS THE SOUTH LINE OF THE SW 1/4 OF SECTION 28, T9S, R1E, B.M.I. WHICH WAS ASSUMED TO BEAR S89°08'16"W FOR 2639.54'.

GULF EXPLORATION, LLC
SUNRISE #1-28
 (PROPOSED ACCESS ROAD)

PLAN & PROFILE
 SEC. 28, T9S, R1E, B.M.I.
 FALL RIVER COUNTY, SOUTH DAKOTA

DATE: 02-22-23 BY: A.T.
 REV.: 03-02-23 A.T. (SHOW FIBER OPTIC LINE)

1. BEGIN PROFILE STATION 0+00 BEARS N89°18'53"W 415.99' FROM THE SOUTH 1/4 CORNER OF SECTION 28, T9S, R1E, B.M.I.
2. END PROFILE STATION 4+00 BEARS N45°46'04"W 580.55' FROM THE SOUTH 1/4 CORNER OF SECTION 28, T9S, R1E, B.M.I.
3. REMOVE FENCE WHERE PROPOSED ACCESS ENCLOSED. INSTALL CATTLE GUARD AND FENCE AS SHOWN.
4. USE EXTREME CAUTION WHEN CONSTRUCTING APPROACH NEAR EXISTING PIPELINE. EXISTING PIPELINE MIGHT NEED TO BE BURIED DEEPER. CONTACT PIPELINE OWNER FOR SPECIFICATIONS.

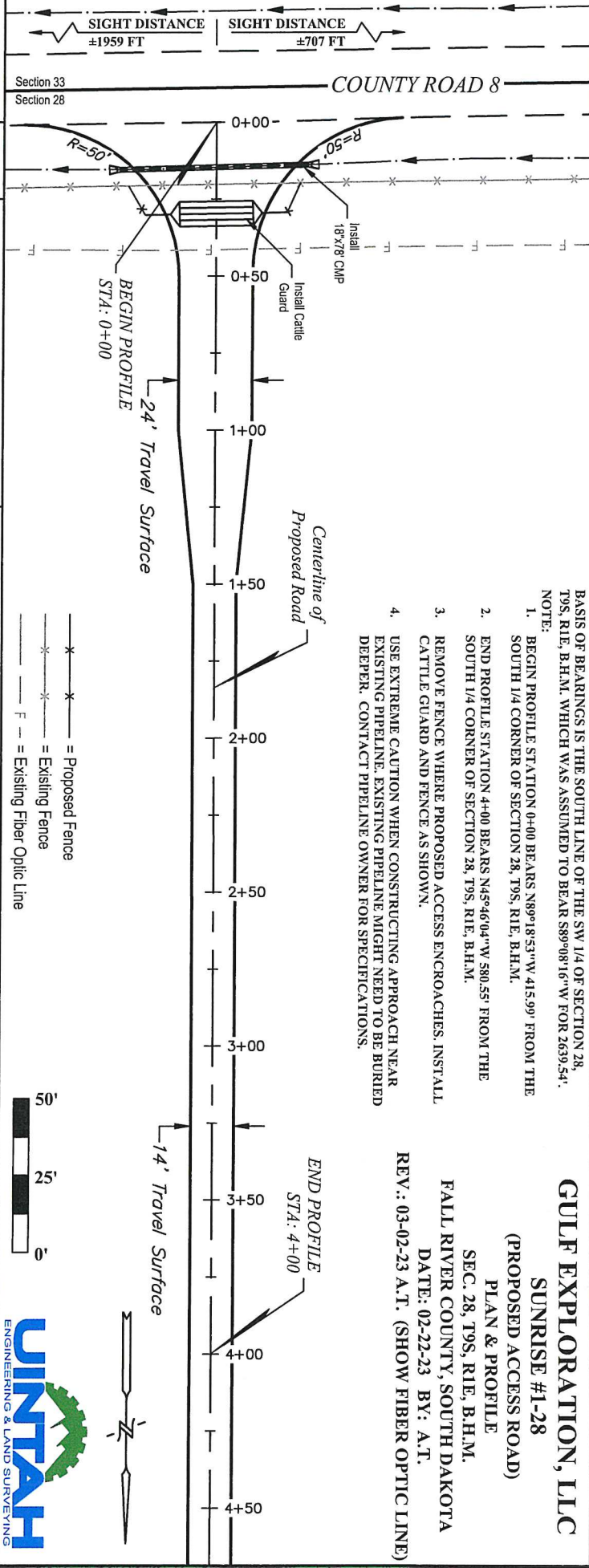

GRADE %	-2.0	-5.3	-2.0	-1.3
TYP. SECTION	"A"		"B"	
	TRANSITION			
			ROAD CONT. TO WELL PAD	

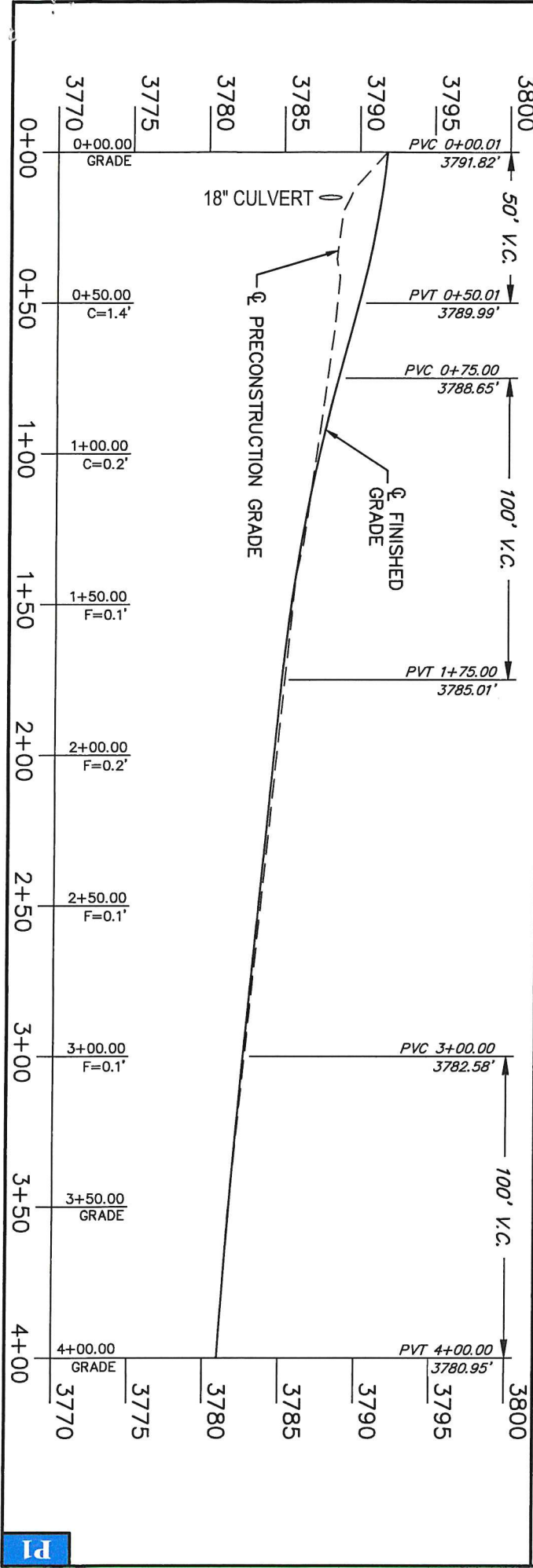

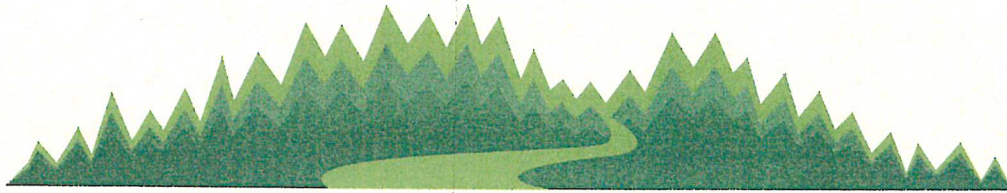

Black Hills Regional Multiple Use Coalition

P.O. Box 9496 • Rapid City, SD 57709 • 605-341-0875 • Fax 605-341-8651

April 17, 2023

TO: BOARD OF DIRECTORS

SUBJECT: MEETING NOTICE

The next Black Hills Regional Multiple Use Coalition, Board of Directors meeting will be Friday, April 28th, 4:00 pm, at the Spearfish Holiday Inn. We will have Kwinn Neff speaking to the group about the proposed mineral withdrawal in the Black Hills, which is out for comment now, so please plan to attend. Kwinn is the President of SD Mineral Industries Association.

The tentative agenda items are:

- Kwinn Neff – Review and discuss the proposed mineral withdrawal in the Black Hills.
- Continue discussions regarding:
 - o Increasing BHRMUC Impact
 - o Monthly Meeting Planning
- Directors Round Robin
- Directors Round Robin

Please feel free to call me at 605-341-0875 if you have any questions or comments.

Ben Wudtke
Executive Secretary

Black Hills Regional Multiple Use Coalition- March 24, 2023

The March 2023 BHRMUC meeting was called to order at 4:03 pm at the Holiday Inn in Spearfish, SD. Those in attendance were Don Hausle, Kevin Klunder, Butch Oien, Eric Jennings, Matt Lottes, Hugh Thompson, Pam Thompson, Patty Brown, Randy Diebert, Richard Sleep, Bill Coburn, & Mitch Iverson.

Meeting began with the Pledge of Allegiance.

This meeting's agenda was approved.

Feb 2023 minutes reviewed – “Bill 21” should be changed to read “Senate Bill 21”, Don motioned to approve as amended, Eric seconded, all in favor.

Eric provided Treasurer's Report – current balance of \$15,185.46, report approved.

Ralph Adam (BHNF) gave a presentation and led discussion on the Off Highway Vehicle Development Program in the Black Hills

OHV use in the Black Hills is increasingly significant - 7,832 trail permits sold in 2011 vs 738,000 sold in 2021

Revenue from the permits goes towards trail staff salaries, vehicles/equipment, supplies, and project work (contracts)

Hiring progress – 7 trail ranger crew and 5 maintenance crew members hired to work out of Nemo; 2 ranger/maintenance personnel in Sundance

>35 citations issued in 2022 (about the same as 2021) while patrolling 3,000 miles of trails & roads. Roads “open to all” can be patrolled and trail rangers can issue tickets for what they encounter during normal operations.

Ralph said the best way to report OHV related trail/road concerns is by contacting the pertinent District Ranger. 70% of OHVs being used in the Black Hills are overwidth.

Mitch stated that there's a perception that the FS is ignoring people regarding OHV concerns.

Richard asked if permit fees cover all FS trail costs. Ralph replied no, permit fees would need increased to do so.

Senate Bill 31 – licensing of out-of-state OHVs, Randy passed out the proposed amendment, non-SD resident permits to increase to \$50, if permit application is processed by county treasurer and reviewed by the dept, then half would go to state motor vehicle fund, and half to county general fund

BHRMUC impact – Randy stated that a Facebook page can be just as or more effective than a website. Patty thinks we need both. Matt discussed a company in Rapid City – \$2,400 start-up cost and \$150 annual maintenance fee...consultation included, we would be able to manage/

admin the site. The group decided that Eric and Matt would gather more information (more options) for the next meeting.

RR – Randy and Eric supported the idea to schedule membership presentations for our monthly meetings when we're without a designated speaker/guest. Pam Thompson advocated for more BHRMUC coloring books (visitors center and museum in Sundance would like 6 more boxes).

Mtg adjourned 6:10 pm

Minutes by Matt Lottes