

This map does not represent a legal survey of the land. Location of property boundaries and existing thoroughfares are approximated. Fall River County takes no responsibilities for any inaccuracies.

**Fall River County
Tax Deed Sale
June 2026**



130

Feet

Parcel Number: 72100-00800-003-00

Area: EDGEMONT

Legal Description: BIRDSELL ADDN: LOT 3, BLK 8

Address: 4TH AVE

Parcel Summary **Fall River County** **PDF 149 WORKING**

PN	72100-00800-003-00	Section	Deeded Acres	0.000
Deed	FALL RIVER COUNTY	Township	Lot	3
Contract		Range	Block	8
Address	204 4TH AVE, EDMONT	Loc. / Class	Urban / Exempt	
Map Area	Edgemont-Main	Abs Class	D	
Route Number	6ED-015-20Y	Plat Map		
Legal	BIRDSELL ADDN: LOT 3, BLK 8			



Land Basis	Front	Rear	Side 1	Side 2	R. Lot	SF	Acres
SqFt Dim	50.00	50.00	140.00	140.00			
Grand Total						7,000.00	0.161

Ph 1 of 2 07/29/2025

Residential Dwelling

Occupancy	Single-Family	
Style/YrBlt	2 Story Frame	1920
TLA/GLA	1,755 / 1,271 / 484	Ttl Rms
Bsmt/Attic	None / None	
Heat/AC	FHA - Gas / No AC	
Bsmt Finish	0 / 0 / 0	Fireplaces
Ttl Bdrms		
Condition	Above Normal	

Plumbing	Garage
Standard Bath - 3 Fixt 1	Carpport Prefab I 180 SF

South Dakota Full & True Values	
Ag	\$0
NA	\$110,220
OO	\$0
Exempt	\$0
Total	\$110,220

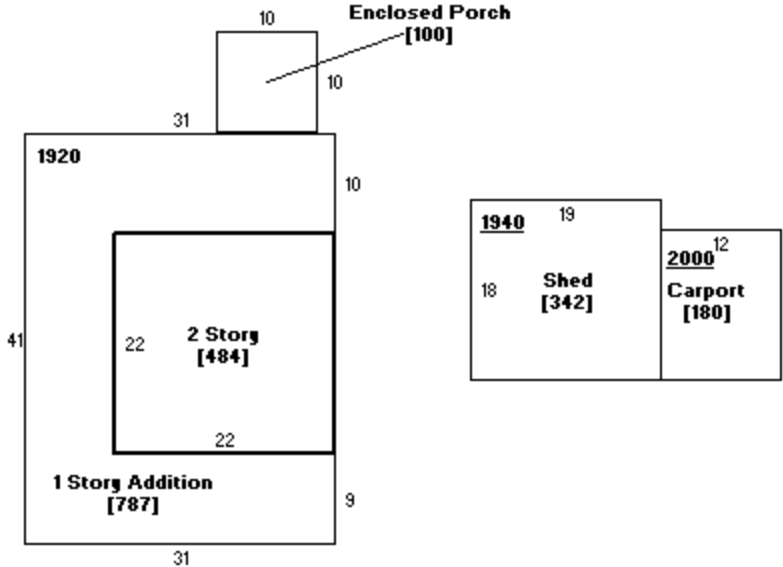

72100-00800-003-00

