

This map does not represent a legal survey of the land. Location of property boundaries and existing thoroughfares are approximated. Fall River County takes no responsibilities for any inaccuracies.

**Fall River County
Tax Deed Sale
June 2026**



130

Feet

Parcel Number: 78100-04500-011-00
Area: OELRICHS

Legal Description: OELRICHS, TOWN OF: N1/2 LOT 11, ALL LOT 12, BLK 45

Address: MAIN ST

PN	78100-04500-011-00	Section	Deeded Acres	0.000
Deed	FALL RIVER COUNTY	Township	Lot	11
Contract		Range	Block	45
Address	802 MAIN ST, OELRICHS	Loc. / Class	Urban / Exempt	
Map Area	Oelrichs - City	Abs Class	D	
Route Number	50E-025-60Z	Plat Map		
Legal	OELRICHS, TOWN OF: N1/2 LOT 11, ALL LOT 12, BLK 45			



Land Basis	Front	Rear	Side 1	Side 2	R. Lot	SF	Acres
SqFt Dim	25.00	25.00	140.00	140.00			
Unit Site						7,000.00	0.161
1.00 Unit							
Grand Total						10,500.00	0.241

Residential Dwelling

Occupancy	Single-Family	
Style/YrBlt	1 Story Frame	1952
TLA/GLA	1,316 / 1,316	Ttl Rms
Bsmt/Attic	Full / None	
Heat/AC	Yes / No AC	
Bsmt Finish	567/ 0/ 0	Fireplaces
Ttl Bdrms		
Condition	Fair	

Plumbing	Garage
Standard Bath - 3 Fixt 1	Det Frame 336 SF
	Carport Det 280 SF
	Carport Det 312 SF

South Dakota Full & True Values	
Ag	\$0
NA	\$75,880
OO	\$0
Exempt	\$0
Total	\$75,880

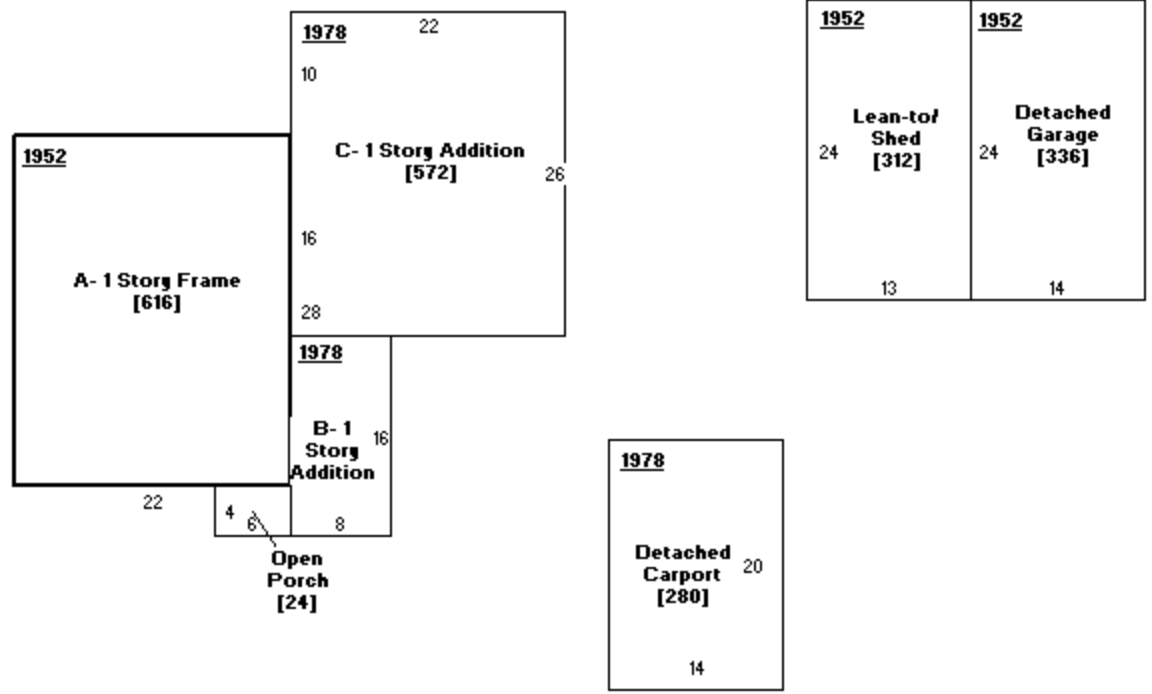

78100-04500-011-00





